

# MIGHTY HOOK

**Your Complete Source** for **Engineered Hanging & Masking Solutions**

## Hooks



## Masking



## Racks/Crossbars



## Accessories



## Custom Solutions



## Angle Pivot System

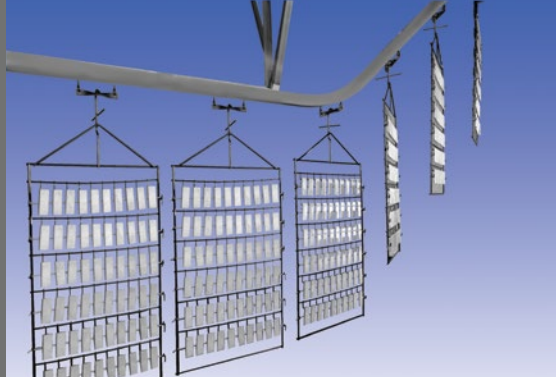

**Product  
Guide**

Issue No. 8

## Table of Contents

### Hooks

Mighty Hooks (V, C, CV, S, 90°, Link) . . . . . 2  
 Diamond Wire® Hooks & Universal Hooks . . . . . 7  
 Heavy Duty Hooks . . . . . 8  
 Jam Hooks & Spring Hooks . . . . . 9  
 Panel Hangers & Claw Hooks . . . . . 10  
 Tag Springs & Magnet System . . . . . 11  
 Snap Hooks . . . . . 12  
 Rotating Hooks . . . . . 15

### Racks

PowderPeg® Racks & Peg Hooks . . . . . 17  
 Slip Racks & Socket System Racks . . . . . 20  
 Custom Welded Racks . . . . . 21  
 Mighty Mono Racks . . . . . 22  
 Z-Base Batch Racks . . . . . 23  
 Mighty Multi Racks & Custom Load Bars . . . . . 24

### Material Handling

Carts . . . . . 25

### Crossbars & Matching Hooks

Z-Bar® Light . . . . . 26  
 Z-Bar® Heavy . . . . . 29

TSR Bar . . . . . 31  
 X-Bar & PP-X-Bar . . . . . 33  
 W-Bar . . . . . 35  
 Arrow Bar . . . . . 36  
 Tube & Rod . . . . . 37  
 Angle Pivot Conveyor Accessories . . . . . 38  
 Custom Hooks, Racking & Masking . . . . . 39  
 Custom Rack Design & Testing . . . . . 41

### Masking

Magnetic Discs . . . . . 43  
 Caps . . . . . 44  
 Plugs . . . . . 47  
 Q-Bolts . . . . . 54  
 Silicone Tubing . . . . . 55  
 Tape . . . . . 56  
 Discs . . . . . 59  
 Roland Plotter/Cutter . . . . . 62  
 Tape & Disc Dispensers . . . . . 63

### Accessories

Thickness & Grounding Testers . . . . . 63  
 Protective Packaging . . . . . 64  
 Sample Kits . . . . . 65

For complete pricing, terms, conditions and ordering information please visit [www.mightyhook.com](http://www.mightyhook.com)

e-mail to: [sales@mightyhook.com](mailto:sales@mightyhook.com)



At Mighty Hook we maintain an inventory of over 15 million stock hooks, racks, crossbars and masking items. If you have a specific requirement we can assist you in designing a custom hanging solution. Contact our friendly and knowledgeable staff for product information and quick delivery.



Our state-of-the-art, high speed CNC wire form machines mean consistent quality, low cost manufacturing and quick delivery of stock or custom wire hooks. Once your custom hook design is in our computer system we can recall and produce them for quick delivery. Contact us for details.

© 2021 Mighty Hook, Inc. All rights reserved.

## Mighty Hooks

Manufactured from Hard Drawn Spring Steel, our hooks survive repeated stripping and offer higher loading capabilities than mild steel hooks. We have a group of state-of-the-art high speed CNC wire formers capable of producing custom hooks and wire forms. We offer some of the best prices anywhere for custom wire forms. We stock material in several grades of steel and stainless steel wire. Steel hooks using 0.250 diameter stock and larger are made of Cold Rolled Steel, hooks using smaller diameter stock are made of Spring Steel. Contact one of our hook experts for assistance.



## Mandrel Packaging

Mandrel Packaging - Our exclusive Mandrel Package System eliminates the tangling of hooks and boosts productivity. Standard hooks no longer need to arrive loose and tangled in the carton. The time saved untangling hooks makes your finishing line more efficient and cost effective. Mandrel Packaging is standard on many of our hooks, and is included at no additional charge.

An \* after the hook part number indicates that the hooks are boxed in our Mandrel Packaging System..



## Custom Products and Availability

### Another advantage from the leader in hanging technology

If there is any hanging and masking product you need and don't see it in our product guide, call us with your requirements. Our extensive manufacturing capability coupled with an experienced staff of engineers enables us to design and produce what you need for your specific application on a made to order basis. See pages 39 - 42.

Want to be certain that the parts you want are always available when you need them? Place a blanket order with us and we will produce and ship those parts to your schedule. Contact us for details.



Made in USA

## VV-Style Mighty Hooks

An industrial hook with a “V” Bottom will retain its grounding ability longer by allowing parts to seat in the same location. This minimizes coating buildup in that location. Hooks with a wire diameter of .180 or less are made from hard drawn spring wire that can handle higher loads and can better withstand repeated stripping cycles than cold rolled steel. Mandrel packaging is standard on many of our hooks.

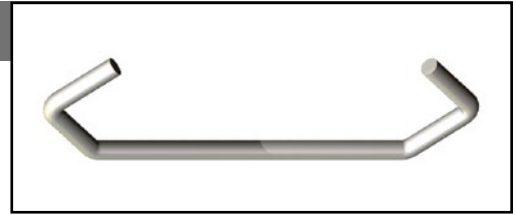

Part Number	Description	Qty. Per Box	Part Number	Description	Qty. Per Box
V-25-4*	2.5" Long .044 Wire VV-Style	3000 pcs	V-1225	12" Long .250 Wire VV-Style	500 pcs
V-25-6*	2.5" Long .062 Wire VV-Style	3000 pcs	V-1412	14" Long .120 Wire VV-Style	500 pcs
V-404*	4" Long .044 Wire VV-Style	5000 pcs	V-1418	14" Long .180 Wire VV-Style	500 pcs
V-406*	4" Long .062 Wire VV-Style	3000 pcs	V-1507	15" Long .076 Wire VV-Style	500 pcs
V-407*	4" Long .076 Wire VV-Style	3500 pcs	V-1512	15" Long .120 Wire VV-Style	500 pcs
V-412*	4" Long .120 Wire VV-Style	2000 pcs	V-1518	15" Long .180 Wire VV-Style	500 pcs
V-418	4" Long 180 Wire VV-Style	500 pcs	V-1807	18" Long .076 Wire VV-Style	500 pcs
V-606*	6" Long .062 Wire VV-Style	2000 pcs	V-1812	18" Long .120 Wire VV-Style	500 pcs
V-607*	6" Long .076 Wire VV-Style	2000 pcs	V-1818	18" Long .180 Wire VV-Style	500 pcs
V-612	6" Long .120 Wire VV-Style	1000 pcs	V-2112	21" Long .120 Wire VV-Style	500 pcs
V-618	6" Long 180 Wire VV-Style	500 pcs	V-2118	21" Long .180 Wire VV-Style	500 pcs
V-706*	7" Long .062 Wire VV-Style	2000 pcs	V-2207	22" Long .076 Wire VV-Style	500 pcs
V-707*	7" Long .076 Wire VV-Style	2000 pcs	V-2407	24" Long .076 Wire VV-Style	500 pcs
V-712	7" Long .120 Wire VV-Style	1500 pcs	V-2412	24" Long .120 Wire VV-Style	500 pcs
V-718	7" Long 180 Wire VV-Style	500 pcs	V-2418	24" Long .180 Wire VV-Style	500 pcs
V-807	8" Long .076 Wire VV-Style	2000 pcs	V-2425	24" Long .250 Wire VV-Style	500 pcs
V-812	8" Long .120 Wire VV-Style	1000 pcs	V-2807	28" Long .076 Wire VV-Style	500 pcs
V-818	8" Long .180 Wire VV-Style	500 pcs	V-2812	28" Long .120 Wire VV-Style	500 pcs
V-9512	9.5" Long .120 Wire VV-Style	1000 pcs	V-2818	28" Long .180 Wire VV-Style	500 pcs
V-1007	10" Long .076 Wire VV-Style	1000 pcs	V-3012	30" Long .120 Wire VV-Style	500 pcs
V-1012	10" Long .120 Wire VV-Style	1000 pcs	V-3018	30" Long .180 Wire VV-Style	500 pcs
V-1018	10" Long .180 Wire VV-Style	500 pcs	V-3212	32" Long .120 Wire VV-Style	500 pcs
V-1207	12" Long .076 Wire VV-Style	1000 pcs	V-3218	32" Long .180 Wire VV-Style	500 pcs
V-1212	12" Long .120 Wire VV-Style	500 pcs	V-3612	36" Long .120 Wire VV-Style	500 pcs
V-1218	12" Long .180 Wire VV-Style	500 pcs	V-3618	36" Long .180 Wire VV-Style	500 pcs

An \* after the part number indicates that it is shipped in our Mandrel Packaging System.

## CC-Style Mighty Hooks

These hooks are ideal for wider parts or multiple styles of parts with varying thicknesses. For maximum loading and repeated usage, ensure the product being hung seats into the bottom of the "C".

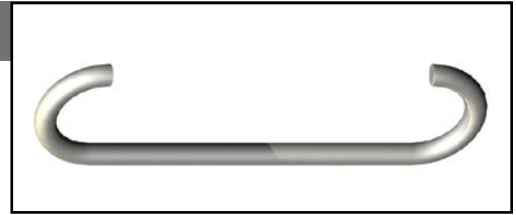

Part Number	Description	Qty. Per Box	Part Number	Description	Qty. Per Box
C-3044*	3" Long .044 Wire CC-Style	3000 pcs	C-8091	8" Long .091 Wire CC-Style	1500 pcs
C-3062*	3" Long .062 Wire CC-Style	3000 pcs	C-8105	8" Long .105 Wire CC-Style	500 pcs
C-3076*	3" Long .076 Wire CC-Style	2000 pcs	C-812	8" Long .120 Wire CC-Style	500 pcs
C-4044*	4" Long .044 Wire CC-Style	3000 pcs	C-818	8" Long .180 Wire CC-Style	500 pcs
C-4062*	4" Long .062 Wire CC-Style	2000 pcs	C-1007	10" Long .076 Wire CC-Style	500 pcs
C-4076*	4" Long .076 Wire CC-Style	2000 pcs	C-1012	10" Long .120 Wire CC-Style	1000 pcs
C-4091*	4" Long .091 Wire CC-Style	2000 pcs	C-1018	10" Long .180 Wire CC-Style	500 pcs
C-606*	6" Long .062 Wire CC-Style	2000 pcs	C-1212	12" Long .120 Wire CC-Style	500 pcs
C-607*	6" Long .076 Wire CC-Style	2000 pcs	C-1218	12" Long .180 Wire CC-Style	500 pcs
C-612	6" Long .120 Wire CC-Style	1500 pcs	C-1812	18" Long .120 Wire CC-Style	500 pcs
C-8062	8" Long .062 Wire CC-Style	1500 pcs	C-1818	18" Long .180 Wire CC-Style	500 pcs
C-807	8" Long .076 Wire CC-Style	1500 pcs			

An \* after the part number indicates that it is shipped in our Mandrel Packaging System.

## CV-Style Mighty Hooks

These hooks are a crossbreed of the V-style and C-style Mighty Hooks and allow maximum hanging potential with the smallest possible hook marks for various sizes of parts. For maximum loading and repeated usage, ensure the product being hung seats into the bottom of the "C" or "V".



Part Number	Description	Qty. Per Box	Part Number	Description	Qty. Per Box
418-CV	4" Long .180 Wire CV-Style	500 pcs	1812-CV	18" Long .120 Wire CV-Style	500 pcs
707-CV	7" Long .076 Wire CV-Style	2000 pcs	1818-CV	18" Long .180 Wire CV-Style	500 pcs
712-CV	7" Long .120 Wire CV-Style	1000 pcs	2118-CV	21" Long .180 Wire CV-Style	500 pcs
718-CV	7" Long .180 Wire CV-Style	500 pcs	2412-CV	24" Long .120 Wire CV-Style	500 pcs
907-CV	9" Long .076 Wire CV-Style	1000 pcs	2418-CV	24" Long .180 Wire CV-Style	500 pcs
1018-CV	10" Long .180 Wire CV-Style	500 pcs	2425-CV	24" Long .250 Wire CV-Style	500 pcs
1212-CV	12" Long .120 Wire CV-Style	500 pcs	2818-CV	28" Long .180 Wire CV-Style	500 pcs
1218-CV	12" Long .180 Wire CV-Style	500 pcs	3012-CV	30" Long .120 Wire CV-Style	500 pcs
1512-CV	15" Long .120 Wire CV-Style	500 pcs	3018-CV	30" Long .180 Wire CV-Style	500 pcs
1518-CV	15" Long .180 Wire CV-Style	500 pcs	3218-CV	32" Long .180 Wire CV-Style	500 pcs
1807-CV	18" Long .076 Wire CV-Style	500 pcs	3612-CV	36" Long .120 Wire CV-Style	500 pcs

Need a hook you don't see listed? - We can make them to order!

## S-Style Hooks

These hooks are ideal for wider parts or multiple styles of parts with varying thicknesses. S-style is easy to load onto coating lines with H-attachments or Pendants on the conveyor. For maximum loading and repeated usage, ensure the product being hung seats into the bottom of the "C".



Part Number	Description	Qty. Per Box	Part Number	Description	Qty. Per Box
S-3044	3" Long .044 Wire S-Style	3000 pcs	S-812	8" Long .120 Wire S-Style	1000 pcs
S-3062	3" Long .062 Wire S-Style	3000 pcs	S-818	8" Long .180 Wire S-Style	500 pcs
S-3076	3" Long .076 Wire S-Style	2000 pcs	S-10076	10" Long .076 Wire S-Style	1000 pcs
S-3091	3" Long .091 Wire S-Style	2000 pcs	S-1012	10" Long .120 Wire S-Style	1000 pcs
S-4044	4" Long .044 Wire S-Style	2000 pcs	S-1018	10" Long .180 Wire S-Style	500 pcs
S-4062	4" Long .062 Wire S-Style	2000 pcs	S-1025	10" Long .250 Wire S-Style	500 pcs
S-4076	4" Long .076 Wire S-Style	1500 pcs	S-1207	12" Long .076 Wire S-Style	500 pcs
S-4091	4" Long .091 Wire S-Style	1500 pcs	S-1212	12" Long .120 Wire S-Style	500 pcs
S-412	4" Long .120 Wire S-Style	1500 pcs	S-1218	12" Long .180 Wire S-Style	500 pcs
S-6062	6" Long .062 Wire S-Style	2000 pcs	S-1225	12" Long .250 Wire S-Style	500 pcs
S-6076	6" Long .076 Wire S-Style	1500 pcs	S-1518	15" Long .180 Wire S-Style	500 pcs
S-6091	6" Long .091 Wire S-Style	1000 pcs	S-1812	18" Long .120 Wire S-Style	500 pcs
S-0612	6" Long .120 Wire S-Style	1000 pcs	S-1818	18" Long .180 Wire S-Style	500 pcs
S-6148	6" Long .148 Wire S-Style	1000 pcs	S-1825	18" Long .250 Wire S-Style	500 pcs
S-8076	8" Long .076 Wire S-Style	1000 pcs	S-2112	21" Long .120 Wire S-Style	500 pcs
S-8105	8" Long .105 Wire S-Style	1000 pcs	S-2118	21" Long .180 Wire S-Style	500 pcs

## 90° Basic Style VV, CC and CV styles

For maximum loading and repeated usage, ensure the product being hung seats into the bottom of the "C" or "V".

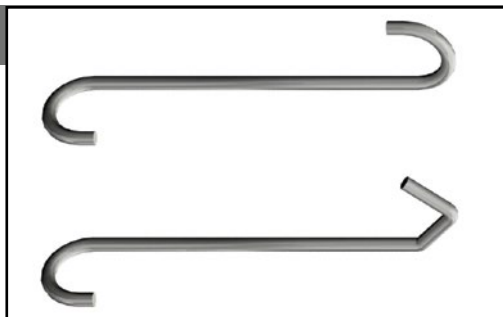

Part Number	Description	Qty. Per Box	Part Number	Description	Qty. Per Box
25-6-VV-90	2.5" Long .062 Wire VV-Style 90°	3000 pcs	1812-VV-90	18" Long .120 Wire VV-Style 90°	500 pcs
407-VV-90	4" Long .076 Wire VV-Style 90°	1500 pcs	1818-VV-90	18" Long .180 Wire VV-Style 90°	500 pcs
412-VV-90	4" Long .120 Wire VV-Style 90°	1500 pcs	2118-VV-90	21" Long .180 Wire VV-Style 90°	500 pcs
707-VV-90	7" Long .076 Wire VV-Style 90°	1500 pcs	2407-VV-90	24" Long .076 Wire VV-Style 90°	500 pcs
712-VV-90	7" Long .120 Wire VV-Style 90°	1500 pcs	2412-VV-90	24" Long .120 Wire VV-Style 90°	500 pcs
718-VV-90	7" Long .180 Wire VV-Style 90°	1000 pcs	2418-VV-90	24" Long .180 Wire VV-Style 90°	500 pcs
1012-VV-90	10" Long .120 Wire VV-Style 90°	500 pcs	2425-VV-90	24" Long .250 Wire VV-Style 90°	500 pcs
1018-VV-90	10" Long .180 Wire VV-Style 90°	500 pcs	1018-CV-90	10" Long .180 Wire CV-Style 90°	500 pcs
1207-VV-90	12" Long .076 Wire VV-Style 90°	500 pcs	2418-CV-90	24" Long .180 Wire CV-Style 90°	500 pcs
1212-VV-90	12" Long .120 Wire VV-Style 90°	500 pcs	3018-CV-90	30" Long .180 Wire CV-Style 90°	500 pcs
1218-VV-90	12" Long .180 Wire VV-Style 90°	500 pcs	3218-CV-90	32" Long .180 Wire CV-Style 90°	500 pcs
1518-VV-90	15" Long .180 Wire VV-Style 90°	500 pcs			

Need a hook you don't see listed? - We can make them to order!

## Super S-Style Hooks

These hooks are an improved version of our standard hooks. Parts hang straighter and steadier.

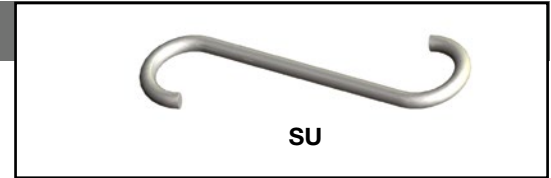

Part Number	Description	Qty. Per Box	Part Number	Description	Qty. Per Box
SU-3091	SU-Style 3" Long .091 Wire	2000 pcs	SU-812	SU-Style 8" Long .120 Wire	1000 pcs
SU-4076	SU-Style 4" Long .076 Wire	1500 pcs	SU-1076	SU-Style 10" Long .076 Wire	1000 pcs
SU-512	SU-Style 5" Long .120 Wire	1500 pcs	SU-1012	SU-Style 10" Long .120 Wire	1000 pcs
SU-6076	SU-Style 6" Long .076 Wire	1500 pcs	SU-1212	SU-Style 12" Long .120 Wire	500 pcs
SU-612	SU-Style 6" Long .120 Wire	1500 pcs	SU-1218	SU-Style 12" Long .180 Wire	500 pcs
SU-8076	SU-Style 8" Long .076 Wire	1000 pcs			

## Large S-Style Hooks

Large-S is made of durable music wire. This hook can hold large parts for a small price. Designed to hold up to 50lbs. For heavier parts, contact a Mighty Hook engineer.

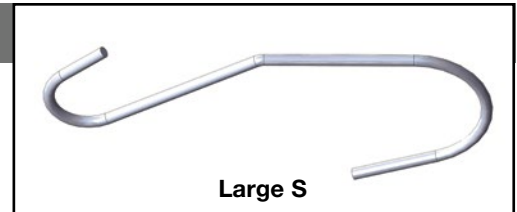

Part Number	Description	Qty. Per Box
LARGE-S	7.5" Lg x 2.5"ID x 1"ID .180 Music Wire	200 pcs

## Super V-Style Hooks

These hooks are an improved version of our standard hooks. Parts hang straighter and steadier.

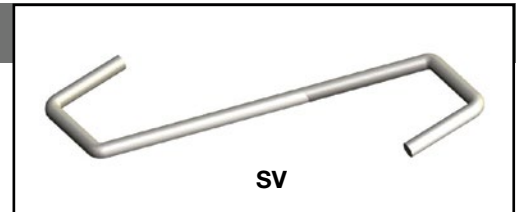

Part Number	Description	Qty. Per Box	Part Number	Description	Qty. Per Box
SV-4076	SV-Style 4" Long .076 Wire	1500 pcs	SV-812	SV-Style 8" Long .120 Wire	1000 pcs
SV-512	SV-Style 5" Long .120 Wire	1500 pcs	SV-1076	SV-Style 10" Long .076 Wire	1000 pcs
SV-518	SV-Style 5" Long .180 Wire	500 pcs	SV-1012	SV-Style 10" Long .120 Wire	1000 pcs
SV-6076	SV-Style 6" Long .076 Wire	1500 pcs	SV-1212	SV-Style 12" Long .120 Wire	500 pcs
SV-612	SV-Style 6" Long .120 Wire	1500 pcs	SV-1218	SV-Style 12" Long .180 Wire	500 pcs
SV-8076	SV-Style 8" Long .076 Wire	1000 pcs			

## Heavy Duty Link Hooks

Hooks are stocked in 8" Long x 0.375" diameter mild steel and are designed to carry loads up to 350 lbs. Hooks are manufactured with 90° orientation, have offset "C" style bends and can be linked together to achieve required lengths.

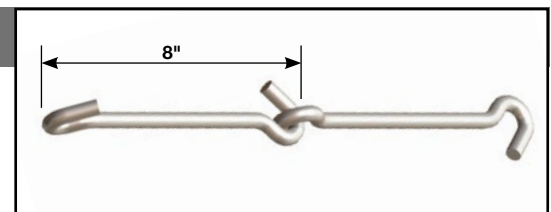

Custom lengths and configuration in wire diameters up to 0.5" are available. Please call one of our engineers to discuss your custom options. You may also fax or email us a drawing for prompt quotation.

Part Number	Description	Qty. Per Box
LINKHK8375-90	8" L x 0.375" dia. wire 90° offset hooks	50

**Need a hook you don't see listed? - We can make them to order!**

## Diamond Wire® Hooks

### The Diamond Wire Edge: Stronger hooks offering superior ground

DIAMOND WIRE HOOKS - Really are stronger. Tests conducted on a load testing machine proved DIAMOND WIRE hooks have almost double the load capacity of our standard spring steel "V" or "C" style hooks. Spring-steel square wire is formed on edge to create a hook with improved contact in electrostatic coating systems and to minimize hanging marks on the coated product.

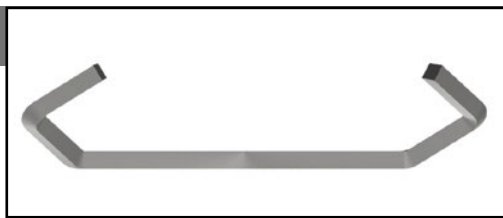

Approximate dimensions with hooks being bent on edge:

Square Wire	Width Across Diagonal Points	Square Wire	Width Across Diagonal Points
.062"	= .088"	.180"	= .255"
.105"	= .148"	.250"	= .354"
.120"	= .170"		

**Tips:** If your line requires superior grounding, you'll want to try our DIAMOND WIRE hooks. Let us know if you don't see the hook you need, we have state-of-the-art high speed CNC wire formers capable of producing custom hooks and wire forms upon request. Once your hook design is set up in the computer, we can recall and reproduce it on demand. Contact one of our hook experts for assistance.

Part Number	Description	Qty. Per Box	Part Number	Description	Qty. Per Box
D4062-WV	4" Lg. .062 Sq. Wire W-Style Bent on Points	2000 pcs	D1218-WV	12" Lg. .180 Sq. Wire W-Style Bent on Points	500 pcs
D4105-WV	4" Lg. .105 Sq. Wire W-Style Bent on Points	2000 pcs	D1518-WV	15" Lg. .180 Sq. Wire W-Style Bent on Points	500 pcs
D7062-WV	7" Lg. .062 Sq. Wire W-Style Bent on Points	2000 pcs	D1812-WV	18" Lg. .120 Sq. Wire W-Style Bent on Points	500 pcs
D7105-WV	7" Lg. .105 Sq. Wire W-Style Bent on Points	1500 pcs	D1818-WV	18" Lg. .180 Sq. Wire W-Style Bent on Points	500 pcs
D912-WV	9" Lg. .120 Sq. Wire W-Style Bent on Points	1000 pcs	D2412-WV	24" Lg. .120 Sq. Wire W-Style Bent on Points	500 pcs
D918-WV	9" Lg. .180 Sq. Wire W-Style Bent on Points	1000 pcs	D2418-WV	24" Lg. .180 Sq. Wire W-Style Bent on Points	500 pcs
D1212-WV	12" Lg. .120 Sq. Wire W-Style Bent on Points	500 pcs			

## Universal Crossbar Hooks

We offer the lowest prices in the industry for replacement hooks for round dimple crossbars with 1" centers.

Our hooks are manufactured from Hard Drawn Spring Steel and will survive repeated stripping and coating cycles. Stock sizes are 2", 2.5", 3" and 4" in 0.044", 0.062" and 0.076" wire diameters. Hooks can be ordered in our standard form (when hook is attached to bar, hook will be facing forward-perpendicular) or hooks can be ordered in our 90° form (when hook is attached to bar, hook will be facing parallel to the right, as shown).

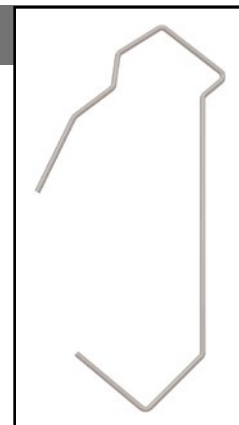

**Need a hook you don't see listed? - We can make them to order!**

**ALL Universal Hooks require a Minimum Order Quantity of 5 Boxes**

Part Number	Description	Qty. Per Box	Part Number	Description	Qty. Per Box
UH-0204	2" x 0.044 Universal CB Hook	2000 pcs	UH-02.506-90	2.5" x 0.062 90° Universal CB Hook	2000 pcs
UH-0204-90	2" x 0.044 90° Universal CB Hook	2000 pcs	UH-0306	3" x 0.062 Universal CB Hook	2000 pcs
UH-02.504	2.5" x 0.044 Universal CB Hook	2000 pcs	UH-0306-90	3" x 0.062 90° Universal CB Hook	2000 pcs
UH-02.504-90	2.5" x 0.044 90° Universal CB Hook	2000 pcs	UH-0406	4" x 0.062 Universal CB Hook	2000 pcs
UH-0304	3" x 0.044 Universal CB Hook	2000 pcs	UH-0406-90	4" x 0.062 90° Universal CB Hook	2000 pcs
UH-0304-90	3" x 0.044 90° Universal CB Hook	2000 pcs	UH-02.507	2.5" x 0.076 Universal CB Hook	2000 pcs
UH-0404	4" x 0.044 Universal CB Hook	2000 pcs	UH-02.507-90	2.5" x 0.076 90° Universal CB Hook	2000 pcs
UH-0404-90	4" x 0.044 90° Universal CB Hook	2000 pcs	UH-0307	3" x 0.076 Universal CB Hook	2000 pcs
UH-0206	2" x 0.062 Universal CB Hook	2000 pcs	UH-0307-90	3" x 0.076 90° Universal CB Hook	2000 pcs
UH-0206-90	2" x 0.062 90° Universal CB Hook	2000 pcs	UH-0407	4" x 0.076 Universal CB Hook	2000 pcs
UH-02.506	2.5" x 0.062 Universal CB Hook	2000 pcs	UH-0407-90	4" x 0.076 90° Universal CB Hook	2000 pcs

## Heavy-Duty Mighty Hooks

MIGHTY is the operative word for these HEAVY-hooks are made to order in S, C or V style and orientation. Lengths shown are standard, but these any length, style or orientation from material ranging 1.00" diameter CRS steel or stainless steel. Standard in descriptions below as the bend diameter or "bowl" only), but can be made to your specifications. Stock round steel, but hooks can be made in stainless hexagon material to meet your specific requirements.

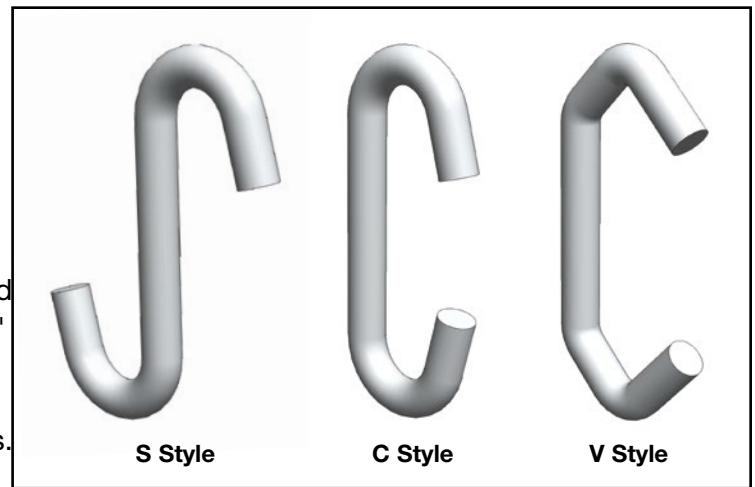

S-Hook Part No.	C-Hook Part No.	V-Hook Part No.	Description	Qty. Per Box
S-10312	C-10312	V-10312	10" L x 0.312" Dia. Hook - 2.5" Bowl	100 pcs.
S-10375	C-10375	V-10375	10" L x 0.375" Dia. Hook - 2.5" Bowl	50 pcs.
S-10500	C-10500	V-10500	10" L x 0.500" Dia. Hook - 2.5" Bowl	25 pcs.
S-12312	C-12312	V-12312	12" L x 0.312" Dia. Hook - 2.5" Bowl	100 pcs.
S-12375	C-12375	V-12375	12" L x 0.375" Dia. Hook - 2.5" Bowl	50 pcs.
S-12500	C-12500	V-12500	12" L x 0.500" Dia. Hook - 2.5" Bowl	25 pcs.
S-12625	C-12625	V-12625	12" L x 0.625" Dia. Hook - 3" Bowl	25 pcs.
S-18312	C-18312	V-18312	18" L x 0.312" Dia. Hook - 2.5" Bowl	50 pcs.
S-18375	C-18375	V-18375	18" L x 0.375" Dia. Hook - 2.5" Bowl	50 pcs.
S-18500	C-18500	V-18500	18" L x 0.500" Dia. Hook - 2.5" Bowl	25 pcs.
S-18625	C-18625	V-18625	18" L x 0.625" Dia. Hook - 3" Bowl	20 pcs.
S-18750	C-18750	V-18750	18" L x 0.750" Dia. Hook - 3" Bowl	10 pcs.
S-24312	C-24312	V-24312	24" L x 0.312" Dia. Hook - 2.5" Bowl	50 pcs.
S-24375	C-24375	V-24375	24" L x 0.375" Dia. Hook - 2.5" Bowl	50 pcs.
S-24500	C-24500	V-24500	24" L x 0.500" Dia. Hook - 2.5" Bowl	25 pcs.
S-24625	C-24625	V-24625	24" L x 0.625" Dia. Hook - 3" Bowl	10 pcs.
S-24750	C-24750	V-24750	24" L x 0.750" Dia. Hook - 3" Bowl	10 pcs.
S-32312	C-32312	V-32312	32" L x 0.312" Dia. Hook - 2.5" Bowl	50 pcs.
S-32375	C-32375	V-32375	32" L x 0.375" Dia. Hook - 2.5" Bowl	25 pcs.
S-32500	C-32500	V-32500	32" L x 0.500" Dia. Hook - 2.5" Bowl	20 pcs.
S-32625	C-32625	V-32625	32" L x 0.625" Dia. Hook - 3" Bowl	10 pcs.
S-32750	C-32750	V-32750	32" L x 0.750" Dia. Hook - 3" Bowl	10 pcs.

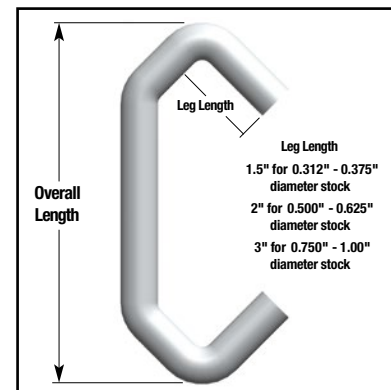
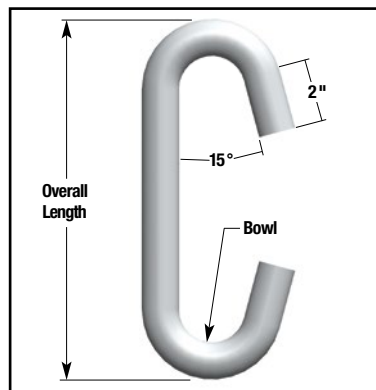
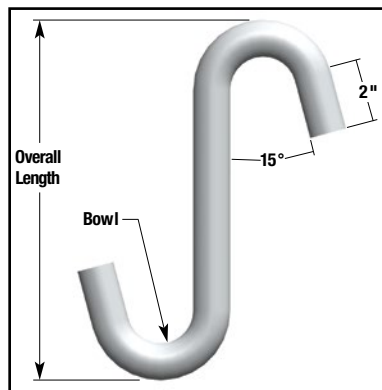

Need a hook you don't see listed? - We can make them to order!

## Jam Hooks

### The internal hooking solution

JM-1, JM-2, and JM-3 are made from stainless steel flat stock to maintain tension even after repeated stripping. Four sharp corners bite into the tube walls for greater holding power. Request a sample to try our superior design.

JM-4, JM-4A, JM-5, and JM-5A are made from 0.105" Hard Drawn Wire. Our JM-4MS is made from 0.105" dia. Stainless Steel. The design for JM-4 and JM-5 allows for easy loading and unloading without squeezing the hook. The extra bend on the JM-4A and JM-5A provides extra tension that allows their use in a variety of tubing sizes. Special jam hooks have been made in lengths up to 60". Custom hooks can be manufactured for heavier and larger tubing or for internal hanging of awkward and complex parts. Call our expert staff to discuss your application.

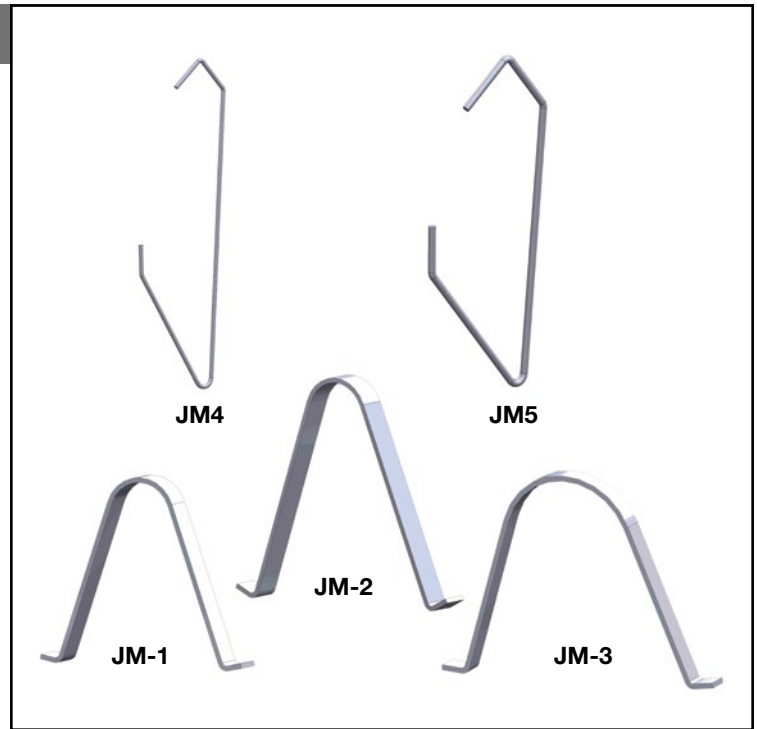

Part Number	Description	Qty. Per Box
JM-1	1 1/2" Long- fits tubing 1/2"to1"ID Flat Stock Stainless Steel	500 pcs
JM-2	1 3/4" Long- fits tubing 1/2"to1"ID Flat Stock Stainless Steel	500 pcs
JM-3	2" Long-fits tubing 1/2" to 1-1/4"ID Flat Stock Stainless Steel	500 pcs
JM-4	5" Long-fits tubing 1/2" to 1"ID .105 Wire HD	500 pcs
JM-5	8.5" Long-fits tubing 3/4" to 1-1/4"ID .105 Wire HD	500 pcs
JM-5A	8.5" Long-fits tubing 3/4" to 1-3/4"ID .105 Wire HD	500 pcs

## Spring Hooks

### Spring Hooks for internal hanging of products with holes

Spring Hooks are a great alternative to "Jam" style hooks as they provide good internal retention with multiple uses. The coiled spring design maintains tension longer and provides a secure method for hanging or suspending parts for coating. These hooks are ideal for hanging certain tube and channel applications or products with holes where internal hanging is preferred.

Made of 0.076" hard drawn spring tempered steel, hooks will maintain the spring quality through multiple stripping applications. Custom sizes are available and hooks can be made in stainless steel to add durability. For assistance in designing or selecting the proper type of hook for your application, contact one of our engineers or hanging specialists.



Part Number	Description	Qty. Per Box
SPHK-0308	3" Long - fits tubing 3/4" to 1-1/4" ID	500
SPHK-0508	5" Long - fits tubing 3/4" to 2-1/4" ID	500

## Panel Hangers and Claw-Hooks

For sheet metal products or large-diameter pipes that do not have holes for suspension. These hook types create a cantilever effect, which locks the product into place with minimal suspension marks.

### Panel Hangers

Standard panel hangers (PH) - 0.120" cold-rolled sheet metal, with three different suspension holes at various distances for a normal wire hook. Metal sheets with a thickness of up to 0.080" can be suspended at one end, while 0.157" sheets can be suspended at the other end. The total length of the panel hanger is 4".



They can also be manufactured in other lengths, depending on your hanging needs.

Panel Clamps (PC)-This spring stainless steel clamp can be attached to a product, then the product can be suspended from one of the holes in the clamp. Primarily intended for products that have no suitable holes for suspension.

PC1 is designed to hang materials ranging in thickness from approximately 25 gauge (0.019) to 14 gauge (0.079) and the PC2 is designed to hang materials ranging in thickness from 20 gauge (0.039) to 13 gauge (0.098).

Part Number	Description	Qty. Per Box
PH100	0.120" Sheet Hanger	50 pcs
PC1	Stainless Steel Clamp for 0.0196"-0.079"	50 pcs
PC2	Stainless Steel Clamp for 0.0394"-0.098"	50 pcs

### Claw-Hooks

#### Spring loaded clamping design for holding parts without holes

The spring loaded clamping design holds parts firmly with minimal hook marks. The ends are ground down to sharp points to aid in retention as well as minimizing contact areas. Designed to hold sheet steel, products without holes or other items where conventional hanging methods are unavailable. CLW-200 is suggested for products weighing less than 5 lbs. CLW-300 is suggested for products weighing less than 10 lbs. CLW-400 is suggested for products weighing less than 20 lbs.

Loading information is only an approximation. Because the loading characteristics of parts vary in geometry and surface considerations, we suggest testing the claw hooks in the actual conditions in which they will be used in production. Contact our experienced staff to discuss your application today.

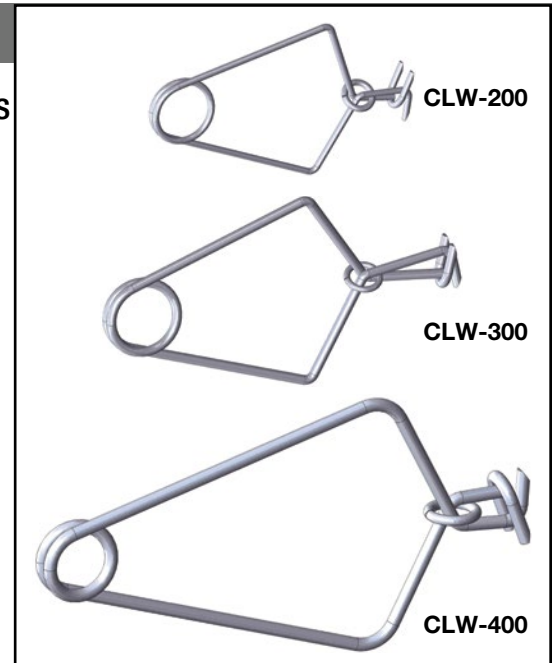

Part Number	Description	Qty. Per Box
CLW-200	3.4" L x 0.080 Dia. Spring Hook	50 pcs
CLW-300	4.75" L x 0.120 Dia. Spring Hook	50 pcs
CLW-400	6.5" L x 0.157 Dia. Spring Hook	50 pcs

**Need a hook you don't see listed? - We can make them to order!**

## Tag Springs for easy identification

MIGHTY HOOK Tag Springs are easy to use when attaching tags to identify any type of round or square tubing.

They are made of Hard Drawn Spring Steel to provide good internal retention. These tag springs are ideal for hanging identification tags on the ends of bundled stock, and will retain their spring quality through repeated uses.

We make them in three stock sizes, but custom sizes are available. Contact our sales staff with your unique requirements.

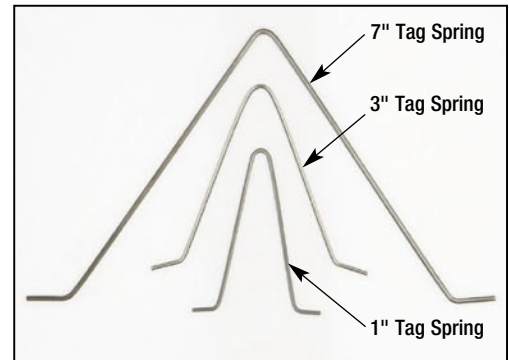

Part Number	Description	Box Qty.
1TAGSPRINGS	Tag Spring for 1" - 2" pipe, made from 0.080" HD wire	2000 pcs.
3TAGSPRINGS	Tag Spring for 2.5" - 4" pipe, made from 0.080" HD wire	2500 pcs.
7TAGSPRINGS	Tag Spring for 4" - 7.5" pipe, made from 0.105" HD wire	1000 pcs.



## Magnet System

High temperature magnets leave minimal suspension marks and eliminate gloss changes and cooling problems. Magnet System can be utilized in a variety of racking options.

The MH31 is an innovative 3 piece design. The MH31 magnetic leads are integrated in the steel housing. The magnet is placed in the cradle of the housing and the silicone boot is placed over the housing and magnet. The MH31 housing is designed to be welded as part of a rack component, or can be used as an insert option on our proprietary socket rack system located on page 20.

All ferrite magnets and components are designed to withstand temperatures up to 500°F.

Part Number	Description	Box Qty.
MH31	Magnet Assembly Type 3 with straight contact plates	25
MH-3	Stamped Housing for Type 3 Assembly	25
MHM21	Large magnet for Type 2 or Type 3 Assembly	25
MHA-3	Silicone cap for Type 3 Assembly	25

### ASSEMBLY



MH31

### REPLACEABLE PARTS

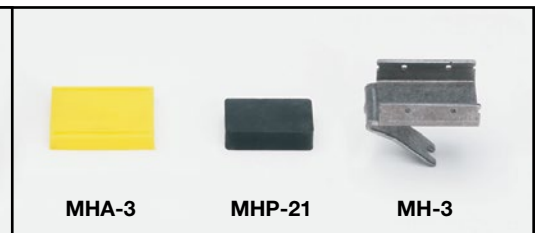

MHA-3

MHP-21

MH-3

# Snap Hooks

## A low-cost flexible and multiple positioning hanging solution

Hard drawn spring steel hooks designed to snap over tubing and rods to provide low-cost flexible and multiple positioning hanging solutions. Snap hooks are stocked in a variety of styles, lengths and wire sizes. See style graphics and hook configuration graphics for details. Various hooks are stocked for 3/8" diameter rod/tubing, 1/4" diameter rod/tubing and 3/16" rod.

**Tips:** We stock a large variety of hooks in spring steel and we also manufacture custom snap hooks to address your particular hanging requirements. Call one of our resident hanging experts to discuss your application and to get a quotation today.

### 3/8" Backward-style Snap Hooks

Manufactured with 180° Backwards snapping action for quick placement and minimal interference with hanging part. Hooks are manufactured from Spring Steel and snap over 3/8" Rod or Tube.

Special sizes and configurations are available by custom order.

+ Minimum Box Quantity per order required, check website for details.



Part Number	Description	Part Number	Description
SHB-01044SMC	1" Lg x .044 Wire Small C-Bottom for 3/8"Rod+	SHB-17544C	1.75" Lg x .044 Wire Large C-Bottom for 3/8"Rod
SHB-12544V	1.25" Lg x .044 Wire LV-Bottom for 3/8"Rod+	SHB-17562V	1.75" Lg x .062 Wire V-Bottom for 3/8"Rod
SHB-17544V	1.75" Lg x .044 Wire V-Bottom for 3/8"Rod+	SHB-17562VSMV	1.75" Lg x .062 Wire Small LV-Bottom for 3/8"Rod
SHB-17544VSMV	1.75" Lg x .044 Wire Small LV-Bottom for 3/8"Rod+	SHB-17562L	1.75" Lg x .062 Wire Large C-Bottom for 3/8"Rod

### 3/8" Front-style Snap Hooks

Manufactured with front snapping action for quick placement and good retention. Hooks are manufactured from Spring Steel and snap over 3/8" Tube.

Special sizes and configurations are available by custom order.

+ Minimum Box Quantity per order required, check website for details.



Part Number	Description	Part Number	Description
SHF-17544LV	1.75" Lg x .044 Wire LV-Bottom for 3/8"Rod	SHF-3062SMC	3" Lg x .062 Wire Small C-Bottom for 3/8"Rod+
SHF-17544V	1.75" Lg x .044 Wire V-Bottom for 3/8"Rod	SHF-3062V	3" Lg x .062 Wire V-Bottom for 3/8"Rod+
SHF-17544C	1.75" Lg x .044 Wire Large C-Bottom for 3/8"Rod	SHF-4044V	4" Long x .044 Wire V-Bottom for 3/8"Rod
SHF-2044SMC	2" Lg x .044 Wire Small C-Bottom for 3/8"Rod+	SHF-4062V	4" Long x .062 Wire V-Bottom for 3/8"Rod
SHF-2062C	2" Lg x .062 Wire Large C-Bottom for 3/8"Rod+	SHF-4076V	4" Long x .076 Wire V-Bottom for 3/8"Rod
SHF-2076V	2" Lg x .076 Wire V-Bottom for 3/8"Rod+	SHF-6044V	6" Long x .044 Wire V-Bottom for 3/8"Rod+
SHF-3044V	3" Lg x .044 Wire V-Bottom for 3/8"Rod+	SHF-6044C	6" Long x .044 Wire Large C-Bottom for 3/8"Rod+
SHF-3044SMC	3" Lg x .044 Wire Small C-Bottom for 3/8"Rod+	SHF-6062V	6" Long x .062 Wire V-Bottom for 3/8"Rod+
SHF-3044C	3" Lg x .044 Wire Large C-Bottom for 3/8"Rod+	SHF-6076V	6" Long x .076 Wire V-Bottom for 3/8"Rod+

**Need a hook you don't see listed? - We can make them to order!**

## 3/8" 90°-style Snap Hooks

Manufactured for parallel orientation with the crossbar. Hooks are made from Spring Steel and snap over 3/8" Rod or Tube. Special sizes and configurations are available by custom order.



+ Minimum Box Quantity per order required, check website for details.

Part Number	Description	Part Number	Description
SHR-17544V	1.75" Long x .044 Wire V-Bottom 90° for 3/8"Rod+	SHR-3062C	3" Long x .062 Wire LG C-Bottom 90° for 3/8"Rod+
SHR-17562V	1.75" Long x .062 Wire V-Bottom 90° for 3/8"Rod+	SHR-4062V	4" Long x .062 Wire V-Bottom 90° for 3/8"Rod+
SHR-2062C	2" Long x .062 Wire LG C-Bottom 90° for 3/8"Rod+	SHR-4062C	4" Long x .062 Wire LG C-Bottom 90° for 3/8"Rod+
SHR-3044C	3" Long x .044 Wire LG C-Bottom 90° for 3/8"Rod+	SHR-4076V	4" Long x .076 Wire V-Bottom 90° for 3/8"Rod
SHR-3044V	3" Long x .044 Wire V-Bottom 90° for 3/8"Rod+	SHR-6062LV	6" Long x .062 Wire LV-Bottom 90° for 3/8"Rod+
SHR-3062V	3" Long x .062 Wire V-Bottom 90° for 3/8"Rod+		

## 3/8" Unique Snap Hooks

We offer several unique styles of snap hooks to hold products on both sides of the crossbar or for improving retention of hanging products through the washing stage. Hooks are made from Spring Steel and snap over 3/8" Rod or Tube. Special sizes and configurations are available by custom order.

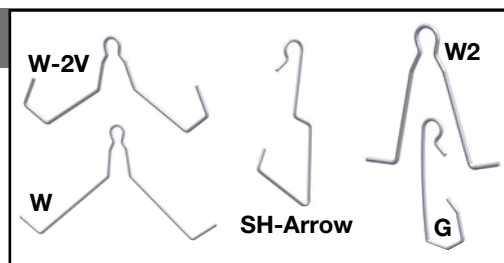

+ Minimum Box Quantity per order required, check website for details.

Part Number	Description	Part Number	Description
SH-Arrw/Jm	4" Long x .062 Wire Jam Type Bottom for 3/8"Rod+	W-03062	3" L x 6" Wide .062 Wire for 3/8"Rod+
G62	2.5" L x .062 Extra Bend on Bottom for 3/8"Rod	W-03076	3" L x 6" Wide .076 Wire for 3/8"Rod+
W2-225044	2.25" Long x .044 Wire 3"Wide for 3/8"Rod+	W-03062-2V	3" L x 6" Wide .062 Wire Extra Bnd on V for 3/8"Rod+
W2-225062	2.25" Long x .062 Wire 3"Wide for 3/8"Rod+	W-03076-2V	3" L x 6" Wide .076 Wire Extra Bnd on V for 3/8"Rod+

## 1/4" Back-style Snap Hooks

Manufactured with 180° Backwards snapping action for quick placement and minimal interference with hanging part. Hooks are made from Spring Steel and snap over 1/4" Rod or Tube.

For use with either 1/4" Wire Rod or our PEGROD (see page 37).

Special sizes and configurations are available by custom order.



+ Minimum Box Quantity per order required, check website for details.

Part Number	Description
SHB-17562C-2	1.75" Long x .062 Wire Large C-Bottom for 1/4" Rod+
SHB-17562V-2	1.75" Long x .062 Wire V-Bottom for 1/4" Rod

## 1/4" Front-style Snap Hooks

Manufactured with front snapping action for quick placement and good retention. Made from Spring Steel and snap over 1/4" Rod or Tube. For use with either 1/4" Wire Rod or our PEGROD (see page 37).

Special sizes and configurations are available by custom order.



Part Number	Description	Part Number	Description
SHF-2044V-2	2" Lg x .044 Wire V-Bottom for 1/4" Rod	SHF-2062V-2	2" Lg x .062 Wire V-Bottom for 1/4" Rod
SHF-17562C-2	1.75" Lg x .062 Wire Large C-Bottom for 1/4" Rod	SHF-4062V-2	4" Lg x .062 Wire V-Bottom for 1/4" Rod

## 1/4" 90°-style Snap Hooks

Manufactured for parallel orientation with the crossbar. Made from Spring Steel and snap over 1/4" Rod or Tube. For use with either 1/4" Wire Rod or our PEGROD (see page 37). Special sizes and configurations are available by custom order.



+ Minimum Box Quantity per order required, check website for details.

Part Number	Description
SHR-17544V-2	1.75" L x .044 Wire V-bottom 90° for 1/4" Rod+
SHR-2062V-2	2" L x .062 Wire V-Bottom 90° for 1/4" Rod+
SHR-2076C-2	2" L x .076wire LG C-Bottom 90° for 1/4" Rod+

## 1/4" Unique Snap Hooks

We offer several unique styles of snap hooks to hold products on both sides of the crossbar or for spring loading products without holes. Hooks are manufactured from Spring Steel and snap over 1/4" Rod or Tube. For use with either 1/4" Wire Rod or our PEGROD (see page 37). Special sizes and configurations are available by custom order.

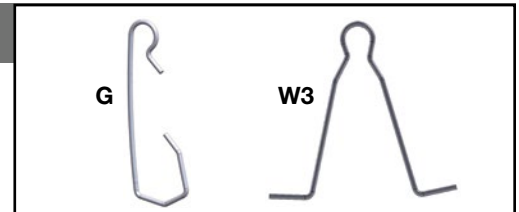

+ Minimum Box Quantity per order required, check website for details.

Part Number	Description
G44-2	2.5" L x .044 Extra Bend on Bottom for 1/4" Rod
G62-2	2.5" L x .062 Extra Bend on Bottom for 1/4" Rod
W3-Spec .044	2.25" L x .044 Wire for 1/4" Rod+

## 3/16" Back-style Snap Hooks

Manufactured with 180° Backwards snapping action for quick placement and minimal interference with hanging part. Hooks are manufactured from Spring Steel and snap over 3/16" Rod. Special sizes and configurations are available by custom order.



+ Minimum Box Quantity per order required, check website for details.

Part Number	Description
SHB-17562LV-3	1.75" L x .062 Wire Modified LV-Bottom for 3/16" Rod

## 3/16" Front-style Snap Hooks

Manufactured with front snapping action for quick placement and good retention. Made from Spring Steel and snap over 3/16" Rod.

Special sizes and configurations are available by custom order.



Part Number	Description
SHF-17544C-3	1.75" Long x .044 Wire Large C-Bottom for 3/16" Rod
SHF-17544V-3	1.75" Long x .044 Wire V-Bottom for 3/16" Rod
SHF-17562V-3	1.75" Long x .062 Wire V-Bottom for 3/16" Rod
SHF-4062V-3	4" Long x .062 Wire V-Bottom for 3/16" Rod

Need a hook you don't see listed? - We can make them to order!

## 3/16" 90°-style Snap Hooks

Manufactured for parallel orientation with the crossbar. Made from Spring Steel and snap over 3/16" Rod.

Special sizes and configurations are available by custom order.

+ Minimum Box Quantity per order required, check website for details.



Part Number	Description
SHR-2044V-3	2" L x .044 Wire V-Bottom turned 90° for a 3/16" Rod+
SHR-2062V-3	2" L x .062 Wire V-Bottom turned 90° for a 3/16" Rod

## Standard Rotating Hooks

### WH-1U and WH-1V

WH-1U and WH-1V - Standard rotators swivel or rotate freely in either direction. Rotating mechanism incorporates a double ball bearing design. Top hooks are made from 0.236 diameter mild steel and bottom hooks are made from 0.188 mild steel, overall length is 4-1/2". Hanging capacity is in excess of 200 pounds. Stocked in "V" bottom (WH-1V) and "U" bottom (WH-1U).



Rotators can be custom manufactured with a Laser-cut or machined gears to provide smooth indexing where needed. Our engineers can assist you in a design that incorporates proper indexing for your requirements. Contact us to discuss the variety of available options.

Part Number	Description
WH-1U	4.5" Long x 2" Wide U-Shape Bottom Rotator
WH-1V	4.5" Long x 2" Wide V-Shape Bottom Rotator

### WH-1U-4016 and WH-1V-4016

We start with standard WH-1U and WH-1V rotators and weld on a sprocket to allow for chain-driven rotation. The sprocket is precision cut from 0.105" thick steel and has 16 teeth. Simply mount a length of standard #40 chain next to the path of travel; the sprocket's teeth will catch on the rotator, allowing for smooth, automatic rotation on any conveyor system. Hanging capacity is in excess of 200 lbs. Stocked in "V" bottom (WH-1V-4016) and "U" bottom (WH-1U-4016).

Rotators can be manufactured with different hook designs, alternative sprockets, latches and indexing options. Our engineers can assist you in designing a rotator that will work for your specific requirements. Contact us to discuss your rotating requirements.



Part Number	Description
WH-1U-4016A	4.5" Long U-Bottom Rotator with #4016 Sprocket Above Bearing
WH-1V-4016A	4.5" Long V-Bottom Rotator with #4016 Sprocket Above Bearing
WH-1U-4016B	4.5" Long U-Bottom Rotator with #4016 Sprocket Below Bearing
WH-1V-4016B	4.5" Long V-Bottom Rotator with #4016 Sprocket Below Bearing

## Custom Rotators and Indexers

We can design and produce rotating and indexing hooks for all your hanging requirements. Rotators can be manufactured with welded pins and laser-cut or machined gears to provide smooth indexing where needed, and can be designed for powered rotation, with or without the use of load bars. Our engineers can assist you with a design that best suits your specific application. Contact us to discuss the variety of available options.

### Examples of Custom Rotators and Indexers



Skate Wheel Rotator



Star Wheel Rotator



Manual 180° Rotator with Gravity Latch



Angle Pivot™ 45° Indexer

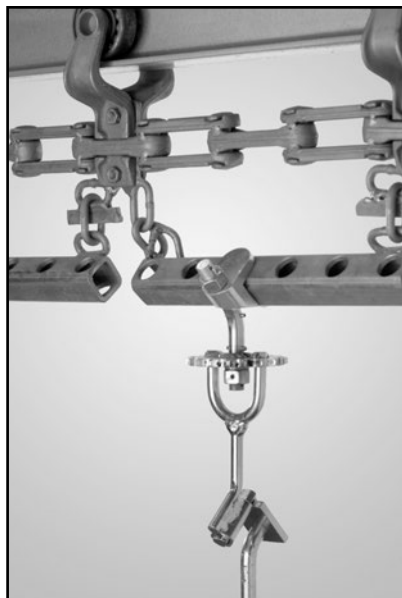

Sprocket Rotator on a Continuous Load Bar

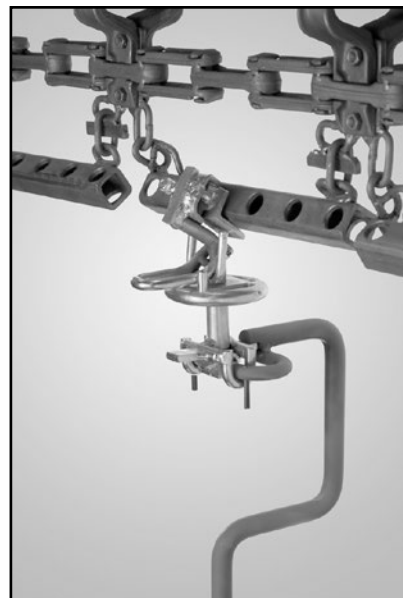

Latching Powered and Manual 180° Rotator

## Powderpeg Rack

Patent #5,524,774

The most flexible, inexpensive and easy to use rack available. Engineered for lightning fast unloading and unparalleled versatility

The patented design incorporates vertical made from 3/4" Square, 18 gauge mild tubing and have holes spaced every on-center for 30", 36", 42", and 60" lengths. are spaced every 3" on-center for 72" The vertical tubes can be ordered with on one side or two. Frames ordered with two sides allow for coating from both sides rack. Other lengths and hole spacing are by custom order.

The top "U" tube is manufactured from 5/8" tubing and slips easily into the 3/4" tube. "U" tube and vertical tubes are held firmly cotter pin or machine screw (cotter pins are Holes are strategically placed in the top single or two-point hanging. Due to the cantilever design, grounding is internal and infrequent stripping. Stock widths are available in 20", 25", 30" and 40". Other are available by custom orders.

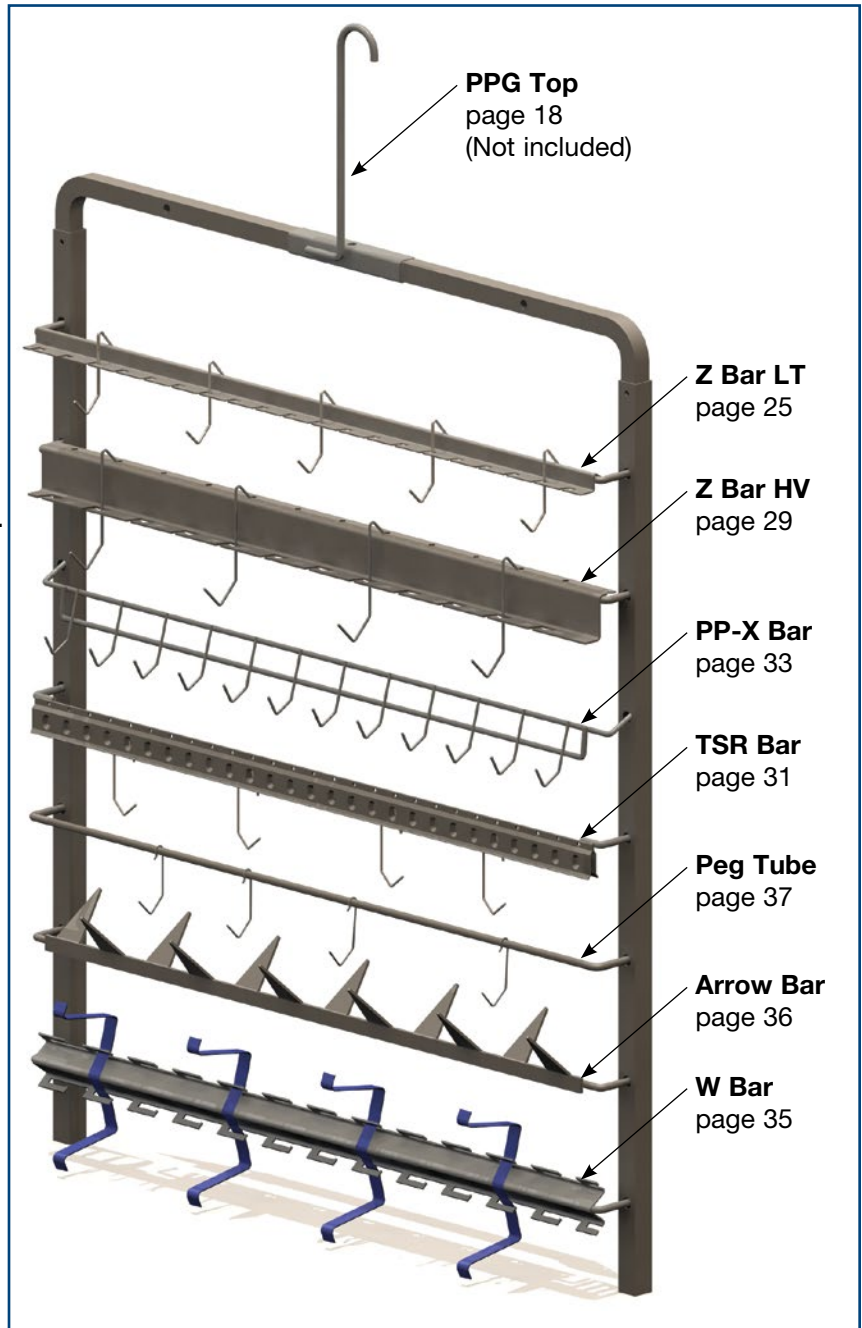

## Peg Hooks

Made from 0.120" or 0.150" C.R.S. wire. Easily replaceable hooks designed to give added versatility to the POWDERPEG RACK. PEGHOOKS can be made in a variety of dimensions, materials and wire sizes to satisfy your requirements.

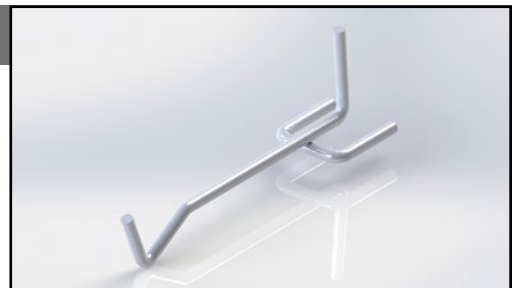

Part Number	Description	Box Qty.
Peghook-120	5"L x .120 Ø Wire Single Peghook for Powder Peg Rack	100
Peghook-150	5"L x .150 Ø Wire Single Peghook for Powder Peg Rack	100

**Tips:** Use to hang larger parts or to hang long parts horizontally. Downward pressure on the hook insures contact inside the tube, providing excellent grounding.

## Powderpeg Racks

Part Number	Description	Part Number	Description
PPG20W-30L	20"W X 30" L 3pc. Frame-4" hole centers, 1-side	PPG30W-30L	30"W x 30" L 3pc. Frame-4" hole centers, 1-side
PPG20W-30L2	Holes on both sides of rack	PPG30W-30L2	Holes on both sides of rack
PPG20W-36L	20"W x 36"L 3pc. Frame-4" hole centers, 1-side	PPG30W-36L	30"W x 36"L 3pc. Frame-4" hole centers on 1-side
PPG20W-36L2	Holes on both sides of rack	PPG30W-36L2	Holes on both sides of rack
PPG20W-42L	20"W x 42"L 3pc. Frame-4" hole centers, 1-side	PPG30W-42L	30"W x 42"L 3pc. Frame-4" hole centers on 1-side
PPG20W-42L2	Holes on both sides of rack	PPG30W-42L2	Holes on both sides of rack
PPG20W-60L	20"W x 60"L 3pc. Frame-4" hole centers, 1-side	PPG30W-60L	30"W x 60"L 3pc. Frame-4" hole centers on 1-side
PPG20W-60L2	Holes on both sides of rack	PPG30W-60L2	Holes on both sides of rack
PPG20W-72L2	20"W x 72"L frame-3" hole centers, both sides	PPG30W-72L2	30"W x 72"L frame-3" hole centers, both sides
PPG25W-30L	25"W x 30"L 3pc. Frame-4" hole centers, 1-side	PPG40W-30L	40"W x 30"L 3pc. Frame-4" hole centers on 1-side
PPG25W-30L2	Holes on both sides of rack	PPG40W-30L2	Holes on both sides of rack
PPG25W-36L	25"W x 36"L 3pc. Frame-4" hole centers, 1-side	PPG40W-36L	40"W x 36"L 3pc. Frame-4" hole centers on 1-side
PPG25W-36L2	Holes on both sides of rack	PPG40W-36L2	Holes on both sides of rack
PPG25W-42L	25"W x 42"L 3pc. Frame-4" hole centers, 1-side	PPG40W-42L	40"W x 42"L 3pc. Frame-4" hole centers on 1-side
PPG25W-42L2	Holes on both sides of rack	PPG40W-42L2	Holes on both sides of rack
PPG25W-60L	25"W x 60"L 3pc. Frame-4" hole centers, 1-side	PPG40W-60L	40"W x 60"L 3pc. Frame-4" hole centers on 1-side
PPG25W-60L2	Holes on both sides of rack	PPG40W-60L2	Holes on both sides of rack
PPG25W-72L2	25"W x 72"L frame-3" hole centers, both sides	PPG40W-72L2	40"W X 72"L frame-3" hole centers, both sides

## Detachable Powderpeg Top

The PPG-TOP is a single hanger and combines a stem of 1/4" wire welded to a channel. The hanger attaches to the top of the POWDERPEG RACK with a 1/4-20 nut and bolt. The PPG-TOP is available in 4 separate lengths, configured parallel or perpendicular with either a C or V top style. Custom versions of this top are available. Please specify length, top style and orientation when ordering.

The PPG-TOP-A is a "coat hanger" concept design and is also made out 1/4" wire, it too attaches to the top of the POWDERPEG RACK by connecting to the two punched holes, providing greater stability. The detachable PPG-TOP-A tops are made to order. Please specify length, width, top style and orientation when ordering.

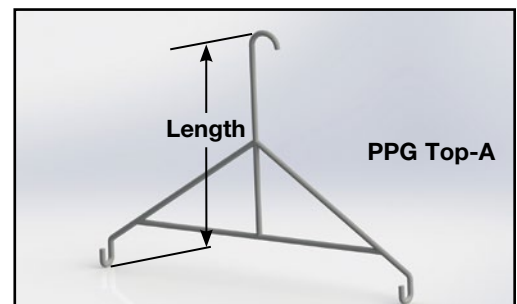
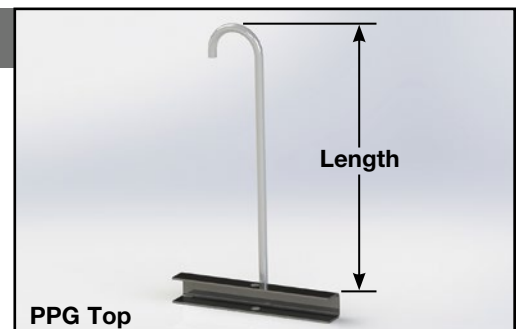

Part Number	Description
PPGTOP-6-V-PAR	6" Powderpeg Top V-Style Parallel Orientation
PPGTOP-6-V-PERP	6" Powderpeg Top V-Style Perpendicular Orientation
PPGTOP-6-C-PAR	6" Powderpeg Top C-Style Parallel Orientation
PPGTOP-6-C-PERP	6" Powderpeg Top C-Style Perpendicular Orientation
PPGTOP-12-V-PAR	12" Powderpeg Top V-Style Parallel Orientation
PPGTOP-12-V-PERP	12" Powderpeg Top V-Style Perpendicular Orientation
PPGTOP-12-C-PAR	12" Powderpeg Top C-Style Parallel Orientation
PPGTOP-12-C-PERP	12" Powderpeg Top C-Style Perpendicular Orientation
PPGTOP-18-V-PAR	18" Powderpeg Top V-Style Parallel Orientation
PPGTOP-18-V-PERP	18" Powderpeg Top V-Style Perpendicular Orientation
PPGTOP-18-C-PAR	18" Powderpeg Top C-Style Parallel Orientation
PPGTOP-18-C-PERP	18" Powderpeg Top C-Style Perpendicular Orientation
PPGTOP-24-V-PAR	24" Powderpeg Top V-Style Parallel Orientation
PPGTOP-24-V-PERP	24" Powderpeg Top V-Style Perpendicular Orientation
PPGTOP-24-C-PAR	24" Powderpeg Top C-Style Parallel Orientation
PPGTOP-24-C-PERP	24" Powderpeg Top C-Style Perpendicular Orientation

## Powderpeg Rack Tips

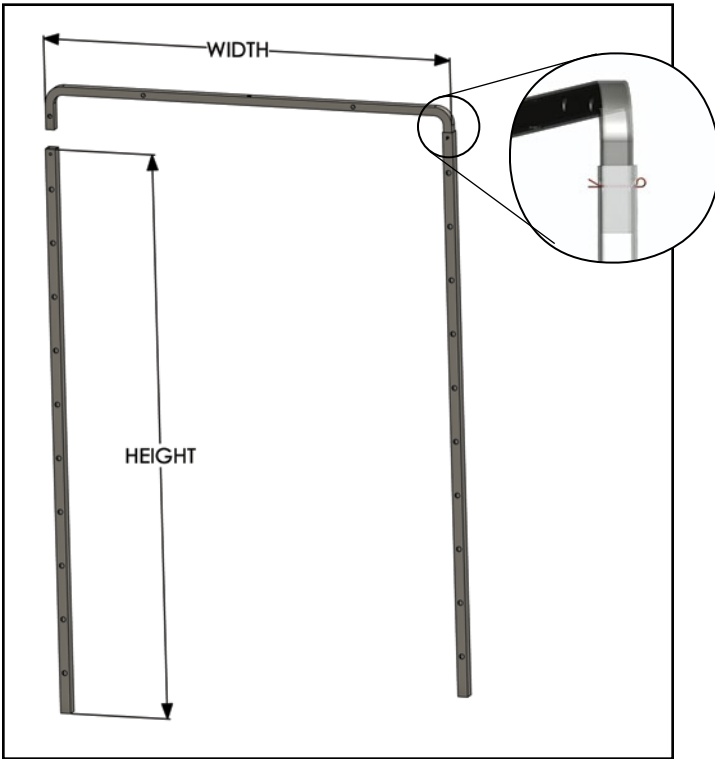

### 1. Size Your Rack

First pick your desired rack size. Stock frame widths range from 20" - 40" wide and 30" - 72" tall. For custom sizes contact one of our engineers.

The Powder Peg Rack requires no special tools to assemble. Simply slide the tubes together and insert a cotter pin (provided).

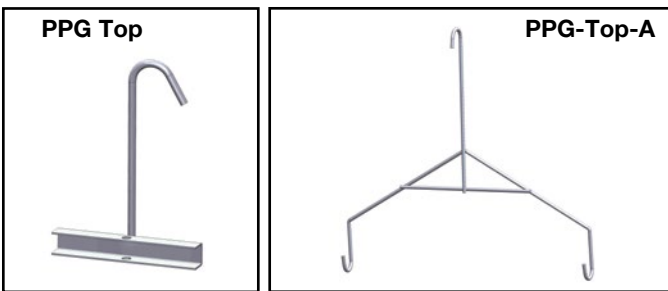

### 3. Pick your Hanging Style

The PPGTOP attaches to the rack with a piece of channel bracket, and is then secured by a standard 1/4-20 bolt. The PPGTOP is best for customers hanging smaller parts in balanced loads.

The PPG-TOP-A attaches via two hang points that insert into two holes at the top of the rack. The PPG-TOP-A is best for customers who desire a more stable hang.

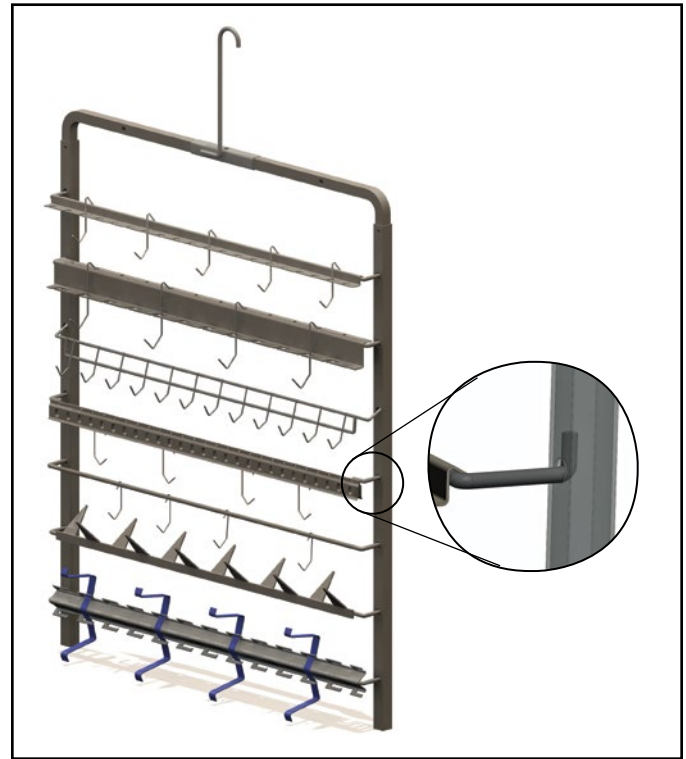

### 2. Pick your Crossbar(s)

The Powderpeg Rack supports a variety of different crossbars. To learn more about the advantages of each crossbar take a look at its corresponding catalog page.

Crossbars attach to the rack with a simple cantilever mechanism contained within the uprights, so you'll always have a reliable ground regardless of paint accumulation.

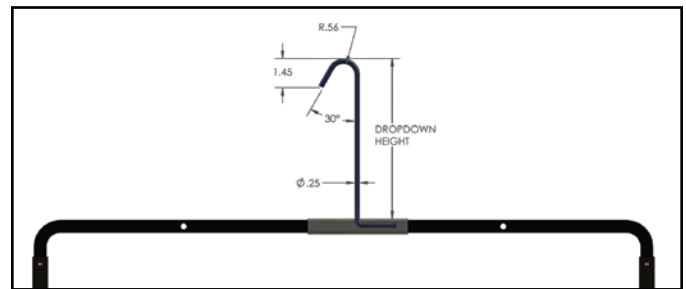

### 4. Measure your Vertical Dropdown

All PPG-TOP-A and custom PPGTOP rack hangers are made to order. When placing your order we'll ask for some information about your desired dropdown distance and hanging orientation. We have existing standards for the other dimensions (pictured), but if you need a custom version contact one of our engineers.

## Slip Rack

The custom designed Slip Rack allows for good versatility and easy configuration for use in powder, liquid and e-coat applications. The male-to-female crossbar insertion method can be employed by either a frame as shown to the right or a stem design. Mighty Hook crossbars can be constructed to fit the Slip Rack design to create maximum density while allowing for flexibility in a high part variability environment.

**Made to Order**

Contact our engineers to discuss the specific requirements for your operation and we will assist you in designing and producing the proper racks and crossbars for your application.

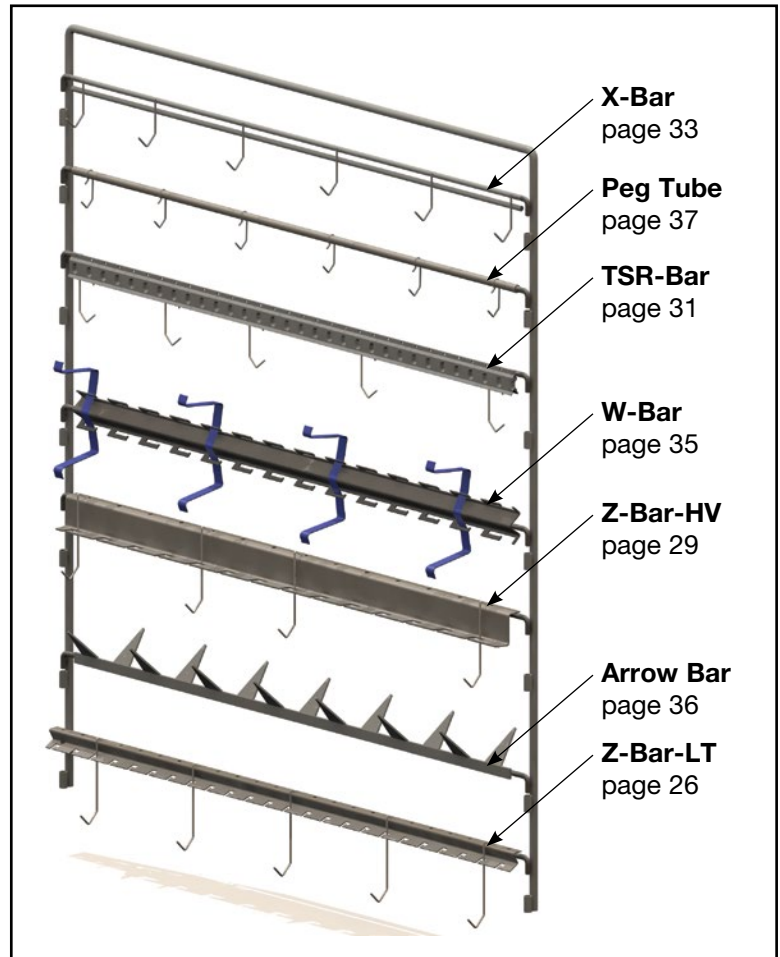

## Socket System Rack

Each Socket Rack is custom designed to achieve maximum density and provide flexibility for part variability. The tube socket holders use replaceable and interchangeable hanging tips and holders for parts that cannot be held by traditional methods.

The sockets can be welded to one or both sides of the rack to provide maximum part density, and can be produced as a U-Frame (shown) or on a single stem. Multiple single stem racks can be employed to hang long parts horizontally. Grounding between the tip and the socket is never compromised as the tube socket is protected with a silicone replaceable cap that protects the internal contact between the tip and the socket.

**Made to Order**

Contact our engineers to discuss the specific requirements for your operation and we will assist you in designing and producing the proper racks and crossbars for your application.

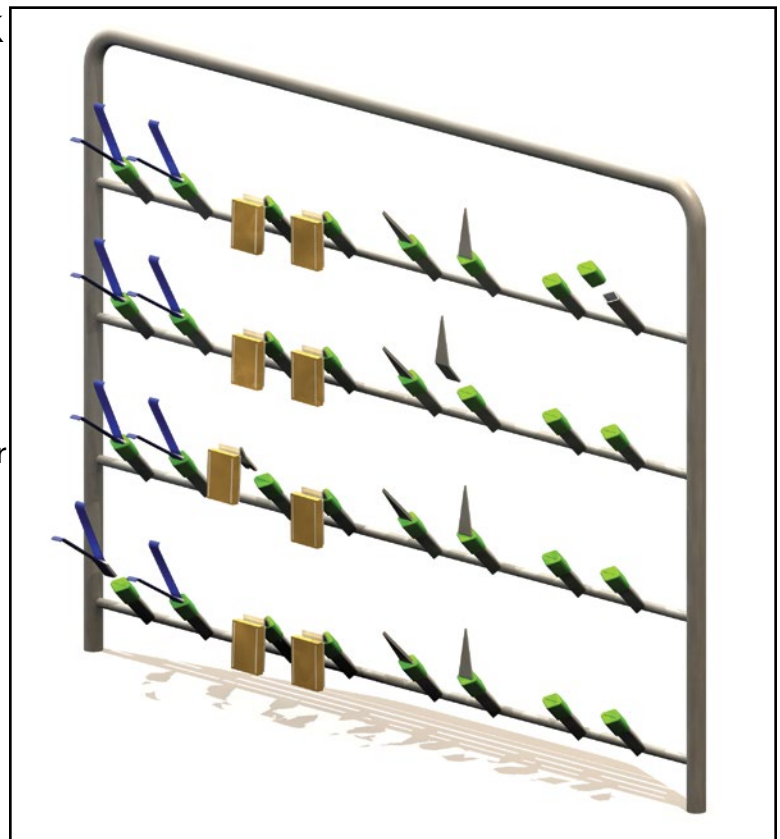

## Welded Racks for Powder Coating, Liquid Coating and E-Coating

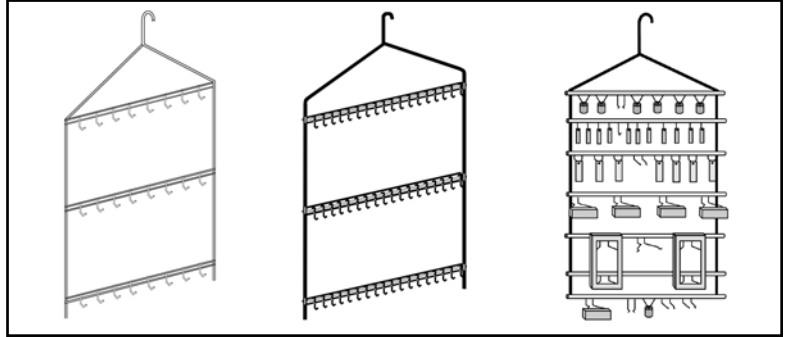

For over two decades Mighty Hook has been an innovator in the design and construction of coating racks and hooks. We gained

experience and knowledge the hard way... by spending countless hours on our own powder coating line in an attempt to achieve maximum line density and efficiency. The creative solutions we developed have resulted in Mighty Hook being awarded 12 U.S. Patents.

### *Experience does make the difference!*

Our advanced manufacturing facility provides the latest equipment for forming, welding, and custom fabrication of racks and fixtures. Our experienced engineers will assist you in designing a hanging system that optimizes your coating facility output. When possible, we will incorporate the components featured in this catalog. Our racks provide maximum production for the least cost. Send us your sketch or problem part and our engineering and design staff will work expeditiously to provide you with a hanging solution.

The following diagram is provided to assist us in designing the proper rack for your operation. If you have an idea what rack dimensions will maximize your output, please copy the form and fill in as much information as possible and email or fax it back to us. After reviewing the diagram, one of our engineers will contact you to discuss the proper size and configuration. We suggest supplying you a prototype of our design for your evaluation. Our engineers will provide you with both a prototype and production quantity quotation.

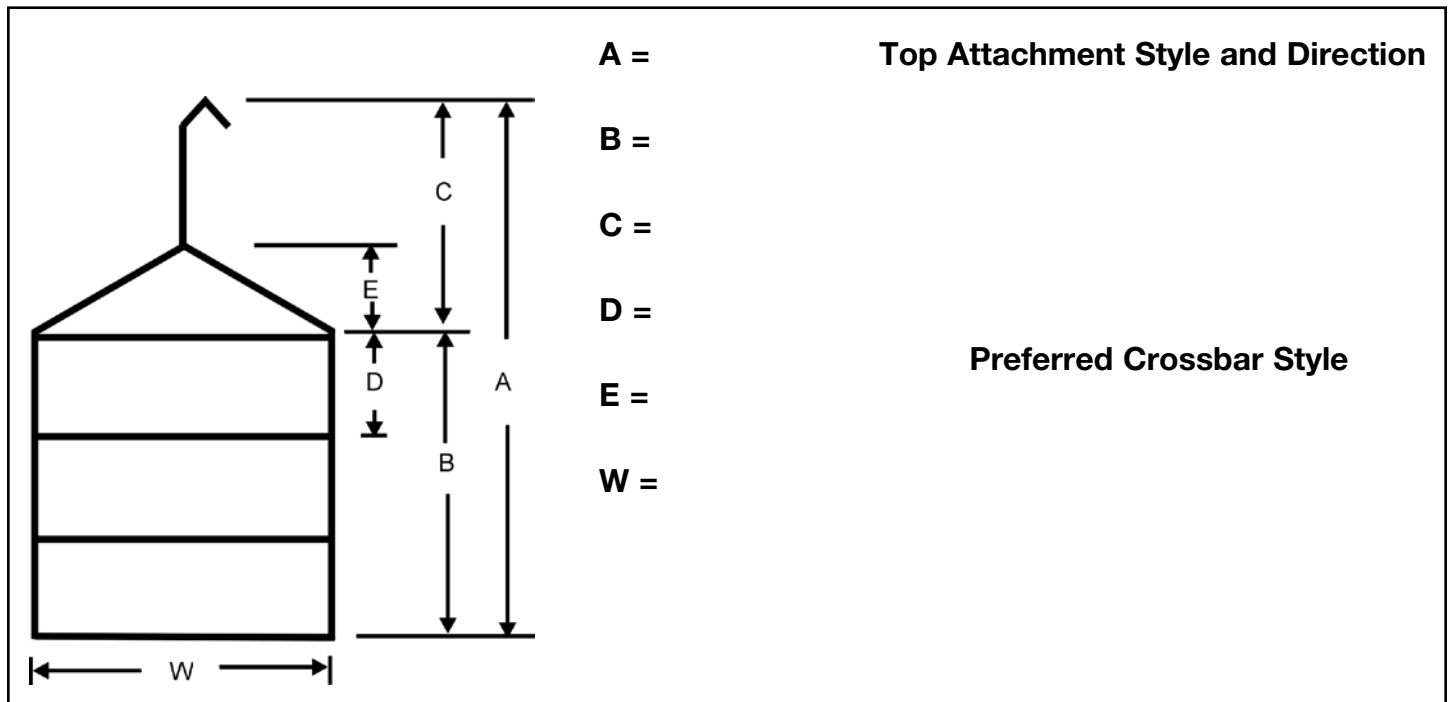

**Tips:** Consider a design with leg extensions that keep bottom hooks from breaking when they're set on the floor. Use multi-level racks to achieve higher line density. Job shops may want to consider an adjustable rack with detachable hooks to meet ever changing production requirements. We also suggest experimenting with the rack included in our SAMPLE KIT as they offer multiple hanging options, see page 65.

# Mighty Mono Racks

## The Best Utility Tree Racks in the Industry

The industry standard in tree racks for over two decades. The vertical stem is constructed of 3 gauge (0.250") diameter wire, with 8 gauge (0.150") diameter cross arms as standard. Racks with 10" wide arms are in stock for immediate delivery. Optional arm styles shown can be purchased by special order. BR style racks include the additional brace for added strength. We can provide custom racks manufactured to your specifications.

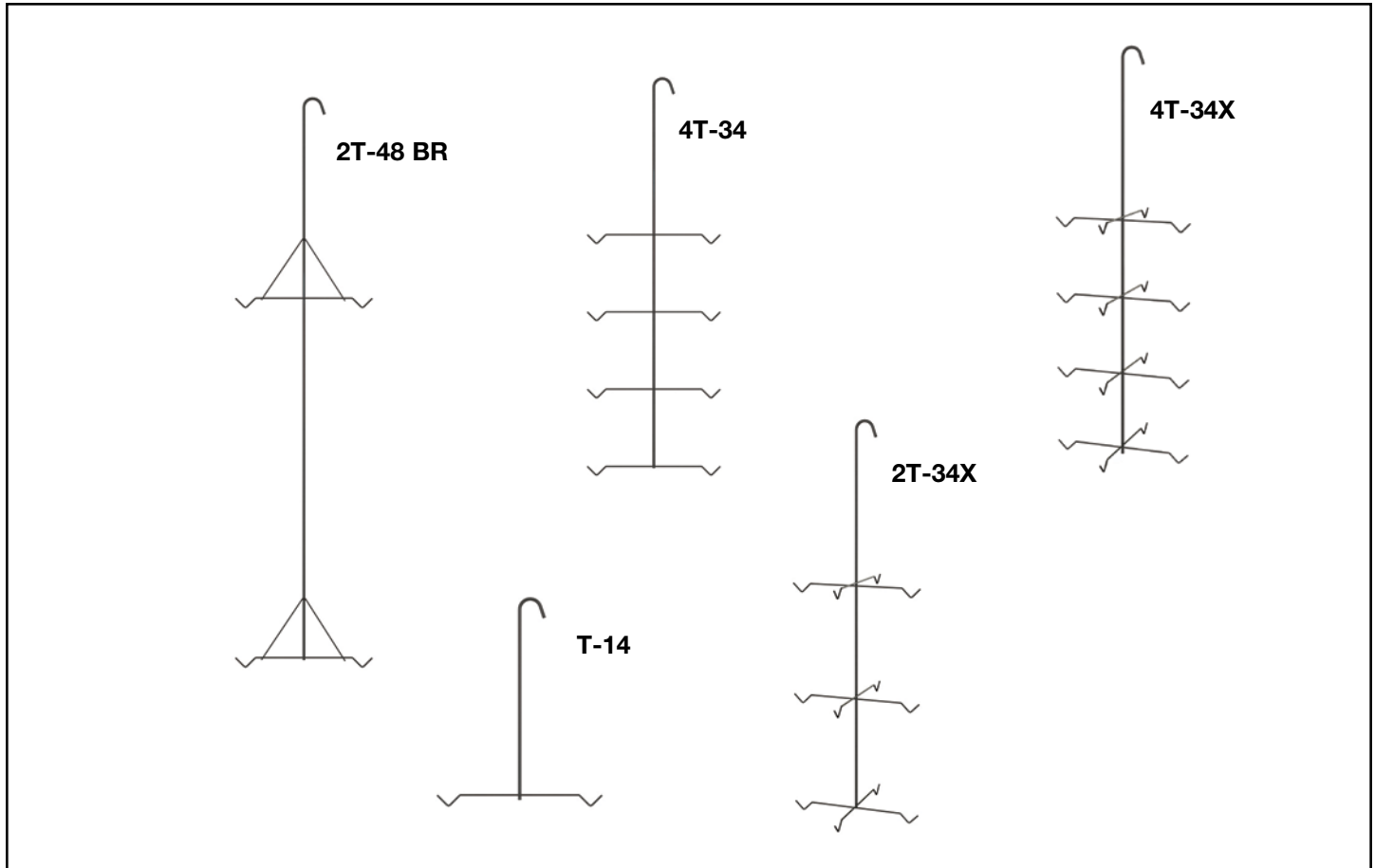

Part Number	Description	Part Number	Description
T-14	14"L mono rack 1 tier	3T-34	34"L mono 3 tier
T-14X	14"L mono 1 tier (2- 10"standard arms in X form)	3T-34X	34"L mono 3 tier (2- 10"standard arms in X form)
T-16BR	16"L 1 tier mono w/brace	3T-48BR	48"L mono 3 tier w/brace
2T-34	34"L mono rack 2 tier	4T-34	34"L mono 4 tier
2T-34X	34"L mono 2 tier (2- 10"standard arms in X form)	4T-34X	34"L mono 4 tier (2- 10"standard arms in X form)
2T-48BR	48"L mono 2 tier w/brace	4T-48BR	48"L mono 4 tier w/brace

## Z-Base Oven Proof Batch Rack

The space saving mobile solution for staging, finishing and drying parts

With a heat tolerance of 450°F, the "Z-BASE" batch rack provides a single solution for hanging, staging, and finishing parts for batch coating applications.

The unique "Z-Base" design allows multiple racks to nest together saving you valuable plant floor space. It also reduces valuable labor time by moving from staging area to the spray booth to the bake oven, without removing hanging parts. All racks come with a slotted hook holder, and a set of casters. Add or subtract hang bars to adjust to the size of the parts you are finishing.

Rack Construction: 12 gauge steel with a base of 1-1/2" Sq. tubing with black powder coat finish. The hang bars and uprights are 1-5/16" round tubing, galvanized steel. Wheels are 4" x 1-3/8" glass filled, swivel stem casters, rated to 450°F. Standard sizes are listed below, custom sizes available on special order.



Part Number	Description	Part Number	Description
BRZ-51L66H	51" Long x 66" High x 22" Wide	BRZ-CASTER	4" x 1-3/8" Swivel Stem Casters - 1/2-13 Thd.
BRZ-51L78H	51" Long x 78" High x 22" Wide	BRZ-RAIL51	51" Rail, Hook Holder & Hardware
BRZ-63L66H	63" Long x 66" High x 22" Wide	BRZ-RAIL63	63" Rail, Hook Holder & Hardware
BRZ-63L78H	63" Long x 78" High x 22" Wide	BRZ-RAIL75	75" Rail, Hook Holder & Hardware
BRZ-63L90H	63" Long x 90" High x 22" Wide	BRZ-STEERHANDLE	Includes Front & Back Steering Handles
BRZ-75L66H	75" Long x 66" High x 22" Wide		
BRZ-75L90H	75" Long x 90" High x 22" Wide		

### ACCESSORIES:

**SECOND RAIL, HOOK HOLDER and HARDWARE** - Mechanically attach anywhere along the uprights. Hook holder and all necessary hardware included.

## Mighty Multi Rack

**Multipurpose Rack for everyday coating requirements**

MIGHTY MULTI Racks are able to hold up to 42 parts. The rack folds flat for easy storage or burn-off. The important feature of this unit is that the hooks are staggered to allow a greater part density without the parts bumping together. Extra wires can be added to facilitate double hanging. Two stock styles: MIGHTYMULTI-2 incorporates 0.120" diameter wire arms. MIGHTYMULTI-1 incorporates 0.150" diameter wire arms; Custom designs are available.

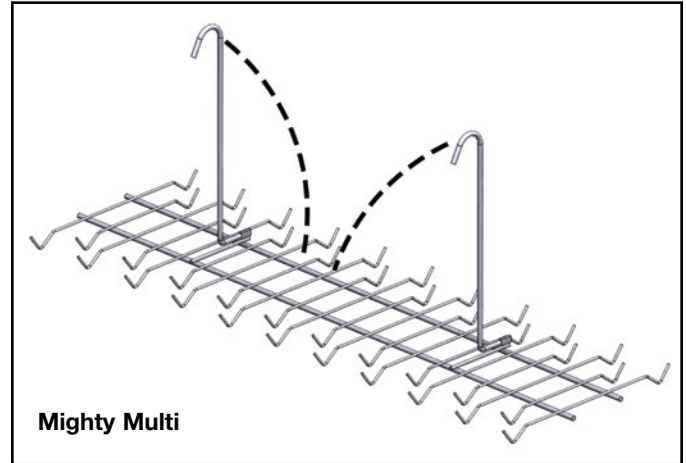

Part Number	Description
MIGHTYMULTI-2	34" Wide x 10" Deep - Cross Arms of .120 Wire
MIGHTYMULTI-1	34" Wide x 10" Deep - Cross Arms of .150 Wire

## Snap On Load Bars

**Snap On Load Bars™ increase line density on existing conveyors**

Our Snap On Load Bars (patent pending) increase line density on existing conveyors with minimal labor and cost. They are made of .250" steel, and incorporate stainless steel retaining clips for durability. Available in four basic sizes that fit most trolley spacing for I-Beams or enclosed track conveyors (see web site for more information). They "snap" onto H-Attachments without having to remove the pins, saving labor. The minimum gap width of the H-Attachment must be at least 9/16" to accommodate the Load Bar. Load Bars have hanging points every 2". Load Bars are made to order, contact our engineers to have them customized and produced for your specific conveyor application.

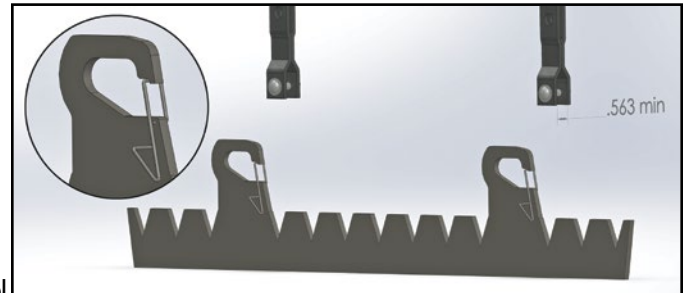

Part Number	Description
SOLB-6-6V	16" OAL x 0.25" T Steel; 6 V-Style Hang Points; 6" Trolley Centers
SOLB-8-5V	14.375" OAL x 0.25" T Steel; 5 V-Style Hang Points; 8" Trolley Centers
SOLB-12-9V	21.88" OAL x 0.25" T Steel; 9 V-Style Hang Points; 12" Trolley Centers
SOLB-16-13V	29.75" OAL x 0.25" T Steel; 13 V-Style Hang Points; 16" Trolley Centers
H-Attachment	Call One of our Engineers for Pricing and Sizing

**Made to Order**

**Contact our engineers to discuss the specific requirements for your operation and we will assist you in designing and producing the proper load bars for your application.**

## Powderpeg Rack Cart

Made for Powderpeg Rack. The cart can be used for storage or preloading. 6" spacing between the holes lets the cart to hold up to 9 racks at one time. The dimple hole design allows for easy insertion, while holding the racks securely preventing movement while transporting. Large wheel diameters make the cart more ergonomic. The open-ended front allows for easy access to the rear of the cart.

Part Number	Description
PPGRC-1	Powderpeg Rack Cart



## Hook Storage / Stripping Cart

Integrated hook storage and burn-off cart. The A-Frame design is compact, but versatile and holds a variety of hook sizes efficiently and ergonomically without tangling. The top frame lifts off the base and can be placed on the burn-off oven trolley or set directly inside the oven. Hooks are handled only twice, during loading and unloading from the line, saving significant and valuable labor hours by eliminated unnecessary handling and sorting. Heavy-duty welded construction provides years of constant usage. Standard cart designs are available but can be easily and cost effectively customized for your specific requirements. Cart is available with a removable or fixed base. Contact a Mighty Hook engineer for options.

Part Number	Description
HHR-4852-AV	Hook Storage / Stripping Cart



# Z-BAR-LT and Z-BAR-HV Crossbars and Hooks

**Patent #6,189,709**

**Cutting-edge crossbar technology!  
Never see a hole in your painting line again!**

The patented, innovative design solves most of the hanging problems of powder and liquid spraying by incorporating interchangeable hooks with unlimited configurations to maximize line density and part positioning. Low cost, durable spring steel Z-HOOKS quickly lock into position and are easily removed. The locking design eliminates costly hook loss by keeping the hooks fixed into position as securely as if they were welded.

We offer these Z-Bar crossbars with welded ends for our Standard Racking Systems and with no welded ends for your custom rack requirements. The crossbars can be fitted to practically any racking system available. With our advanced manufacturing capabilities we can provide you with a customized Z-Bar to fit in your current hanging system. Packaged 25 pieces per box.

If you have questions on any of our hanging products or need assistance in selecting a hanging solution for your requirements please contact one of our engineers to discuss. Our goal is unparalleled service and superior product design to meet all your hanging needs.

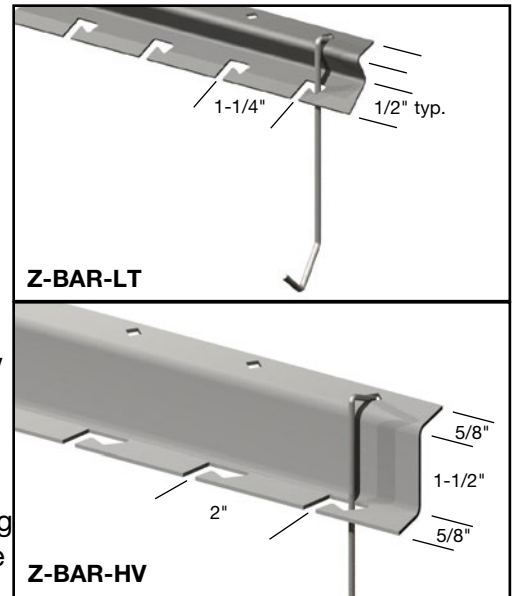

## Z-BAR-LT Crossbars

**Patent # 6,189,709**

Z-BAR-LT (for smaller parts). Made from 18 gauge steel with on-center hook positions of 1.25". Accepts hooks made from 0.031 to 0.105 wire diameter spring steel. Bars are stocked in 20", 25", 30" and 40" lengths. Custom lengths and hook position spacing available by special order.

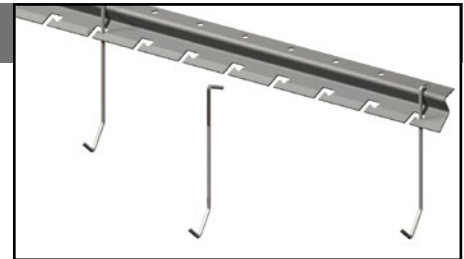

Part Number	Description	Part Number	Description
Z-BAR20	20" Z-BAR LIGHT-NO ENDS 18 GA.	Z-BAR30	30" Z-BAR LIGHT-NO ENDS 18 GA.
Z-BAR25	25" Z-BAR LIGHT-NO ENDS 18 GA.	Z-BAR40	40" Z-BAR LIGHT-NO ENDS 18 GA.

## Z-BAR-LT-PP

Z-BAR-LT-PP- Designed for use on the POWDERPEG RACK on page 17. The 1/4" diameter wire peg-end slips in rack for quick change.

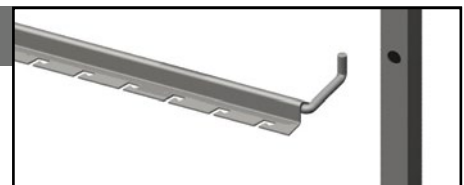

Part Number	Description	Part Number	Description
Z-BAR-PP-20	20" Z-Bar Adj. Crossbar - 16 Hook points on 1.25" Centers	Z-BAR-PP-30	30" Z-Bar Adj. Crossbar - 24 Hook points on 1.25" Centers
Z-BAR-PP-25	25" Z-Bar Adj. Crossbar - 20 Hook points on 1.25" Centers	Z-BAR-PP-40	40" Z-Bar Adj. Crossbar - 32 Hook points on 1.25" Centers

## Z-BAR-LT-D

Z-BAR-LT-D - Diamond shaped wire form end allows hanging choices above and below the bar. Suspend from your line and daisy-chain down using our MIGHTY HOOKS.



Part Number	Description	Part Number	Description
Z-BAR-D-20	18 GA. Z-BAR LT 20" WITH DIAMOND ENDS	Z-BAR-D-30	18 GA. Z-BAR LT 30" WITH DIAMOND ENDS
Z-BAR-D-25	18 GA. Z-BAR LT 25" WITH DIAMOND ENDS	Z-BAR-D-40	18 GA. Z-BAR LT 40" WITH DIAMOND ENDS

## Z-Hooks-LT

Patent # 6,189,709

### Revolutionary Hooks for the Revolutionary Hanging System.

Patented design for the Z-BAR Crossbar system. Our stock Z-HOOKS are manufactured from hard drawn spring steel and offer unparalleled versatility for maximizing your line density and product output. Z-HOOKS are lower in cost than any other replaceable hook and crossbar system. We offer over 150 sizes and styles in stock.

**Tips:** The hooks shown are stocked varieties of Z-HOOKS that offer flexible hanging solutions. If you have specific requirements, contact our experienced staff to assist you in designing a custom hanging solution. Samples and prototypes can be provided upon request, contact one of our engineers.

### Standard Z-Hooks for Z-BAR-LT

Z-HOOKS-LT - Designed for use in the Z-BAR-LT Crossbar. Hooks are stocked in 0.044", 0.062", 0.076" and 0.091" wire diameters, lengths from 1.75" to 6" (measured overall) and in "V" shape bottom or "C" shape bottom styles. Hooks are also available in perpendicular, 90° and 45° styles made to order. Hooks are packaged in box quantities of 2000 pcs. We have 2 Z-Hooks that now require Min Order Qty of 5 boxes

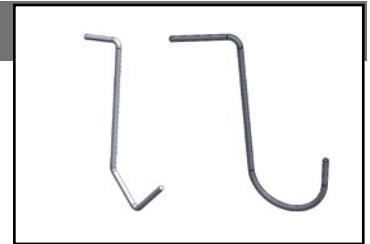

+ Minimum Box Quantity of 5 boxes per order required.

Part Number	Description	Part Number	Description
Z-017544V	Z-hook Lt. 1.75" L x .044 wire V-bottom	Z-02.5076V	Z-hook Lt. 2.5" L x .076 wire V-bottom
Z-017544C	Z-hook Lt. 1.75" L x .044 wire C-bottom	Z-02.5076C	Z-hook Lt. 2.5" L x .076 wire C-bottom
Z-017562V	Z-hook Lt. 1.75" L x .062 wire V-bottom	Z-02.5091V	Z-hook Lt. 2.5" L x .091 wire V-bottom
Z-017562C	Z-hook Lt. 1.75" L x .062 wire C-bottom	Z-02.5091C	Z-hook Lt. 2.5" L x .091 wire C-bottom
Z-017576V	Z-hook Lt. 1.75" L x .076 wire V-bottom	Z-03044V	Z-hook Lt. 3" L x .044 wire V-bottom
Z-017576C	Z-hook Lt. 1.75" L x .076 wire C-bottom	Z-03044C	Z-hook Lt. 3" L x .044 wire C-bottom
Z-017591V	Z-hook Lt. 1.75" L x .091 wire V-bottom	Z-03062V	Z-hook Lt. 3" L x .062 wire V-bottom
Z-017591C	Z-hook Lt. 1.75" L x .091 wire C-bottom	Z-03062C	Z-hook Lt. 3" L x .062 wire C-bottom
Z-02044V	Z-hook Lt. 2" L x .044 wire V-bottom	Z-03076V	Z-hook Lt. 3" L x .076 wire V-bottom+
Z-02044C	Z-hook Lt. 2" L x .044 wire C-bottom	Z-03076C	Z-hook Lt. 3" L x .076 wire C-bottom
Z-02062V	Z-hook Lt. 2" L x .062 wire V-bottom	Z-03091V	Z-hook Lt. 3" L x .091 wire V-bottom
Z-02062C	Z-hook Lt. 2" L x .062 wire C-bottom	Z-03091C	Z-hook Lt. 3" L x .091 wire C-bottom
Z-02076V	Z-hook Lt. 2" L x .076 wire V-bottom	Z-04044V	Z-hook Lt. 4" L x .091 wire V-bottom+
Z-02076C	Z-hook Lt. 2" L x .076 wire C-bottom	Z-04044C	Z-hook Lt. 4" L x .091 wire C-bottom
Z-02091V	Z-hook Lt. 2" L x .091 wire V-bottom	Z-04062V	Z-hook Lt. 4" L x .062 wire V-bottom
Z-02091C	Z-hook Lt. 2" L x .091 wire C-bottom	Z-04062C	Z-hook Lt. 4" L x .062 wire C-bottom
Z-02.5044V	Z-hook Lt. 2.5" L x .044 wire V-bottom	Z-04076V	Z-hook Lt. 4" L x .076 wire V-bottom
Z-02.5044C	Z-hook Lt. 2.5" L x .044 wire C-bottom	Z-04076C	Z-hook Lt. 4" L x .076 wire C-bottom
Z-02.5062V	Z-hook Lt. 2.5" L x .062 wire V-bottom	Z-04091V	Z-hook Lt. 4" L x .091 wire V-bottom
Z-02.5062C	Z-hook Lt. 2.5" L x .062 wire C-bottom	Z-04091C	Z-hook Lt. 4" L x .091 wire C-bottom

### Z-Jam Hooks for Z-BAR-LT

Z-JAM - Made from hard drawn spring wire. Z-JAM-LT hooks hold tubing up to 1.5" diameter. Available in wire sizes from 0.062"-0.105". Packaged 1000 peices per box.

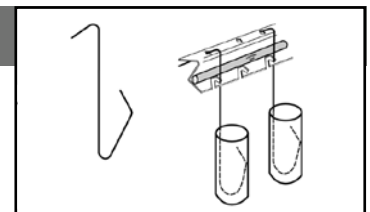

Part Number	Description	Part Number	Description
Z-JAM-3/4.076	5" L-JAM FITS 3/4" TO 1" TUBE	Z-JAM-1.076	6" L-JAM FITS 1" TO 1.5" TUBE
Z-JAM-3/4.091	5" L-JAM FITS 3/4" TO 1" TUBE	Z-JAM-1.091	6" L-JAM FITS 1" TO 1.5" TUBE

## Z-Out Hooks for Z-Bar-LT

Z-OUT-R/L - Made from hard drawn spring wire. The outward pressure helps to maintain a positive ground. Hook pairs fit into holes as small as 1/8". Order in left and right paired sets. Available for the Z-BAR-LT. Packaged 1000 pcs. per box.

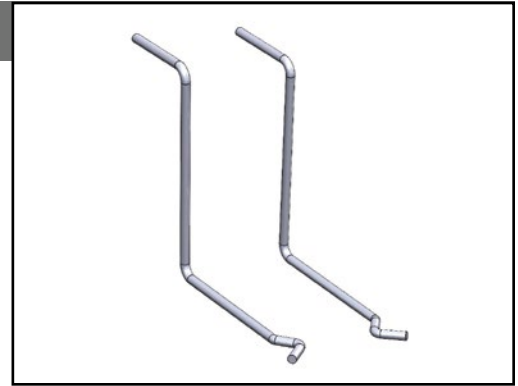

Part Number	Description	Part Number	Description
Z-OUT-R2.062	2" L X .062 WIRE- RIGHT-TENSION GRIPS PART	Z-OUT-L2.076	2" L X .076 WIRE- LEFT- TENSION GRIPS PART
Z-OUT-L2.062	2" L X .062 WIRE- LEFT-TENSION GRIPS PART	Z-OUT-R2.091	2" L X .091 WIRE- RIGHT- TENSION GRIPS PART
Z-OUT-R2.076	2" L X .076 WIRE- RIGHT-TENSION GRIPS PART	Z-OUT-L2.091	2" L X .091 WIRE- LEFT- TENSION GRIPS PART

## Z-Diamond Wire® Hooks for Z-Bar-LT

DIAMOND WIRE HOOKS - Hooks really are stronger. Tests conducted on a load testing machine proved the DIAMOND WIRE hooks have almost double the load capacity of our standard spring steel "V" or "C" style hooks. Spring-steel square wire is formed on edge to create a hook with improved contact in electrostatic coating systems and to minimize hanging marks on the coated product. Packaged 500 pcs. per box.

45° or 90° orientation available as a custom order.

Approximate dimensions with hooks being bent on edge:

Square Wire	=	Width Across Diagonal Points
.062"	=	.088"
.076"	=	.110"



Part Number	Description	Part Number	Description
ZD-02062V	2"L X .062 SQUARE WIRE V-BOTTOM	ZD-02076V	2"L X .076 SQUARE WIRE V-BOTTOM
ZD-02062C	2"L X .062 SQUARE WIRE C-BOTTOM	ZD-02076C	2"L X .076 SQUARE WIRE C-BOTTOM
ZD-04062V	4"L X .062 SQUARE WIRE V-BOTTOM	ZD-04076V	4"L X .076 SQUARE WIRE V-BOTTOM
ZD-04062C	4"L X .062 SQUARE WIRE C-BOTTOM	ZD-04076C	4"L X .076 SQUARE WIRE C-BOTTOM

## Z-Step Jam Hooks

The Step Jams are modularly designed tension hooks that are able to remain in place on the crossbar while accommodating multiple hole sizes.

Part Number	Description
Z-STP-JAM-62-1	Holds parts ranging from 1/4" to 3/8"
Z-STP-JAM-76-1	Holds parts ranging from 1/2" to 3/4"

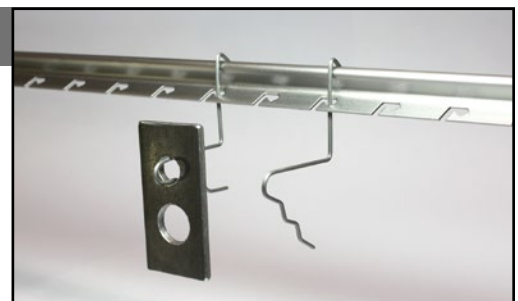

## Z-BAR-HV

Patent # 6,189,709

### The Revolutionary Hanging System

Z-BAR-HV (for heavier parts) Made from 15 gauge steel with on-center hook positions of 2". Accepts hooks made from 0.076 to 0.150 wire diameter spring steel. Lengths available in 30", 40" and 48". Custom lengths and hook position spacing available by special order. Packaged 25 pieces per box.

**Tips:** An almost infinite selection of hooks can be created to solve most hanging problems. Bars can be customized to fit any Mighty Hook Rack or any other existing racking system. These bars have the strength to function as a utility hang bar that fits under the conveyor line (accepting a variety of hooks and placement positions) or as free-hanging Z-BAR.

### Z-BAR-HV-No Ends

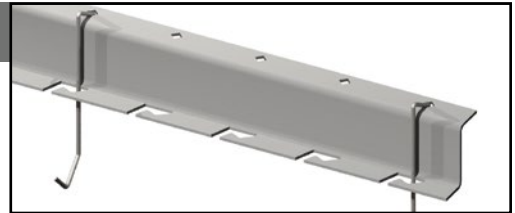

Part Number	Description
Z-BARHVY30	30" Z-BAR HEAVY-NO ENDS 15 GAUGE
Z-BARHVY40	40" Z-BAR HEAVY-NO ENDS 15 GAUGE
Z-BARHVY48	48" Z-BAR HEAVY-NO ENDS 15 GAUGE

### Z-BAR-HV-PP

Z-BAR-HV-PP - Designed for use on the POWDERPEG RACK on page 17. The 1/4" diameter wire peg-end slips in rack for quick change.

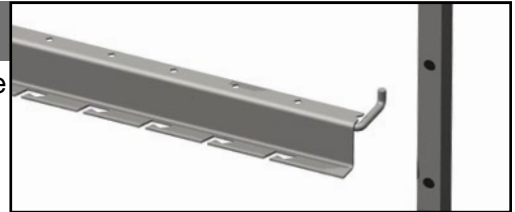

Part Number	Description
Z-BARHV-PP20	20" Z-BAR Adj. Crossbar- 5 Hook points on 2" Centers
Z-BARHV-PP25	25" Z-BAR Adj. Crossbar-10 Hook points on 2" Centers
Z-BARHV-PP30	30" Z-BAR Adj. Crossbar-15 Hook points on 2" Centers
Z-BARHV-PP40	40" Z-BAR Adj. Crossbar-20 Hook points on 2" Centers

### Z-BAR-HV-D

Z-BAR-HV-D - Diamond shaped wire form end allows hanging choices above and below the bar. Suspend from your line and ladder down using our MIGHTY HOOKS.

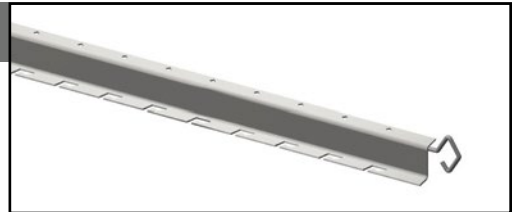

Part Number	Description
Z-BAR-HV-D30	Z-BAR HV 30"WITH DIAMOND ENDS MIG-WELDED
Z-BAR-HV-D40	Z-BAR HV 40"WITH DIAMOND ENDS MIG-WELDED
Z-BAR-HV-D48	Z-BAR HV 48"WITH DIAMOND ENDS MIG-WELDED

## Z-Hooks-HV

Revolutionary Hooks for the Revolutionary Hanging System

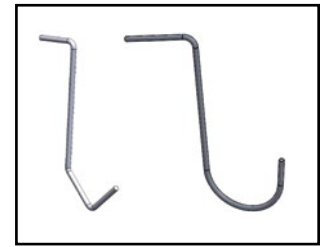
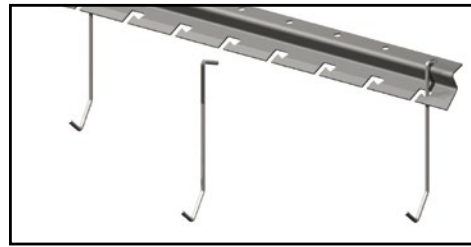

### Standard Z-Hooks for Z-BAR-HV

Z-HOOKS-HV - Designed for use in the Z-BAR-HV Crossbar. Hooks are stocked in 0.076", 0.105", 0.120" and 0.150" wire diameters, lengths from 4" to 6" (measured from bottom of Z-BAR-HV). Available in "V" shape bottom or a "C" shape bottom styles. Hooks in perpendicular, 90° and 45° styles can be made to order. Custom sizes and configurations can also be produced. Packaged 500 pcs. per box.

Part Number	Description
Z-407V-HVY	5-3/4" Long V-Bottom .076 wire hangs 4" after attaching to bar
Z-407C-HVY	5-3/4" Long C-Bottom .076 wire hangs 4" after attaching to bar
Z-4105V-HVY	5-3/4" Long V-Bottom .105 wire hangs 4" after attaching to bar
Z-4105C-HVY	5-3/4" Long C-Bottom .105 wire hangs 4" after attaching to bar
Z-4120V-HVY	5-3/4" Long V-Bottom .120 wire hangs 4" after attaching to bar
Z-4120C-HVY	5-3/4" Long C-Bottom .120 wire hangs 4" after attaching to bar
Z-4150V-HVY	5-3/4" Long V-Bottom .150 wire hangs 4" after attaching to bar
Z-4150C-HVY	5-3/4" Long C-Bottom .150 wire hangs 4" after attaching to bar
Z-607V-HVY	7-3/4" Long V-Bottom .076 wire hangs 6" after attaching to bar
Z-607C-HVY	7-3/4" Long C-Bottom .076 wire hangs 6" after attaching to bar
Z-6105V-HVY	7-3/4" Long V-Bottom .105 wire hangs 6" after attaching to bar
Z-6105C-HVY	7-3/4" Long C-Bottom .105 wire hangs 6" after attaching to bar
Z-6120V-HVY	7-3/4" Long V-Bottom .120 wire hangs 6" after attaching to bar
Z-6120C-HVY	7-3/4" Long C-Bottom .120 wire hangs 6" after attaching to bar
Z-6150V-HVY	7-3/4" Long V-Bottom .150 wire hangs 6" after attaching to bar
Z-6150C-HVY	7-3/4" Long C-Bottom .150 wire hangs 6" after attaching to bar

### Z-Diamond-HV for Z-BAR-HV

Z Diamond wire hooks are bent on edge for improved grounding and reduced hook marks. Available for Z-BAR-HV. Hooks in perpendicular, 90° and 45° styles can be made to order. Custom sizes and configurations can also be produced. Packaged 500 pcs. per box.

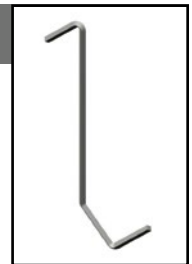

Part Number	Description	Part Number	Description
ZD-207-V-HVY	3.75"L 0.076" Sq. Wire V-Hook for Z-Bar-HV	ZD-407-V-HVY	5.75"L 0.076" Sq. Wire V-Hook for Z-Bar-HV
ZD-207-C-HVY	3.75"L 0.076" Sq. Wire C-Hook for Z-Bar-HV	ZD-407-C-HVY	5.75"L 0.076" Sq. Wire C-Hook for Z-Bar-HV
ZD-209-V-HVY	3.75"L 0.091" Sq. Wire V-Hook for Z-Bar-HV	ZD-409-V-HVY	5.75"L 0.091" Sq. Wire V-Hook for Z-Bar-HV
ZD-209-C-HVY	3.75"L 0.091" Sq. Wire C-Hook for Z-Bar-HV	ZD-409-C-HVY	5.75"L 0.091" Sq. Wire C-Hook for Z-Bar-HV
ZD-2105-V-HVY	3.75"L 0.105" Sq. Wire V-Hook for Z-Bar-HV	ZD-4105-V-HVY	5.75"L 0.105" Sq. Wire V-Hook for Z-Bar-HV
ZD-2105-C-HVY	3.75"L 0.105" Sq. Wire C-Hook for Z-Bar-HV	ZD-4105-C-HVY	5.75"L 0.105" Sq. Wire C-Hook for Z-Bar-HV
ZD-2120-V-HVY	3.75"L 0.120" Sq. Wire V-Hook for Z-Bar-HV	ZD-4120-V-HVY	5.75"L 0.120" Sq. Wire V-Hook for Z-Bar-HV
ZD-2120-C-HVY	3.75"L 0.120" Sq. Wire C-Hook for Z-Bar-HV	ZD-4120-C-HVY	5.75"L 0.120" Sq. Wire C-Hook for Z-Bar-HV

### Z-HV-OPN-JAM for Z-BAR-HV Crossbars

Z-OPN-JAM- These spring hooks spread to grip parts. Available for Z-BAR-HV. Made from hard drawn spring steel.

Part Number	Description
Z-HV-OPN-JAM.091	5"L-HVY Z-JAM OPN - your choice of hook spread and size .09
Z-HV-OPN-JAM.105	5"L-HVY Z-JAM OPN - your choice of hook spread and size .105
Z-HV-OPN-JAM.120	5"L-HVY Z-JAM OPN - your choice of hook spread and size .120
Z-HV-OPN-JAM.150	5"L-HVY Z-JAM OPN - your choice of hook spread and size .150

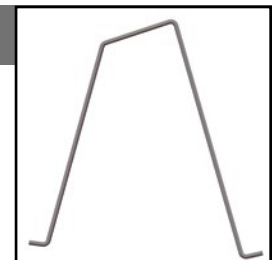

## TSR Crossbars™

Advanced design integrates an internal replacement locking hook system with lightweight, low-profile and extremely durable steel crossbars. Internal hook/crossbar contacts prevent coating from interfering with grounding characteristics. Internal grounding design means crossbars require only infrequent stripping. The flared outer edge crossbar design deflects coating from crossbar and incorporates internal hook contact points. Replacing and removing hooks is quick and easy. Our crossbar is also designed with closed ends to prevent coating from being drawn up inside the crossbar which often leads to grounding problems associated with inferior designs. Incorporated suspension holes are punched at 1" centers to provide unlimited suspension possibilities. Stocked in 30", 40" and 48" Lengths. Use with our spring steel TSR Hooks. **Packaged 25 pieces per box.**

**Tips:** Add powder peg ends, slip ends, stud ends or diamond ends to use with corresponding Mighty Hook rack products. We can also customize the bar to fit your existing hanging system, contact us to discuss your requirements.

### TSR-BAR-No Ends

Made from 18 gauge steel with on center hook positions of 1". Accepts hooks made from 0.031" to 0.076" wire spring steel. Bars are stocked in 30", 40" and 48" lengths. Custom lengths available upon request.



Part Number	Description
TSR-BAR-30-1	30"L x 1.125" H x 18 Ga. Crossbar w/ 1" spacing
TSR-BAR-40-1	40"L x 1.125" H x 18 Ga. Crossbar w/ 1" spacing
TSR-BAR-48-1	48"L x 1.125" H x 18 Ga. Crossbar w/ 1" spacing

### TSR-BAR-PP

Designed for use on the POWDER PEG RACK on page 17. The 1/4" diameter wire peg-end slips in rack for quick change. Custom lengths available upon request.



Part Number	Description
TSR-BAR-PP-30	30"L crossbar w/ Powderpeg ends
TSR-BAR-PP-40	40"L crossbar w/ Powderpeg ends

### TSR-BAR-D

Diamond shaped wire form end allows hanging choices above and below the bar. Suspend your line and daisy chain down using our Mighty Hooks.

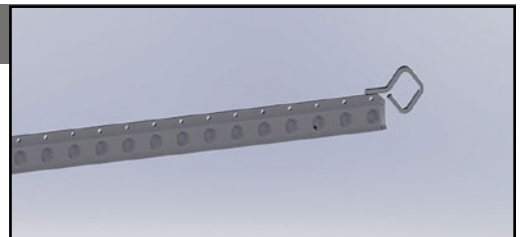

Part Number	Description
TSR-BAR-30-1-D	30" TSR-BAR with diamond ends
TSR-BAR-40-1-D	40" TSR-BAR with diamond ends
TSR-BAR-48-1-D	48" TSR-BAR with diamond ends

## TSR Hooks

TSR Hooks are designed to internally lock into our TSR-Bars to provide simple and secure hook replacement. Hooks attach to crossbar by simply squeezing the hook tab and stem together then inserting into the TSR-Bar. The hook profile locks into the bar once the hook is inserted and released.

TSR hooks are available in 2", 2.5", 3" and 4" lengths, 0.044", 0.062" and 0.076" hard drawn spring steel wire and in standard (facing forward, perpendicular to the crossbar) and 90° orientation (facing right, as shown to the right). Hooks are packaged 2000 pcs. per box.

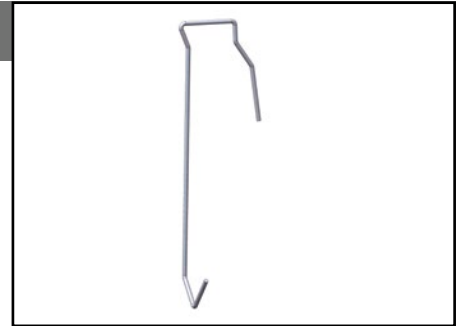

Stainless steel hooks and custom hook designs are also available with short lead times through our state of the art wire forming equipment. Contact us to discuss your application today.

**+ We have several TSR Hooks that require Minimum Order Quantity of 5 boxes.**

Part Number	Description	Part Number	Description
TSRHV-0204	2" x 0.044 TSR V-Hook+	TSRHV-02.506-90	2.5" x 0.062 - 90° TSR V-Hook
TSRHV-0204-90	2" x 0.044 - 90° TSR V-Hook	TSRHV-0306	3" x 0.062 TSR V-Hook
TSRHV-02.504	2.5" x 0.044 TSR V-Hook	TSRHV-0306-90	3" x 0.062 - 90° TSR V-Hook
TSRHV-02.504-90	2.5" x 0.044 - 90° TSR V-Hook	TSRHV-0406	4" x 0.062 TSR V-Hook+
TSRHV-0304	3" x 0.044 TSR V-Hook+	TSRHV-0406-90	4" x 0.062 - 90° TSR V-Hook
TSRHV-0304-90	3" x 0.044 - 90° TSR V-Hook	TSRHV-02.507	2.5" x 0.076 TSR V-Hook+
TSRHV-0404	4" x 0.044 TSR V-Hook+	TSRHV-02.507-90	2.5" x 0.076 - 90° TSR V-Hook
TSRHV-0404-90	4" x 0.044 - 90° TSR V-Hook	TSRHV-0307	3" x 0.076 TSR V-Hook
TSRHV-0206	2" x 0.062 TSR V-Hook+	TSRHV-0307-90	3" x 0.076 - 90° TSR V-Hook
TSRHV-0206-90	2" x 0.062 -90° TSR V-Hook	TSRHV-0407	4" x 0.076 TSR V-Hook
TSRHV-02.506	2.5" x 0.062 TSR V-Hook+	TSRHV-0407-90	4" x 0.076 - 90° TSR V-Hook

**Need a hook you don't see listed? - We can make them to order!**

## X-Bars and PP-X Bars

### The Strong, Multipurpose Hanging Solution

These crossbars combine stainless steel hooks and mild steel cross-arms. The box-like welded construction gives the crossbars superior strength and enables them to survive repeated stripping. Our stock components can be ordered with "V" or "C" bottom hooks welded perpendicular to the frame. Custom spacing or hooks turned 90° or 45° are available on special order. Packaged 25 pieces per box.

### X-Bar-W

X-BAR-W-LT (for lighter parts)

0.091" diameter stainless steel wire hooks welded to 3/16" mild steel cross-wires. Standard lengths are 20", 25", and 30" with spacing of 2" or 3". 0.076" diameter stainless steel hooks are also available by custom order. Other custom lengths, spacing and hook types are available. Call our experienced staff for assistance. Packaged 25 pieces per box.

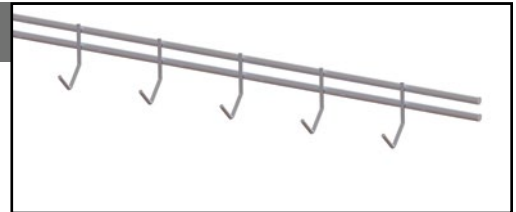

X-BAR-W-HV (for heavier parts)

0.120" diameter stainless steel wire hooks welded to 1/4" mild steel cross-wires. Standard lengths are 30" and 40" with spacing of 2", 3", or 5". 0.105" diameter stainless steel hooks are also available by custom order. Other custom lengths, spacing and hook types are available. Call our experienced staff for assistance. Packaged 25 pieces per box.

Part Number	Description	Part Number	Description
X-BAR-W 20-6	20" CROSSARM 6 HOOKS 3" SPACING LT.	X-BAR-W 30-6 HV	30" CROSSARM 6 HOOKS 5" SPACING HVY.
X-BAR-W 20-9	20" CROSSARM 9 HOOKS 2" SPACING LT.	X-BAR-W 30-10 HV	30" CROSSARM 10 HOOKS 3" SPACING HVY.
X-BAR-W 25-8	25" CROSSARM 8 HOOKS 3" SPACING LT.	X-BAR-W 30-14 HV	30" CROSSARM 14 HOOKS 2" SPACING HVY.
X-BAR-W 25-12	25" CROSSARM 12 HOOKS 2" SPACING LT.	X-BAR-W 40-8 HV	40" CROSSARM 8 HOOKS 5" SPACING HVY.
X-BAR-W 30-10	30" CROSSARM 10 HOOKS 3" SPACING LT.	X-BAR-W 40-13 HV	40" CROSSARM 13 HOOKS 3" SPACING HVY.
X-BAR-W 30-14	30" CROSSARM 14 HOOKS 2" SPACING LT.	X-BAR-W 40-19 HV	40" CROSSARM 19 HOOKS 2" SPACING HVY.

### PP-X Bar

### Never see a hole in your painting line again

Designed for use with our POWDERPEG RACK on page 17.

The Cantilever crossbars combine stainless steel hooks and mild steel cross-arms.

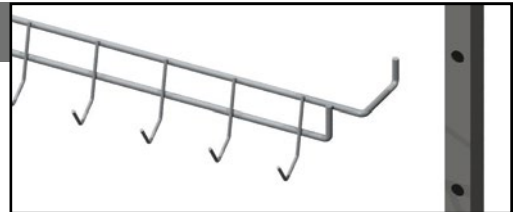

Part Number	Description
PP-X BAR 20-6	20" W welded hook crossarm - 6 Hooks on 3" Centers
PP-X BAR 20-9	20" W welded hook crossarm - 9 Hooks on 2" Centers
PP-X BAR 25-8	25" W welded hook crossarm - 8 Hooks on 3" Centers
PP-X BAR 25-12	25" W welded hook crossarm - 12 Hooks on 2" Centers
PP-X BAR 30-10	30" W welded hook crossarm - 10 Hooks on 3" Centers
PP-X BAR 30-14	30" W welded hook crossarm - 14 Hooks on 2" Centers
PP-X BAR 30-6 HV	30" W welded hook crossarm - 6 hvy hooks on 5" Centers
PP-X BAR 30-10 HV	30" W welded hook crossarm - 10 hvy hooks on 3" Centers
PP-X BAR 30-14 HV	30" W welded hook crossarm - 14 hvy hooks on 2" Centers
PP-X BAR 40-8 HV	40" W welded hook crossarm - 8 hvy hooks on 5" Centers
PP-X BAR 40-13 HV	40" W welded hook crossarm - 13 hvy hooks on 3" Centers
PP-X BAR 40-19 HV	40" W welded hook crossarm - 19 hvy hooks on 2" Centers

**X-Bar-D**

Diamond wire form welded to the ends of the X-Bar for versatility in hanging in multiple positions. Suspend from the line and ladder down using our MIGHTY HOOKS. The crossbars combine stainless steel hooks and mild steel crossarms. The box-like welded construction gives the crossbars superior strength and enables them to survive repeated stripping. Our stock components can be ordered with "V" or "C" bottom, hooks welded perpendicular to the frame.

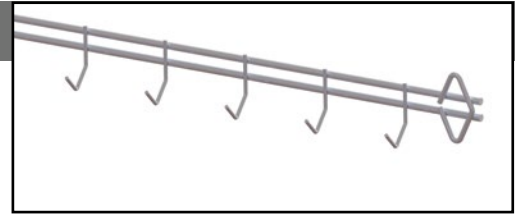

Part Number	Description
X-BAR-D 20-6	20" CROSSARM 6 HKS 3" SPACING LT. WITH DIAMOND ENDS
X-BAR-D 20-9	20" CROSSARM 9 HKS 2" SPACING LT. WITH DIAMOND ENDS
X-BAR-D 25-8	25" CROSSARM 8 HKS 3" SPACING LT. WITH DIAMOND ENDS
X-BAR-D 25-12	25" CROSSARM 12 HKS 2" SPACING LT. WITH DIAMOND ENDS
X-BAR-D-30-10	30" CROSSARM 10 HKS 3" SPACING LT. WITH DIAMOND ENDS
X-BAR-D 30-14	30" CROSSARM 14 HKS 2" SPACING LT. WITH DIAMOND ENDS
X-BAR-D 30-6 HV	30" CROSSARM 6 HKS 5" SPACING HVY WITH DIAMOND ENDS
X-BAR-D 30-10 HV	30" CROSSARM 10HKS 3" SPACING HVY WITH DIAMOND ENDS
X-BAR-D 30-14 HV	30" CROSSARM 14HKS 2" SPACING HVY WITH DIAMOND ENDS
X-BAR-D 40-8 HV	40" CROSSARM 8 HKS 5" SPACING HVY WITH DIAMOND ENDS
X-BAR-D 40-13 HV	40" CROSSARM 13HKS 3" SPACING HVY WITH DIAMOND ENDS
X-BAR-D 40-19 HV	40" CROSSARM 19HKS 2" SPACING HVY WITH DIAMOND ENDS

**Made to Order**

**Contact our engineers to discuss the specific requirements of your operation and we will assist you in designing and producing the proper crossbars for your application.**

## W Bars™

Innovative and advanced designed crossbars accept replaceable spring steel clips. Clips lock into position and can be easily removed and replaced for maximum versatility. For use in Powder Coating, Liquid/Wet and E-Coating applications. The spring tempered clips have excellent retention capability for holding parts that cannot be hung by traditional hooking methods, especially parts with lips but no holes and aluminum extrusion profiles. Bars are stocked with 2" hanging centers in 30", 40" and 48" lengths. Custom lengths and spacing available by special order. Packaged 25 pieces per box.

**Tips:** Add powder peg ends, slip ends, stud ends or diamond ends. We will also customize the bar to fit your existing hanging system. Contact us to discuss your requirements.

### W-BAR-No Ends

Made from 15 gauge steel with on center clip positions of 2". Accepts W-Clip shown below. Bars are stocked in 30", 40" and 48" lengths. Custom lengths available upon request.

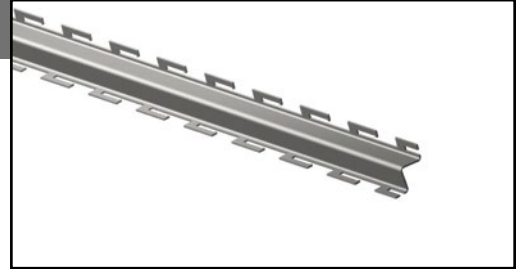

Part Number	Description
W-BAR-30-1	30"L crossbar w/ no ends
W-BAR-40-1	40"L crossbar w/ no ends
W-BAR-48-1	48"L crossbar w/ no ends

### W-BAR Clips

0.032" x 0.5" W C-1075 Spring Steel Clips for W-BARS. Stocked in 5.5" widths with straight or forked ends for smaller contact points. Custom widths and configurations available upon request.

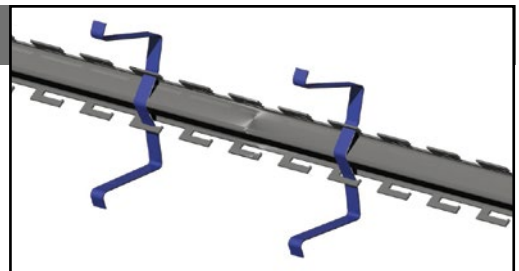

Part Number	Description	Box Quantity
W-55032	5.5" x 0.032" Spring Clip - Flat Ends, No Notch	100
W-55032-B	5.5" x 0.032" Spring Clip - Forked Notched Ends	100

### Custom W-BAR-PP

Designed to be used with our Powder Peg Rack on page 17. These crossbars use a 1/4" dia. wire peg end that slips into the rack for a quick change. W-BAR-PP is custom made to order. Contact our engineers to have them designed and produced for your application.

Made to order. Contact us for pricing.

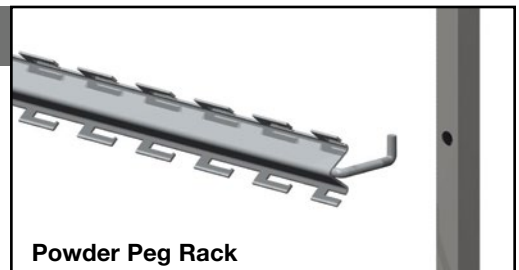

## Arrow Bars™

### The Strong, Unique Hanging Solution

New and unique, the Mighty Hook Arrow Bar™ is engineered to hang both lightweight and heavy products that cannot be held securely by conventional hook/hanging methods in powder coating, liquid coating, and e-coating applications. Durable and engineered with a low profile, the laser cut arrow design allows for hanging from a variety of contact areas. The angle design virtually eliminates tilting or swinging of the part during finishing and gravity essentially locks the product on. The Arrow Bar™ is designed with an alternating pattern that allows products to be held on both sides of the crossbar and can be customized to fit any existing racking system. Stocked in 3 lengths and designed with standard 2" alternate spacing for maximizing density, the Arrow Bar™ concept can also be custom manufactured for specific applications. Packaged 25 pieces per box.

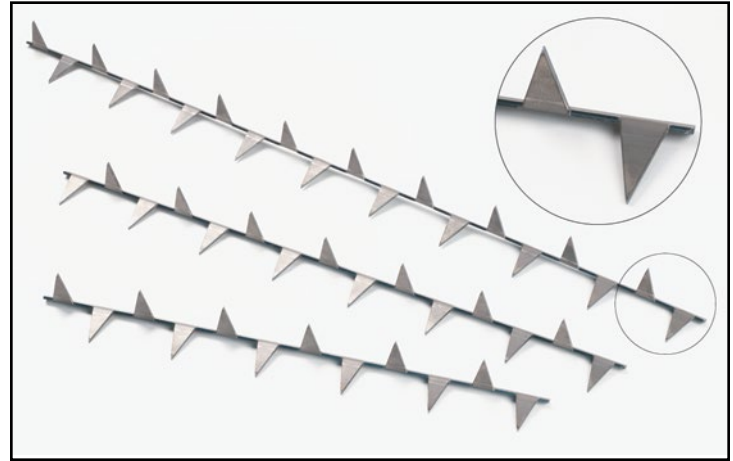

Our ARROW BARS can be used in many different ways. Contact our experienced staff to assist you in choosing the proper crossbar for your requirements.

### ARW-BAR-No Ends

Made from 10 gauge steel with 2" alternating spacing. Bars are stocked in 24", 30" and 40" lengths. Custom lengths and custom spacing available by special order.

Part Number	Description
ARW-24-12-1	24"W 12 point Arrow Head Crossbar
ARW-30-15-1	30"W 15 point Arrow Head Crossbar
ARW-40-20-1	40"W 20 point Arrow Head Crossbar

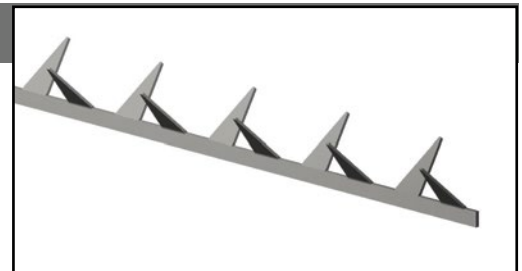

### Custom ARW-BAR-PP

Designed to be used with our Powder Peg Rack on page 17. These crossbars use a 1/4" dia. wire peg end that slips into the rack for a quick change. ARW-BAR-PP is custom made to order. Contact our engineers to have them designed and produced for your application.

Made to order. Contact us for pricing.

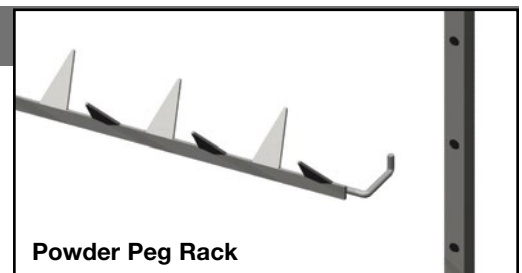

## Tube & Rod Crossbars

Peg Tube HL - Peg Ends are welded internally into the 3/8" dia., 18 ga. tube. SNAP HOOKS firmly grasp the tube and can be easily removed and replaced. Removing the hooks leaves a clean site for snapping on another hook.

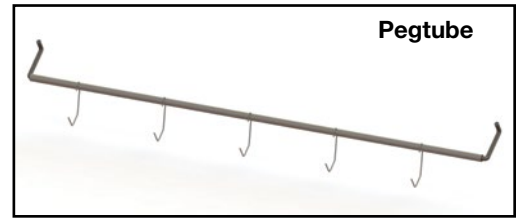

**Tips:** Use a combination of SNAP HOOKS to fit a 3/8" rod for a low cost, multiple positioning hanging solution. They grip parts firmly and will even fit into small holes. All are made from .044" or .062" stainless steel spring wire. See SNAP HOOKS to fit a 3/8" rod, pages 12 & 13. Packaged 25 pieces per box.

### HL Tubes

HL TUBES – 3/8" diameter, 18 gauge tube. SNAP HOOKS firmly grasp the tube and can be removed and replaced. Removing the hooks leaves a clean site for snapping on another hook. Engineered for frequent stripping and easy cleaning, the hollow tube design conducts and disperses heat minimizing distortion.



Part Number	Description
HL-20TUBE	3/8" X 20" HOLLOW 18 GAUGE TUBE (no ends)
HL-25TUBE	3/8" X 25" HOLLOW 18 GAUGE TUBE (no ends)
HL-30TUBE	3/8" X 30" HOLLOW 18 GAUGE TUBE (no ends)

### Pegtube-PP

Designed for use on the POWDERPEG RACK on page 17. The 1/4" diameter wire peg-end slips in rack for quick change. Stocked in 20", 25" and 30" lengths.

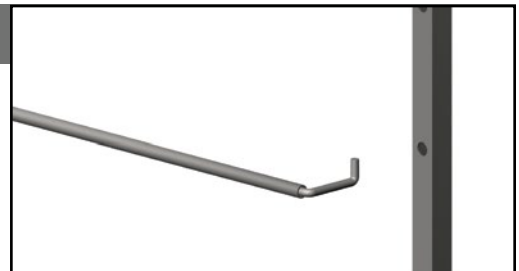

Part Number	Description
PEGTUBE-PP-HL-20	20" W x 3/8" Ø 18 Ga. Tube for Powderpeg Rack
PEGTUBE-PP-HL-25	25" W x 3/8" Ø 18 Ga. Tube for Powderpeg Rack
PEGTUBE-PP-HL-30	30" W x 3/8" Ø 18 Ga. Tube for Powderpeg Rack

### HL-D Tubes

HL-D hollow 3/8" hollow tubes are the same as HL Tubes, but with diamond ends welded on the tube to facilitate hanging. Suspend from the line and daisy-chain using our MIGHTY HOOKS.



Part Number	Description
HL-20D	3/8" X 20" HOLLOW 18 GAUGE TUBE W/DIAMOND ENDS
HL-25D	3/8" X 25" HOLLOW 18 GAUGE TUBE W/DIAMOND ENDS
HL-30D	3/8" X 30" HOLLOW 18 GAUGE TUBE W/DIAMOND ENDS

### Pegrod

Pegrod - Similar to peg tubes, the 1/4" solid rod provides a smaller profile when coating light weight or small parts. Designed exclusively for the POWDERPEG RACK. See Snap Hooks to fit a 1/4" rod.

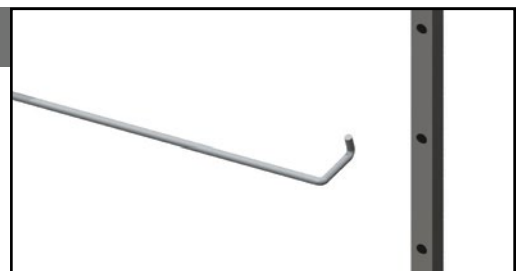

Part Number	Description
PEGROD20	20" W x 1/4" Ø Wire Rod for Powderpeg Rack
PEGROD25	25" W x 1/4" Ø Wire Rod for Powderpeg Rack
PEGROD30	30" W x 1/4" Ø Wire Rod for Powderpeg Rack

## Angle Pivot System™

### Increase your paint line capacity up to 50% with the Angle Pivot™ System

The patented Angle Pivot™ System levers against the slope of the track on inclines and declines to rotate your racks resulting in....

- Closer rack spacing...up to 50% increased capacity with inclines or declines of 45° or more
- Higher inclines/declines of up to 60° are possible, making your finishing line more compact
- With a Solid Wall of parts, your paint line efficiency is greatly increased
- More accurate spray gun-to-part spacing ensuring consistency and decreasing waste
- Can be used on any existing or new conveyor system
- Compatible with all Mighty Hook Rack Systems

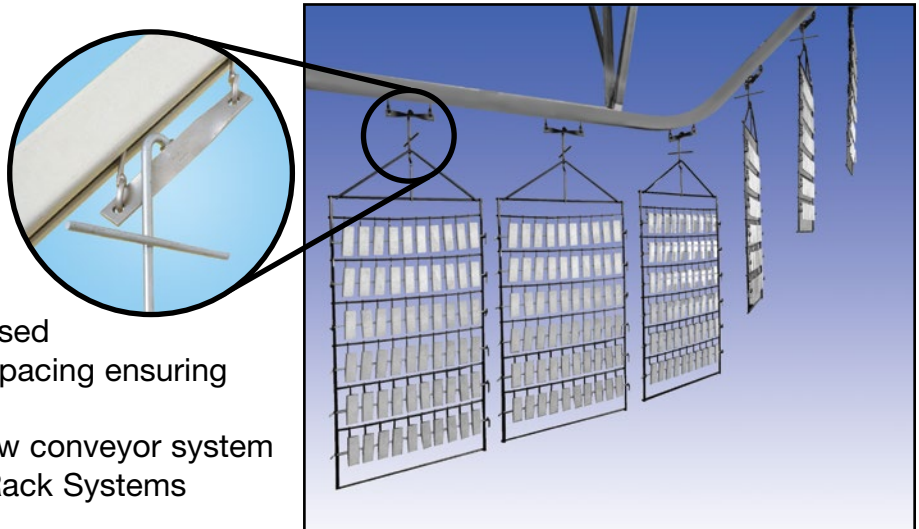

## Solid Wall Finishing

Solid Wall Finishing is achieved by simply closing up the gaps between racks by using the patented Angle Pivot™ System. This unique product attaches to your existing conveyor line to create closer rack spacing, creating a Solid Wall of racks...increasing paint or coating efficiency. It will work on inclines or declines of up to 60°, and adapts to any existing or new system. Racks automatically rotate up to 70° on inclines and declines, eliminating any contact.

Our engineers can provide the details on adapting the Angle Pivot™ System to your conveyor, and increase your finishing line efficiency for a fraction of new line costs. We also create custom racking and hooks that will complement the Angle Pivot™ System to provide a total solution for your unique finishing requirements.

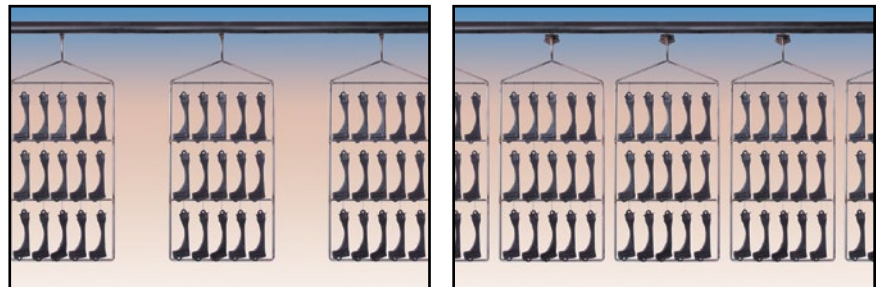

**BEFORE**

**AFTER**

## Custom Angle Pivot™ Rotators

Our engineers can provide the details on adapting these unique rotators to your conveyor system. Together with our custom racking and hooks they will provide the ultimate solution for your unique finishing requirements.

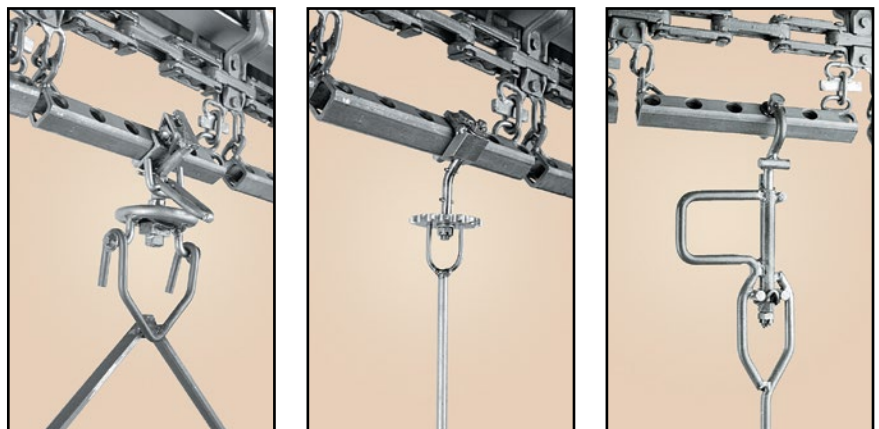

AP products are covered by US Patent # 5,000,309; 5,226,525; 5,253,742; 5,303,815; and 5,566,815 and others pending.

## Custom Hooks & Racking

We provide extensive custom solutions

Mighty Hook is the leader in the engineering and design of custom hanging and masking technologies. With over three decades of experience in designing solutions for the industrial coating industry coupled with hands-on experience in job shop coating operations, Mighty Hook understands the needs of the coating professional in the 21st century. Every day our engineers and dedicated staff work to solve our customers' complex coating requirements. It is our mission to be a partner to our customers and assist them in maximizing their coating operation in terms of productivity and profitability. We are known to our customers not as simply a product supplier, but a solutions provider. The following pages display examples of the custom capabilities we provide. Contact us to discuss how we can assist you in making your coating operation more efficient and profitable.



Advanced forming equipment capable of manufacturing hooks from 0.031" Ø to 1.00" Ø round or square wire.



Magazine-style rack cart designed for storage, material handling and off-line racking.



Integrated hook storage and burn-off cart. Top frame lifts off base and is placed directly on burn-off trolley.

## Custom Racking & Masking

We provide extensive custom solutions

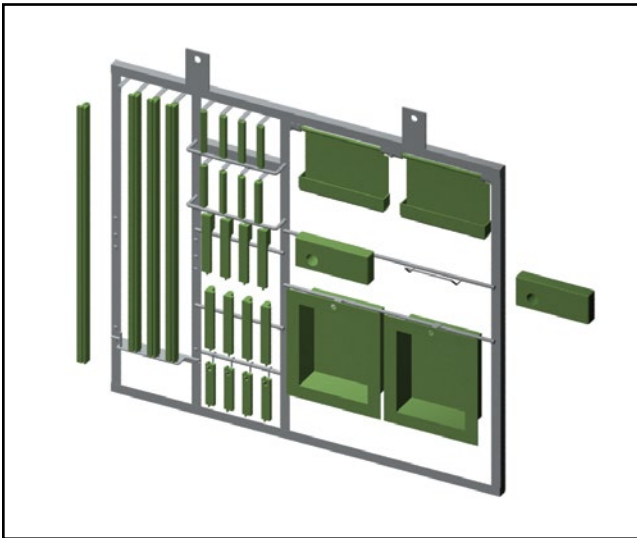

3-D model of a custom component rack design to hold part sets through coating to assembly.

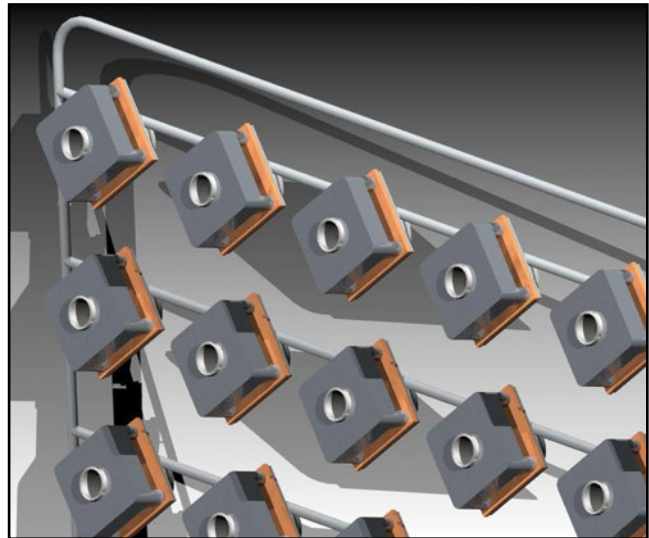

3-D model of integrated custom rack with silicone rubber masking feature for powder coating.



3-D model of conductive silicone custom masking for appliance knob allows part to be masked and hung from integrated tabs.

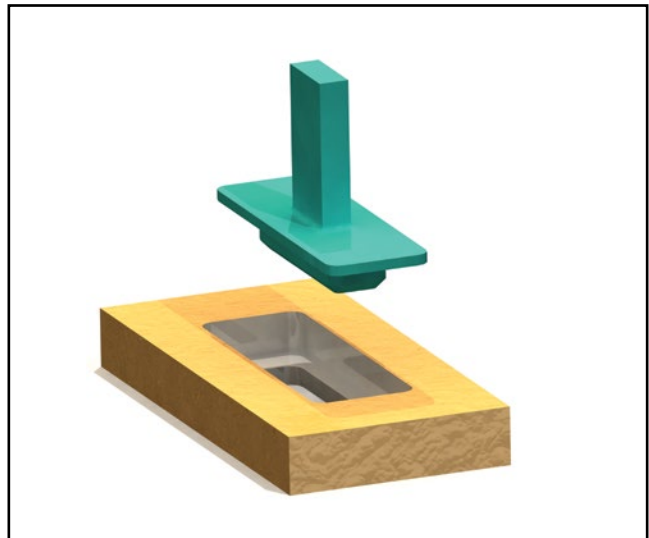

Custom masking plug with integrated handle for easier placement and removal.

## Custom Rack Design and Testing

We provide certified load testing

Mighty Hook is proud to introduce North America's first and only certified load testing machine engineered exclusively for testing our engineered and manufactured hangers, hooks and racks. The proprietary load testing station employs aircraft quality components and state of the art electronics to provide the capability of load testing up to 10,000 pounds of force. The unique design of the testing station gives Mighty Hook the capability of either single point or fully distributed load testing on hangers and racks of all types.

Our state of the art electronic load cell provides graphical data analysis of load stress during testing. All capturing and logging equipment is calibrated to ASTM and ISO standards (IO-CFR-21, O/IEC 17025, ISO 10012-1, MIL-STD 45662A and ASTM-E74). Load testing can be performed for working load limit (proof testing) with safety factor per ASME B30.20-2010, ASME BTH-1-2011 or your preferred safety weight load limit requirements. Testing can also be configured to provide failure mode analysis up to the testing station limit. Upon request, documentation and certification of weight load limits with testing data per required specifications may be provided.

With this new and exclusive capability, Mighty Hook also introduces a revolutionary concept for its customers: **SAFE REPLACEMENT**. Most coating hanger components are subject to extreme temperatures and temperature swings (i.e. curing and stripping temperatures between 250°F and 1500°F). With constant exposure to these temperatures the load bearing qualities of metal hanging hardware are gradually reduced. Until now, if a hook looked like it was starting to bend or a rack appeared to distort under any load, then it was time to replace. With our new testing capabilities, we can work with you to develop a hook, hanger or rack replacement program based upon actual load testing data collected to determine the optimal timeframe to replace your hanging hardware before it becomes unsafe for your workforce or fails and drops parts.

Our dedicated and service-oriented engineering staff is available to discuss your specific requirements at your convenience.

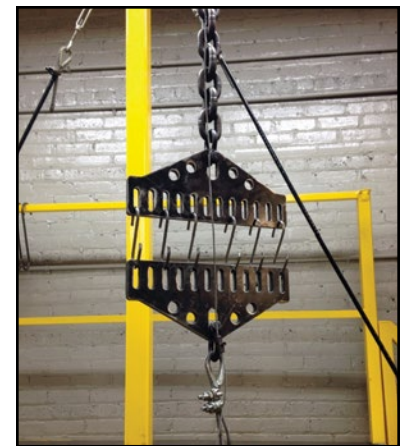

## Custom Rack Design and Testing

We provide extensive custom solutions

Mighty Hook's unmatched engineering team designs and develops hanging systems that maximize your coating system's capabilities by increasing part hanging density and improving first pass transfer efficiencies, which translate into lower operating costs and higher throughput. Our team goes through a multistage process to deliver the right solution for each individual customer.

Pictured to the right is a conveyor simulator built by our engineering team. Our customer was concerned that the inclines and declines of their soon-to-be installed conveyor system would cause certain parts to swing into each other. An abbreviated timeframe from conveyor and coating system completion to production made comprehensive rack testing difficult, so we built the pictured conveyor simulator. It was then used to develop a specific part hanging map and successfully implement an optimized balance between part distribution and coating quality.



Conveyor Simulator



A leading agricultural manufacturer looked to our team to develop a comprehensive hanging and material handling solution to address their manufacturing processes from fabrication through assembly. The rack design (pictured) allows for both modular and dedicated configuration. With a load capacity of 3000 lbs., the racks are strong enough to handle a fully loaded part set and be double hung to maximize the coating system window. The rack also incorporates proprietary crossbar attachment features that securely attach but are easy to remove, making the structural steel crossbar safe and easy to maneuver.

The frame was designed to seamlessly interface with the customer's existing caster base design, allowing the racks to be easily transported throughout their manufacturing process. The result is a rack design solution that starts in the fabricating department (where parts are initially hung), and remain on the racks through coating and are not removed until final assembly.

## Magnetic Discs

This is a new re-usable, high temperature silicone disc combined with a temperature magnet. The magnetic disc is used to mask ferrous products and can withstand 500°F (260°C). Its advanced design seals around the edges to ensure quality masking, and leaves no marks or residue. Unlike adhesive discs, these are re-usable, and easy to place and remove.

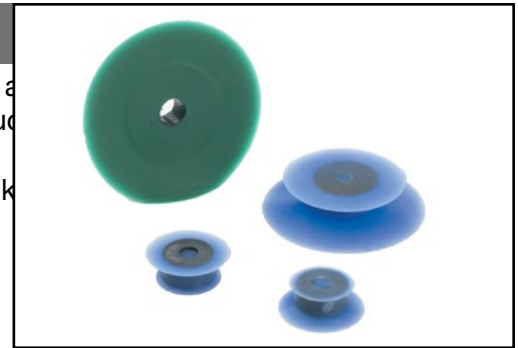

Part Number	Small Diameter IN.	Large Diameter IN.	Height IN.	Box Qty
SMP-100-75	0.750	1.000	0.234	100
SMP-200-150	1.500	2.000	0.437	50
SMP-238-194	1.937	2.375	0.437	50

## Vented Caps

The cap is designed with internal ridges to improve placement and removal and the lip around the cap also makes it easy to center. As a special feature the cap has a recessed area on the top which can be punctured. This design eliminates the common problem of vacuum creation, common with standard masking caps, during removal of the cap from the masked product.



Recommended for use in Powder Coating, Liquid Coating, E-Coating, Anodizing and Plating. The plug will withstand 600°F (315°C). The high-grade silicone product is re-usable, will not migrate, melt or harden. Please contact us to request a sample or to inquire about custom or other non-listed sizes.

Part Number	Inner Diameter		Length		Fits mm	Box Qty
	IN.	mm	IN.	mm		
GAP 04x20	0.126	3.2	0.787	20.0	M4	500
GAP 05X25	0.165	4.2	0.984	25.0	M5	500
GAP 05/50	0.165	4.2	1.969	50.0	M5	200
GAP 06X25	0.205	5.2	0.984	25.0	M6	500
GAP 06X50	0.205	5.2	1.969	50.0	M6	200
GAP 08X25	0.283	7.2	0.984	25.0	M8	500
GAP 08X50	0.283	7.2	1.969	50.0	M8	200
GAP 10X25	0.362	9.2	0.984	25.0	M10	200
GAP 10X50	0.362	9.2	1.969	50.0	M10	100
GAP 12X25	0.441	11.2	0.984	25.0	M12	200
GAP 12X50	0.441	11.2	1.969	50.0	M12	100
GAP 14X25	0.520	13.2	0.984	25.0	M14	200
GAP 14X50	0.520	13.2	1.969	50.0	M14	100
GAP 16X25	0.598	15.2	0.984	25.0	M16	100
GAP 16X50	0.598	15.2	1.969	50.0	M16	50
GAP 18X25	0.677	17.2	0.984	25.0	M18	50
GAP 18X50	0.677	17.2	1.969	50.0	M18	25
GAP 20X25	0.756	19.2	0.984	25.0	M20	50
GAP 20X50	0.756	19.2	1.969	50.0	M20	25

## Silicone Caps

The cap can be used to mask threaded and non-threaded studs or threaded and non-threaded holes. The silicone is flexible and will conform to irregular shapes. Recommended for use in Powder Coating, Liquid Coating, E-Coating, Anodizing and Plating.

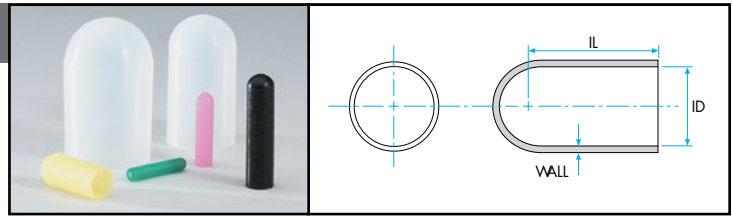

The cap will withstand 600° F (315° C). The high-grade silicone product is re-usable, will not migrate, melt or harden. Please contact us to request a sample or to inquire about custom or other non-listed sizes.

Part Number	Thread Size		ID IN.	Length / IL		Wall IN.	Box Qty.
	mm	UNC		IN.	IN.		
SCM-0020-050			0.020	0.500	0.030	1000	
SCM-0035-050			0.035	0.500	0.030	1000	
SCM-0040-075			0.040	0.750	0.045	1000	
SCM-0062-075			0.062	0.750	0.045	1000	
SCM-0070-100	M2	2-56	0.070	1.000	0.045	1000	
SCM-0080-075			0.080	0.750	0.060	1000	
SCM-0093-050			0.093	0.500	0.050	1000	
SCM-0100-100	M3	4-40	0.100	1.000	0.050	1000	
SCM-0109-075			0.109	0.750	0.050	1000	
SCM-0125-100		6-32,6-36	0.125	1.000	0.050	1000	
SCM-0140-100			0.140	1.000	0.060	1000	
SCM-0148-100	M4		0.148	1.000	0.050	1000	
SCM-0156-100		8-32,8-36	0.156	1.000	0.060	1000	
SCM-0172-100		10-24,10-32	0.172	1.000	0.060	1000	
SCM-0180-100	M5		0.180	1.000	0.060	1000	
SCM-0187-100			0.187	1.000	0.060	1000	
SCM-0218-100			0.218	1.000	0.060	500	
SCM-0223-100	M6		0.223	1.000	0.060	500	
SCM-0223-150	M6		0.223	1.500	0.060	500	
SCM-0234-100		1/4-20	0.234	1.000	0.060	500	
SCM-0250-100			0.250	1.000	0.060	500	
SCM-0281-100		5/6-18	0.281	1.000	0.060	500	
SCM-0295-150	M8		0.295	1.500	0.060	500	
SCM-0312-100			0.312	1.000	0.060	500	
SCM-0355-150		3/8-18	0.355	1.500	0.060	500	
SCM-0375-100	M10		0.375	1.000	0.060	500	
SCM-0375-150	M10		0.375	1.500	0.060	500	
SCM-0406-100			0.406	1.000	0.060	500	
SCM-0437-100			0.437	1.000	0.060	500	
SCM-0456-150	M12		0.456	1.500	0.050	500	
SCM-0468-100			0.468	1.000	0.060	500	
SCM-0480-150			0.480	1.500	0.060	500	
SCM-0500-150		1/2	0.500	1.500	0.060	500	
SCM-0535-150	M14		0.535	1.500	0.050	250	
SCM-0562-150	M15		0.562	1.500	0.060	250	
SCM-0600-150	M16		0.600	1.500	0.054	250	
SCM-0625-150			0.625	1.500	0.060	250	
SCM-0687-150			0.687	1.500	0.060	250	
SCM-0730-150	M19		0.730	1.500	0.060	250	
SCM-0750-150			0.750	1.500	0.060	250	
SCM-0780-150			0.780	1.500	0.060	250	
SCM-0812-150			0.812	1.500	0.060	250	
SCM-0875-150			0.875	1.500	0.060	250	
SCM-0937-150			0.937	1.500	0.060	250	
SCM-0970-150	M25		0.970	1.500	0.060	250	
SCM-1000-150			1.000	1.500	0.060	250	
SCM-1062-200			1.062	2.000	0.060	100	
SCM-1125-150			1.125	1.500	0.060	100	
SCM-1187-150			1.187	1.500	0.060	100	
SCM-1250-150			1.250	1.500	0.060	100	
SCM-1350-175			1.350	1.750	0.060	100	
SCM-1500-175			1.500	1.750	0.060	100	
SCM-1625-200			1.625	2.000	0.060	100	
SCM-1750-200			1.750	2.000	0.060	100	
SCM-1875-200			1.875	2.000	0.060	100	
SCM-2000-200			2.000	2.000	0.060	100	

## EPDM Caps

The cap can be used to mask threaded and non-threaded studs or threaded and non-threaded holes. The EPDM is flexible and will conform to irregular shapes.

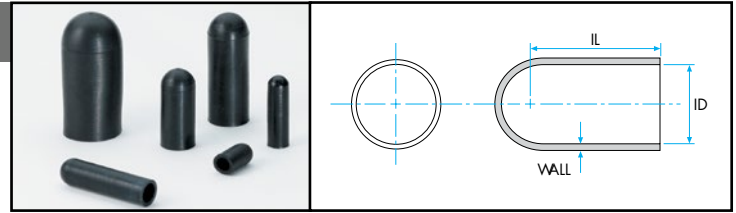

Recommended for use in Powder Coating, Liquid Coating, E-Coating, Anodizing and Plating. The cap will withstand 450°F (233°C). The high-grade EPDM rubber product is re-usable, will not migrate, melt or harden. Excellent chemical resistance. Stock color on all caps is black. Please contact us to request a sample or to inquire about custom or other non-listed sizes.

Part Number	Thread Size		ID IN.	Length / IL IN.	Wall IN.	Box Qty.
	mm	UNC				
ECM-0020-050			0.020	0.500	0.030	1000
ECM-0035-050			0.035	0.500	0.030	1000
ECM-0040-075			0.040	0.750	0.045	1000
ECM-0062-075			0.062	0.750	0.045	1000
ECM-0070-100	M2	2-56	0.070	1.000	0.045	1000
ECM-0080-075			0.080	0.750	0.060	1000
ECM-0093-050			0.093	0.500	0.050	1000
ECM-0100-100	M3	4-40	0.100	1.000	0.050	1000
ECM-0109-075			0.109	0.750	0.050	1000
ECM-0125-100		6-32,6-36	0.125	1.000	0.050	1000
ECM-0140-100			0.140	1.000	0.060	1000
ECM-0148-100	M4		0.148	1.000	0.050	1000
ECM-0156-100		8-32,8-36	0.156	1.000	0.060	1000
ECM-0172-100		10-24,10-32	0.172	1.000	0.060	1000
ECM-0180-100	M5		0.180	1.000	0.060	1000
ECM-0187-100			0.187	1.000	0.060	1000
ECM-0218-100			0.218	1.000	0.060	500
ECM-0223-100	M6		0.223	1.000	0.060	500
ECM-0223-150	M6		0.223	1.500	0.060	500
ECM-0234-100		1/4-20	0.234	1.000	0.060	500
ECM-0250-100			0.250	1.000	0.060	500
ECM-0281-100		5/6-18	0.281	1.000	0.060	500
ECM-0295-150	M8		0.295	1.500	0.060	500
ECM-0312-100			0.312	1.000	0.060	500
ECM-0355-150		3/8-18	0.355	1.500	0.060	500
ECM-0375-100	M10		0.375	1.000	0.060	500
ECM-0375-150	M10		0.375	1.500	0.060	500
ECM-0406-100			0.406	1.000	0.060	500
ECM-0437-100			0.437	1.000	0.060	500
ECM-0456-150	M12		0.456	1.500	0.050	500
ECM-0468-100			0.468	1.000	0.060	500
ECM-0480-150			0.480	1.500	0.060	500
ECM-0500-150		1/2	0.500	1.500	0.060	500
ECM-0535-150	M14		0.535	1.500	0.050	250
ECM-0562-150	M15		0.562	1.500	0.060	250
ECM-0600-150	M16		0.600	1.500	0.054	250
ECM-0625-150			0.625	1.500	0.060	250
ECM-0687-150			0.687	1.500	0.060	250
ECM-0730-150	M19		0.730	1.500	0.060	250
ECM-0750-150			0.750	1.500	0.060	250
ECM-0780-150			0.780	1.500	0.060	250
ECM-0812-150			0.812	1.500	0.060	250
ECM-0875-150			0.875	1.500	0.060	250
ECM-0937-150			0.937	1.500	0.060	250
ECM-0970-150	M25		0.970	1.500	0.060	250
ECM-1000-150			1.000	1.500	0.060	250
ECM-1062-200			1.062	2.000	0.060	100
ECM-1125-150			1.125	1.500	0.060	100
ECM-1187-150			1.187	1.500	0.060	100
ECM-1250-150			1.250	1.500	0.060	100
ECM-1350-175			1.350	1.750	0.060	100
ECM-1500-175			1.500	1.750	0.060	100
ECM-1625-200			1.625	2.000	0.060	100
ECM-1750-200			1.750	2.000	0.060	100
ECM-1875-200			1.875	2.000	0.060	100
ECM-2000-200			2.000	2.000	0.060	100

## Silicone Cone Caps

The cap can be used to mask threaded and non-threaded studs or threaded and non-threaded holes. The silicone is flexible and will conform to irregular shapes.

Recommended for use in Powder Coating, Liquid and Plating. The cap will withstand 600° F (315°

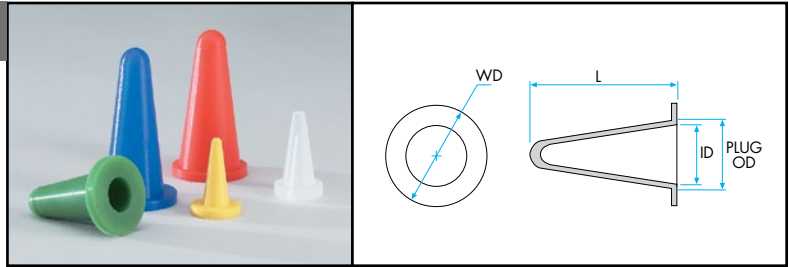

C). The high-grade silicone product is re-usable, will not migrate, melt or harden. Please contact us to request a sample or to inquire about custom or other non-listed sizes.

Part Number	Washer Diameter (WD)		Plug OD		ID		Length		Box Qty.
	IN.	mm	IN.	mm	IN.	mm	IN.	mm	
CCM-0250	0.500	12.7	0.250	6.4	0.130	3.3	0.906	23.0	500
CCM-0316	0.500	12.7	0.316	8.0	0.216	5.5	1.000	25.4	500
CCM-0335	0.625	15.9	0.335	8.5	0.177	4.5	1.000	25.4	500
CCM-0394	0.650	16.5	0.394	10.0	0.197	5.0	1.102	28.0	500
CCM-0400	0.635	16.1	0.400	10.2	0.230	5.8	1.100	27.9	250
CCM-0551	0.750	19.1	0.551	14.0	0.315	8.0	1.417	36.0	250
CCM-0689	0.980	24.9	0.689	17.5	0.453	11.5	1.500	38.1	250
CCM-0767	1.100	27.9	0.767	19.5	0.532	13.5	2.009	51.0	100
CCM-0819	1.000	25.4	0.819	20.8	0.583	14.8	1.929	49.0	100
CCM-0866	1.220	31.0	0.866	22.0	0.630	16.0	2.087	53.0	100

## Washer Caps

Multipurpose cap designed for masking the grounding area around studs and holes. Fits over threaded studs and tube ends. Also use as a plug to mask internal surfaces.

Recommended for use in Powder Coating, Liquid Coating, E-Coating, Anodizing and Plating. The cap will withstand 600° F (315° C). The high-grade silicone product is re-usable, will not migrate, melt or harden. Please contact us to request a sample or to inquire about custom or other non-listed sizes.



Part Number	ID (IN.)	Washer OD (IN.)	Length (IN.)	Box Qty.
SWC-0106-047	0.106	0.472	1.000	500
SWC-0125-050	0.125	0.500	1.000	500
SWC-0140-050	0.140	0.500	1.000	500
SWC-0146-047	0.146	0.472	1.000	500
SWC-0156-050	0.156	0.500	1.000	500
SWC-0172-050	0.172	0.500	1.000	500
SWC-0180-060	0.180	0.600	1.000	500
SWC-0220-059	0.220	0.590	1.000	500
SWC-0220-079	0.220	0.787	1.000	500
SWC-0240-050	0.240	0.500	1.000	250
SWC-0295-070	0.295	0.700	1.000	250
SWC-0300-068	0.300	0.675	1.000	250
SWC-0375-083	0.375	0.825	1.500	250
SWC-0453-098	0.453	0.984	1.500	250
SWC-0460-070	0.460	0.700	1.000	250
SWC-0500-100	0.500	1.000	1.000	250
SWC-0615-118	0.615	1.180	1.500	250
SWC-0780-148	0.780	1.475	1.500	250

## Plugs

Mighty Hook offers an extensive line of stock masking plugs for your coating requirements. If you need help with selecting styles or sizes please contact our experienced staff to discuss your requirements. We also offer custom molded and die cut masking manufacturing to solve even the most complex masking problems. Please call us to discuss your application.

### Silicone Tapered Plugs

The plug can be used to mask threaded and non-threaded holes. The silicone is flexible and will provide good sealing capabilities.

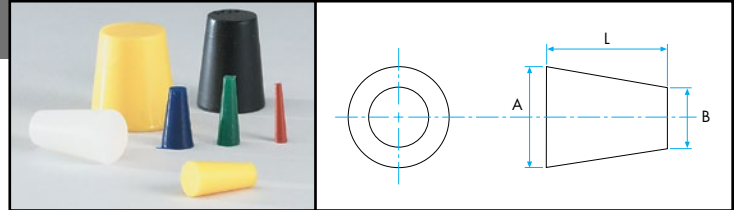

Recommended for use in Powder Coating, Liquid and Plating. The plug will withstand 600°F (315°C). The high-grade silicone product is re-usable, will not migrate, melt or harden. Please contact us to request a sample or to inquire about custom or other non-listed sizes.

Coating, E-Coating, Anodizing

Part Number	A		B		Length / L		Box Qty.
	IN.	mm	IN.	mm	IN.	mm	
TPM-0062-0625	0.062	1.6	0.016	0.4	0.625	15.9	1000
TPM-0078-0750	0.078	2.0	0.020	0.5	0.750	19.1	1000
TPM-0125-0625A	0.125	2.5	0.031	0.8	0.625	15.9	1000
TPM-0125-0625B	0.125	2.5	0.062	1.6	0.625	15.9	1000
TPM-0187-0625	0.187	4.7	0.062	1.6	0.625	15.9	1000
TPM-0187-0750	0.187	4.7	0.062	1.6	0.750	19.1	1000
TPM-0200-0750	0.200	5.1	0.062	1.6	0.750	19.1	1000
TPM-0250-0750	0.250	6.4	0.125	3.2	0.750	19.1	1000
TPM-0250-1000	0.250	6.4	0.125	3.2	1.000	25.4	1000
TPM-0343-0625	0.343	8.7	0.187	4.7	0.625	15.9	1000
TPM-0343-1000	0.343	8.7	0.187	4.7	1.000	25.4	1000
TPM-0375-0750	0.375	9.5	0.250	6.4	0.750	19.1	500
TPM-0437-1000	0.437	11.1	0.250	6.4	1.000	25.4	500
TPM-0472-0748	0.472	12.0	0.354	9.0	0.748	19.0	500
TPM-0500-1000	0.500	12.7	0.312	7.9	1.000	25.4	250
TPM-0590-1000	0.590	15.0	0.393	10.0	1.000	25.4	250
TPM-0625-0813	0.625	15.9	0.437	11.1	0.813	20.7	250
TPM-0669-1000	0.669	17.0	0.510	13.0	1.000	25.4	250
TPM-0748-1000	0.748	19.0	0.550	14.0	1.000	25.4	250
TPM-0787-1000	0.787	20.0	0.630	16.0	1.000	25.4	100
TPM-0938-1000	0.938	23.8	0.708	18.0	1.000	25.4	100
TPM-0945-0750	0.945	24.0	0.750	19.0	0.750	19.1	100
TPM-1024-1000	1.024	26.0	0.787	20.0	1.000	25.4	100

**Note:** Our larger plugs are manufactured with a "Hollow Design", see page 48. These Hollow Plugs have the same durability and strength as our solid plugs use less material and are more cost effective. If you require a Solid Plug in a Hollow Plug size, please contact us.

**Want to be certain that the parts you want are always available when you need them?  
Place a blanket order with us and we will produce and ship those parts to your schedule. Contact us for details.**

## Hollow Plugs

The stopper's hollow design reduces material cost and weight making this product an economical alternative to solid tapered stoppers. We carry them in a large variety of sizes to mask any variety of products. The flexible design leads to improved sealing both threaded and non-threaded holes.

Recommended for use in Powder Coating, Liquid Coating, E-Coating, Anodizing and Plating. The plug will withstand 600° F (315° C). The high-grade silicone product is re-usable, will not migrate, melt harden. Please contact us to request a sample or to inquire about custom or other non-listed sizes.

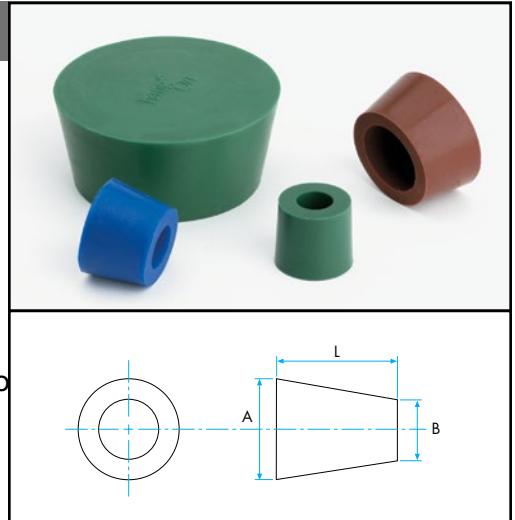

Part Number	A		B		Length / L		Box Qty.
	IN.	mm	IN.	mm	IN.	mm	
THP-1063	1.063	27.00	0.906	23.01	1.000	25.40	100
THP-1100	1.100	27.94	0.945	24.00	1.000	25.40	100
THP-1181	1.181	30.00	1.094	27.79	1.000	25.40	100
THP-1260	1.260	32.00	1.031	26.19	1.000	25.40	100
THP-1338	1.338	33.99	1.063	27.00	1.000	25.40	100
THP-1438	1.438	36.53	1.188	30.18	1.000	25.40	100
THP-1456	1.456	36.98	1.180	29.97	1.000	25.40	100
THP-1535	1.535	38.99	1.220	30.99	1.000	25.40	50
THP-1614	1.614	41.00	1.300	33.02	1.000	25.40	50
THP-1625	1.625	41.28	1.313	33.35	1.000	25.40	50
THP-1693	1.693	43.00	1.417	35.99	1.000	25.40	50
THP-1750	1.750	44.45	1.469	37.31	1.000	25.40	50
THP-1772	1.772	45.01	1.457	37.01	1.000	25.40	50
THP-1810	1.810	45.97	1.496	38.00	1.000	25.40	50
THP-1968	1.968	49.99	1.653	41.99	1.000	25.40	50
THP-2086	2.086	52.98	1.770	44.96	1.000	25.40	25
THP-2203	2.203	55.96	1.875	47.63	1.000	25.40	25
THP-2469	2.469	62.71	1.969	50.10	1.000	25.40	25
THP-2480	2.480	62.99	1.968	49.99	1.000	25.40	25
THP-2500	2.500	63.50	2.125	53.98	1.000	25.40	25
THP-2520	2.520	64.01	2.125	53.98	1.000	25.40	25
THP-2677	2.677	68.00	2.283	57.99	1.000	25.40	25
THP-2688	2.688	68.28	2.281	57.94	1.000	25.40	25
THP-2953	2.953	75.01	2.438	61.93	1.000	25.40	25
THP-3010	3.010	76.45	2.860	72.64	1.000	25.40	25
THP-3543	3.543	88.99	2.953	75.01	1.000	25.40	25
THP-4000	4.000	101.60	3.250	82.55	1.500	38.10	10
THP-5000	5.000	127.00	3.500	88.90	2.000	50.80	5

## EPDM Tapered Plugs

The plug can be used to mask threaded and non-threaded holes. The EPDM is flexible and will provide good sealing capabilities.

Recommended for use in Powder Coating, Anodizing and Plating. The plug will The high-grade EPDM rubber product is re-usable, will not migrate, melt or harden. Excellent chemical resistance. Stock color for Plugs is black. Please contact us to request a sample or to inquire about custom or other non-listed sizes.

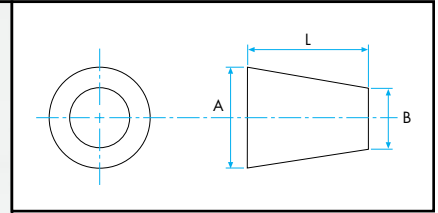

Liquid Coating, E-Coating, withstand 450°F (233°C).

Part Number	A		B		Length		Box Qty.
	IN.	mm	IN.	mm	IN.	mm	
ETPM-0062-0625	0.062	1.6	0.016	0.4	0.625	15.9	1000
ETPM-0078-0750	0.078	2.0	0.020	0.5	0.750	19.1	1000
ETPM-0125-0625	0.125	3.2	0.062	1.6	0.625	15.9	1000
ETPM-0187-0625	0.187	4.7	0.062	1.6	0.625	15.9	1000
ETPM-0187-0750	0.187	4.7	0.062	1.6	0.750	19.1	1000
ETPM-0200-0750	0.200	5.1	0.062	1.6	0.750	19.1	1000
ETPM-0250-0750	0.250	6.4	0.125	3.2	0.750	19.1	1000
ETPM-0250-1000	0.250	6.4	0.125	3.2	1.000	25.4	1000
ETPM-0343-0625	0.343	8.7	0.187	4.7	0.625	15.9	1000
ETPM-0343-1000	0.343	8.7	0.187	4.7	1.000	25.4	1000
ETPM-0375-0750	0.375	9.5	0.250	6.4	0.750	19.1	500
ETPM-0437-1000	0.437	11.1	0.250	6.4	1.000	25.4	500
ETPM-0472-0748	0.472	12.0	0.354	9.0	0.748	19.0	500
ETPM-0500-1000	0.500	12.7	0.312	7.9	1.000	25.4	250
ETPM-0590-1000	0.590	15.0	0.393	10.0	1.000	25.4	250
ETPM-0625-0813	0.625	15.9	0.437	11.1	0.813	20.7	250
ETPM-0669-1000	0.669	17.0	0.510	13.0	1.000	25.4	250
ETPM-0748-1000	0.748	19.0	0.550	14.0	1.000	25.4	250
ETPM-0787-1000	0.787	20.0	0.630	16.0	1.000	25.4	100
ETPM-0938-1000	0.938	23.8	0.708	18.0	1.000	25.4	100
ETPM-0945-0750	0.945	24.0	0.750	19.0	0.750	19.1	100
ETPM-1024-1000	1.024	26.0	0.787	20.0	1.000	25.4	100
ETPM-1063-1000	1.063	27.0	0.905	23.0	1.000	25.4	100
ETPM-1102-1000	1.102	28.0	0.945	24.0	1.000	25.4	100
ETPM-1260-1000	1.260	32.0	1.024	26.0	1.000	25.4	100
ETPM-1338-1000	1.338	34.0	1.063	27.0	1.000	25.4	100
ETPM-1456-1000	1.456	37.0	1.180	30.0	1.000	25.4	100
ETPM-1535-1000	1.535	39.0	1.220	31.0	1.000	25.4	50
ETPM-1614-1000	1.614	41.0	1.300	33.0	1.000	25.4	50
ETPM-1693-1000	1.693	43.0	1.417	36.0	1.000	25.4	50
ETPM-1772-1000	1.772	45.0	1.457	37.0	1.000	25.4	50
ETPM-1810-1000	1.810	46.0	1.496	38.0	1.000	25.4	50
ETPM-1968-1000	1.968	50.0	1.653	42.0	1.000	25.4	50
ETPM-2086-1000	2.086	53.0	1.770	45.0	1.000	25.4	25
ETPM-2205-1000	2.205	56.0	1.890	48.0	1.000	25.4	25
ETPM-2480-1000	2.480	63.0	1.968	50.0	1.000	25.4	25
ETPM-2520-1000	2.520	64.0	2.125	54.0	1.000	25.4	25
ETPM-2677-1000	2.677	68.0	2.283	58.0	1.000	25.4	25
ETPM-2953-1337	2.953	75.0	2.440	62.0	1.337	35.0	25
ETPM-3543-1535	3.543	90.0	2.953	75.0	1.535	39.0	10
ETPM-4055-1535	4.055	103.0	3.267	83.0	1.535	39.0	10
ETPM-5000-1968	5.000	127.0	3.543	90.0	1.968	50.0	5

## Conical Pull Plug with Tab

Push the conical plug into the thread so that the surface of the plug is at the level of the surrounding surface. This eliminates the forming of paint ridges when the item is being unmasked.

Recommended for use in Powder Coating, Liquid Coating, E-Coating, Anodizing and Plating. The plug will withstand 600° F (315° C). The high-grade silicone product is re-usable, will not migrate, melt or harden. Please contact us to request a sample or to inquire about custom or other non-listed sizes.



Part Number	Color	Major Dia.		Fit Dia.		Length		Box Qty.
		IN.	mm	mm	mm	IN.	mm	
GKS 03	Pink	0.110	3	M3	0.118	3.0	1000	
GKS 04	White	0.142	4	M4	0.157	4.0	1000	
GKS 05	Green	0.181	5	M5	0.197	5.0	1000	
GKS 06	Blue	0.217	6	M6	0.236	6.0	1000	
GKS 08	Yellow	0.291	7	M8	0.315	8.0	1000	
GKS 10	Rusty	0.358	9	M10	0.394	10.0	1000	
GKS 12	Red	0.425	11	M12	0.394	10.0	1000	

## Multi Use Conical Stoppers

The Conical Stopper can be used in various situations. The flexible design makes it perfect as a tube insert or for masking a hole or around an irregular hole. The conical part is perfect for metric threads. The hollow design makes this plug very flexible. It was also designed for quick and simple application and removal.

Recommended for use in Powder Coating, Liquid Coating, E-Coating, Anodizing and Plating. The plug will withstand 600° F (315° C). The high-grade silicone product is re-usable, will not migrate, melt or harden. Please contact us to request a sample or to inquire about custom or other non-listed sizes.



Part Number	Color	Major Dia.		Minor Dia.		Fit Dia.	Length		Box Qty.
		IN.	mm	IN.	mm		IN.	mm	
GKM 08	Yellow	0.287	7	0.157	4	M8	0.790	20.0	1000
GKM 10	Rusty	0.358	9	0.177	5	M10	0.790	20.0	1000
GKM 12	Red	0.425	11	0.236	6	M12	0.790	20.0	500
GKM 14	Blue	0.492	13	0.315	8	M14	1.000	25.4	500
GKM 16	Green	0.570	15	0.413	11	M16	1.000	25.4	500
GKM 20	Black	0.709	18	0.511	13	M20	1.000	25.4	200
GKM 22	Yellow	0.787	20	0.551	14	M22	1.000	25.4	200

## Metric Hollow Stoppers

The cylindrical stopper is designed with a flange to protect the thread entrance. Hollow design allows for flexibility and easy insertion and removal. Tapered leading diameter aids in inserting into threaded hole.

Recommended for use in Powder Coating, Liquid Coating, E-Coating, Anodizing and Plating. The stopper will withstand 600°F (315°C). The high-grade silicone product is re-usable, will not migrate, melt or harden. Please contact us to request a samples or non-listed sizes.



Part Number	Color	Fit Dia.		Length		Box Qty.
		mm	IN.	mm	IN.	
GGM 05	Green	M5	0.236	6.0		500
GGM 06	Blue	M6	0.278	7.1		500
GGM 08	Yellow	M8	0.382	9.7		500
GGM 10	Rusty	M10	0.484	12.3		500
GGM 12	Red	M12	0.579	14.7		250
GGM 16	Green	M16	0.787	20.0		250

## Double Washer Pull Plugs

Unparallel design and performance plug for masking welding nuts, press nuts and similar products. When fitted through the nut, the washer shape grips against the entrance thread on both sides providing a perfect masking of the threads.

Recommended for use in Powder Coating, Liquid Coating, E-Coating, Anodizing and Plating. The plug will withstand 600°F (315°C). The high-grade silicone product is re-usable, will not migrate, melt or harden. Please contact us to request a sample or to inquire about custom or other non-listed sizes.



Part Number	Color	Fit Dia.		Box Qty.
		mm	IN.	
GDF 04	White	M4		1000
GDF 05	Green	M5		1000
GDF 06	Blue	M6		1000
GDF 08	Yellow	M8		1000
GDF 10	Rusty	M10		1000
GDF 12	Red	M12		500
GDF 14	Blue	M14		200
GDF 16	Green	M16		200
GDF 20	Black	M20		200

## Flanged Pull Plugs

This pull plug is designed with a knob on the shaft to improve grip. The rear flange will act as a mask stop or can be used to mask the entrance thread. All sizes available in two lengths. The plug is designed for metric threads.

Recommended for use in Powder Coating, Liquid Coating, E-Coating, Anodizing and Plating. The plug will withstand 600°F (315°C). The high-grade silicone product is re-usable, will not migrate, melt or harden. Please contact us to request a sample or to inquire about custom or other non-listed sizes.



Part Number	Color	Major Dia.		Minor Dia.		Body Length		Stem Length		Fits	Box Qty.
		IN.	mm	IN.	mm	IN.	mm	IN.	mm		
GDM 3.6x15	White	0.142	3.6	0.083	2.1	0.590	15.0	0.984	25.0	M4	1000
GDM 3.6X30	White	0.142	3.6	0.083	2.1	1.181	30.0	1.575	40.0	M4	1000
GDM 4.7X15	Green	0.185	4.7	0.110	2.8	0.590	15.0	0.984	25.0	M5	1000
GDM 4.7X30	Green	0.185	4.7	0.110	2.8	1.181	30.0	1.575	40.0	M5	1000
GDM 5.2X15	Blue	0.205	5.2	0.110	2.8	0.590	15.0	0.984	25.0	M6	1000
GDM 5.2X30	Blue	0.205	5.2	0.110	2.8	1.181	30.0	1.575	40.0	M6	500
GDM 7.1X15	Yellow	0.273	7.1	0.130	3.3	0.590	15.0	0.984	25.0	M8	500

## Flanged Pull Plugs (continued)

Part Number	Color	Major Dia.		Minor Dia.		Body Length		Stem Length		Fits	Box Qty.
		IN.	mm	IN.	mm	IN.	mm	IN.	mm		
GDM 7.1X30	Yellow	0.273	7.1	0.130	3.3	1.181	30.0	1.575	40.0	M8	500
GDM 8.8X15	Rusty	0.346	8.8	0.097	5.0	0.590	15.0	0.984	25.0	M10	500
GDM 8.8X30	Rusty	0.346	8.8	0.097	5.0	1.181	30.0	1.575	40.0	M10	200
GDM 10.5X15	Red	0.413	10.5	0.097	5.0	0.590	15.0	0.984	25.0	M12	200
GDM 10.5X30	Red	0.413	10.5	0.097	5.0	1.181	30.0	1.575	40.0	M12	200

## Silicone Pull Plugs

The plug can be used to mask threaded and non-threaded holes. The silicone is flexible and will provide good sealing capabilities.

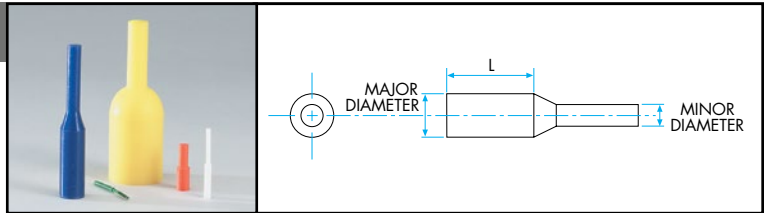

Recommended for use in Powder Coating, Liquid Coating, E-Coating, Anodizing and Plating. The plug will withstand 600° F (315° C). The high-grade silicone product is re-usable, will not migrate, melt or harden. Please contact us to request a sample or to inquire about custom or other non-listed sizes.

Part Number	Major Diameter		Minor Diameter		Length / L		Hole Thread	Box Qty.
	IN.	mm	IN.	mm	IN.	mm		
PPM-0062-0375	0.062	1.6	0.047	1.2	0.375	9.5	3/64	500
PPM-0067-0625	0.067	1.7	0.047	1.2	0.625	15.9	1/16	500
PPM-0073-0625	0.073	1.9	0.047	1.2	0.625	15.9	1/16	500
PPM-0091-0625	0.091	2.3	0.062	1.6	0.625	15.9	5/64	500
PPM-0093-0625	0.093	2.4	0.062	1.6	0.625	15.9	5/64	500
PPM-0105-1000	0.105	2.7	0.070	1.8	1.000	25.4	3/32	500
PPM-0109-0625	0.109	2.8	0.062	1.6	0.625	15.9	4-40 THRD	500
PPM-0118-1000	0.118	3.0	0.082	2.1	1.000	25.4	7/64	500
PPM-0125-1000	0.125	3.2	0.082	2.1	1.000	25.4	7/64	500
PPM-0130-0625	0.130	3.3	0.082	2.1	0.625	15.9	6-32 THRD	500
PPM-0140-0625	0.140	3.6	0.082	2.1	0.625	15.9	1/8	500
PPM-0154-0625	0.154	3.9	0.082	2.1	0.625	15.9	9/64	500
PPM-0156-0625	0.156	4.0	0.082	2.1	0.625	15.9	9/64	500
PPM-0158-1000	0.158	4.0	0.110	2.8	1.000	25.4	8-32 THRD	500
PPM-0162-0625	0.162	4.1	0.093	2.4	0.625	15.9	5/32	500
PPM-0195-0625	0.195	5.0	0.110	2.8	0.625	15.9	11/64	500
PPM-0197-1000	0.197	5.0	0.110	2.8	1.000	25.4	10-32 THD	500
PPM-0218-1000	0.218	5.5	0.110	2.8	1.000	25.4	1/4-20THD	500
PPM-0225-1000	0.225	5.7	0.125	3.2	1.000	25.4	7/32	500
PPM-0257-1000	0.257	6.5	0.130	3.3	1.000	25.4	1/4	500
PPM-0275-0950	0.275	7.0	0.130	3.3	0.950	24.1	5/16-18THD	500
PPM-0281-1000	0.281	7.1	0.138	3.5	1.000	25.4	5/16-18THD	500
PPM-0312-1000	0.312	7.9	0.147	3.7	1.000	25.4	19/64	500
PPM-0332-1125	0.332	8.4	0.250	6.4	1.125	28.6	5/16	500
PPM-0335-1000	0.335	8.5	0.157	4.0	1.000	25.4	3/8-16THD	500
PPM-0350-0900	0.350	8.9	0.157	4.0	0.900	22.9	11/32	500
PPM-0388-1000	0.388	9.9	0.157	4.0	1.000	25.4	3/8	250
PPM-0414-1000	0.414	10.5	0.157	4.0	1.000	25.4	13/32	250
PPM-0445-1000	0.445	11.3	0.157	4.0	1.000	25.4	1/2-13THD	250
PPM-0468-1000	0.468	11.9	0.250	6.4	1.000	25.4	29/32	250
PPM-0500-1000	0.500	12.7	0.250	6.4	1.000	25.4	15/32	100
PPM-0510-1000	0.510	13.0	0.250	6.4	1.000	25.4	1/2	100
PPM-0530-1000	0.530	13.5	0.250	6.4	1.000	25.4	33/64	100
PPM-0612-1000	0.612	15.5	0.250	6.4	1.000	25.4	19/32	100
PPM-0640-1000	0.640	16.3	0.375	9.5	1.000	25.4	5/8	100
PPM-0700-1000	0.700	17.8	0.375	9.5	1.000	25.4	11/16	100
PPM-0770-1125	0.770	19.6	0.375	9.5	1.125	28.6	3/4	50
PPM-0896-1000	0.896	22.8	0.375	9.5	1.000	25.4	7/8	50
PPM-1020-1000	1.020	25.9	0.375	9.5	1.000	25.4	1	50
PPM-1380-1000	1.380	35.1	0.500	12.7	1.000	25.4	1-3/8	50

## EPDM Pull Plugs

The plug can be used to mask threaded and non-threaded holes. Just insert the small tab end through the hole and pull into place, it's that simple! The EPDM rubber is flexible and will

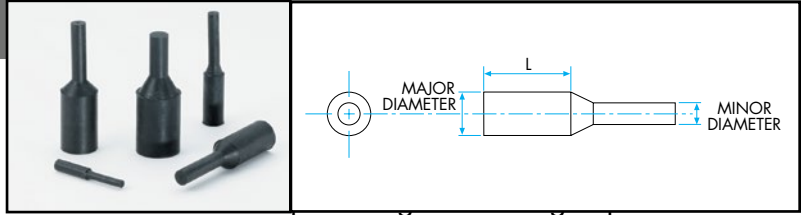

Recommended for use in Powder Coating, Liquid Coating, E-Coating, Anodizing and Plating. The plug will withstand 450°F (233°C). The high-grade EPDM rubber product is re-usable, will not migrate, melt or harden. Excellent chemical resistance. Stock color for plugs is black. Please contact us to request a sample or to inquire about custom or other non-listed sizes.

Part Number	Major Diameter		Minor Diameter		Length / L		Box Qty.	Hole Thread
	IN.	mm	IN.	mm	IN.	mm		
EPPM-0062-0375	0.062	1.6	0.047	1.2	0.375	9.5	500	3/64
EPPM-0067-0625	0.067	1.7	0.047	1.2	0.625	15.9	500	1/16
EPPM-0073-0625	0.073	1.9	0.047	1.2	0.625	15.9	500	1/16
EPPM-0091-0625	0.091	2.3	0.062	1.6	0.625	15.9	500	5/64
EPPM-0093-0625	0.093	2.4	0.062	1.6	0.625	15.9	500	5/64
EPPM-0105-1000	0.105	2.7	0.070	1.8	1.000	25.4	500	3/32
EPPM-0109-0625	0.109	2.8	0.062	1.6	0.625	15.9	500	4-40 THRD
EPPM-0118-1000	0.118	3.0	0.082	2.1	1.000	25.4	500	7/64
EPPM-0125-0625	0.125	3.2	0.082	2.1	0.625	15.9	500	7/64
EPPM-0130-0625	0.130	3.3	0.082	2.1	0.625	15.9	500	6-32 THRD
EPPM-0140-0625	0.140	3.6	0.082	2.1	0.625	15.9	500	1/8
EPPM-0154-0625	0.154	3.9	0.082	2.1	0.625	15.9	500	9/64
EPPM-0156-0625	0.156	4.0	0.082	2.1	0.625	15.9	500	9/64
EPPM-0158-1000	0.158	4.0	0.110	2.8	1.000	25.4	500	8-32 THRD
EPPM-0162-0625	0.162	4.1	0.093	2.4	0.625	15.9	500	5/32
EPPM-0195-0625	0.195	5.0	0.110	2.8	0.625	15.9	500	11/64
EPPM-0197-1000	0.197	5.0	0.110	2.8	1.000	25.4	500	10-32 THD
EPPM-0218-1000	0.218	5.5	0.110	2.8	1.000	25.4	500	1/4-20THD
EPPM-0225-1000	0.225	5.7	0.125	3.2	1.000	25.4	500	7/32
EPPM-0257-1000	0.257	6.5	0.130	3.3	1.000	25.4	500	1/4
EPPM-0275-0950	0.275	7.0	0.130	3.3	0.950	24.1	500	5/16-18THD
EPPM-0281-1000	0.281	7.1	0.138	3.5	1.000	25.4	500	5/16-18THD
EPPM-0312-1000	0.312	7.9	0.147	3.7	1.000	25.4	500	19/64
EPPM-0332-1125	0.332	8.4	0.250	6.4	1.125	28.6	500	5/16
EPPM-0335-1000	0.335	8.5	0.157	4.0	1.000	25.4	500	3/8-16THD
EPPM-0350-0900	0.350	8.9	0.157	4.0	0.900	22.9	500	11/32
EPPM-0388-1000	0.388	9.9	0.157	4.0	1.000	25.4	250	3/8
EPPM-0414-1000	0.414	10.5	0.157	4.0	1.000	25.4	250	13/32
EPPM-0445-1000	0.445	11.3	0.157	4.0	1.000	25.4	250	1/2-13THD
EPPM-0468-1000	0.468	11.9	0.250	6.4	1.000	25.4	250	29/32
EPPM-0500-1000	0.500	12.7	0.250	6.4	1.000	25.4	100	15/32
EPPM-0510-1000	0.510	13.0	0.250	6.4	1.000	25.4	100	1/2
EPPM-0530-1000	0.530	13.5	0.250	6.4	1.000	25.4	100	33/64
EPPM-0612-1000	0.612	15.5	0.250	6.4	1.000	25.4	100	19/32
EPPM-0640-1000	0.640	16.3	0.375	9.5	1.000	25.4	100	5/8
EPPM-0770-1125	0.770	19.6	0.375	9.5	1.125	28.6	50	3/4
EPPM-0896-1000	0.896	22.8	0.375	9.5	1.000	25.4	50	7/8
EPPM-1020-1000	1.020	25.9	0.375	9.5	1.000	25.4	50	1

## Flangeless Plugs

Designed for masking threaded holes without masking the surrounding area. These clever plugs have excellent sealing capabilities and their hollow core design allows flexibility in masking several different hole diameters and thread pitches.

Recommended for use in Powder Coating, Liquid Coating, E-Coating, Anodizing and Plating. The plug will withstand 600° F (315° C). The high-grade silicone product is re-usable, will not migrate, melt or harden. Please contact us to request a sample or to inquire about custom or other non-listed sizes.



Part Number	Major Diameter		Minor Diameter		Length		Box Qty.
	IN.	mm	IN.	mm	IN.	mm	
FPM-0236-100	0.236	6	0.157	4	1.000	25.4	250
FPM-0315-100	0.315	8	0.236	6	1.000	25.4	250
FPM-0394-100	0.394	10	0.315	8	1.000	25.4	250
FPM-0472-100	0.472	12	0.394	10	1.000	25.4	250
FPM-0551-100	0.551	14	0.472	12	1.000	25.4	250
FPM-0630-100	0.630	16	0.551	14	1.000	25.4	250
FPM-0709-100	0.709	18	0.630	16	1.000	25.4	250
FPM-0787-100	0.787	20	0.709	18	1.000	25.4	100
FPM-0886-100	0.886	23	0.787	20	1.000	25.4	100
FPM-0945-100	0.945	24	0.886	22	1.000	25.4	100
FPM-1024-100	1.024	26	0.945	24	1.000	25.4	100
FPM-1102-100	1.102	28	1.024	26	1.000	25.4	100

## Vented Flangeless Plugs

Designed for masking lead threads without masking the surrounding area, their tapered shape is flexible for masking multiple diameters. A vent at the top of the plug eliminates pressure build-up between the plug and the part.

Recommended for use in Powder Coating, Liquid Coating, E-Coating, Anodizing and Plating. The plug will withstand 600° F (315° C). The high-grade silicone product is re-usable, will not migrate, melt or harden. Please contact us to request a sample or to inquire about custom or other non-listed sizes.



Part Number	Color	Major Dia.		Minor Dia.		Fit Dia. mm	Length		Box Qty.
		IN.	mm	IN.	mm		IN.	mm	
VFPM-1	Yellow	0.280	7.1	0.145	3.7	M6/M8	0.80	20.3	500
VFPM-2	Rusty	0.412	10.5	0.305	7.7	M10/M12	0.80	20.3	500
VFPM-3	Red	0.585	14.9	0.480	12.2	M14/M16	0.80	20.3	250
VFPM-4	Blue	0.718	18.2	0.600	15.2	M18/M20	0.80	20.3	100

## Q-Bolts

The Q-Bolt is a masking product for threaded holes. Consisting of a steel screw partly covered with silicone rubber, the Q-Bolt gives a very tight masking and a smooth paint edge. It is suited for automatic mounting and dismounting. There is also a threaded hole (M4) in the back which makes it possible to hang with either a normal hook (up to diameter 3.0), or by threaded eyebolts.

Q-Bolts are stocked in metric sizes, but can be custom made to any thread size, call us to discuss your requirement.



Part Number	Color	Fit Dia. mm	Box Qty.	Part Number	Color	Fit Dia. mm	Box Qty.
QB 03	PINK	M3	200	QB 12	RED	M12	200
QB 04	WHITE	M4	200	QB 14	BLUE	M14	100
QB 05	GREEN	M5	200	QB 16	BLUE	M16	100
QB 06	BLUE	M6	200	QB 20	GREEN	M20	50
QB 08	YELLOW	M8	200	QB 22	YELLOW	M22	50
QB 10	RUSTY	M10	200	QB 24	BLUE	M24	50

## Special Molded Masking

We produce special masking products for all types of applications. If you have a special masking requirement, then please send a sample of your product or a drawing so that we can find a product suitable for your application.



## Extruded Silicone Tubing

For masking threads, pins and tubing where a longer masking length is required. Flexible but sturdy enough for use in masking threaded, non-threaded or slotted holes. Stocked in 1/16" wall thicknesses. Tubing is easily cut to desired length.



Recommended for use in Powder Coating, Liquid Coating, E-Coating, Anodizing and Plating. The tubing will withstand 600°F (315°C). The high-grade silicone product is re-usable, will not migrate, melt or harden. Clear color. Please contact us to request a sample or to inquire about custom or other non-listed sizes.

Part Number	ID (IN.)	Wall Thickness (IN.)	Roll Qty. (Ft.)
MST-0040	0.040	0.063	100
MST-0056	0.056	0.063	100
MST-0062	0.062	0.063	100
MST-0080	0.080	0.063	100
MST-0093	0.093	0.063	100
MST-0109	0.109	0.063	100
MST-0125	0.125	0.063	100
MST-0140	0.140	0.063	100
MST-0156	0.156	0.063	100
MST-0172	0.172	0.063	100
MST-0187	0.187	0.063	100
MST-0203	0.203	0.063	100
MST-0218	0.218	0.063	100
MST-0234	0.234	0.063	100
MST-0250	0.250	0.063	100
MST-0281	0.281	0.063	50
MST-0312	0.312	0.063	50
MST-0343	0.343	0.063	50
MST-0375	0.375	0.063	50
MST-0406	0.406	0.063	50
MST-0437	0.437	0.063	50
MST-0500	0.5	0.063	50
MST-0625	0.625	0.063	50
MST-0750	0.75	0.063	50
MST-0875	0.875	0.063	50
MST-0937	0.937	0.063	50
MST-1000	1	0.063	50
MST-1125	1.125	0.063	25
MST-1250	1.25	0.063	25

## Tape Products

Mighty Hook offers an extensive line of stock masking tapes for your coating requirements. If you need help with selecting styles or sizes please contact our experienced staff to discuss your requirements. If we cannot find a stock product to meet your needs, we also offer custom molded and die cut masking manufacturing to solve the most complex masking problems. Please call us to discuss your application.

All tape products can be ordered by the roll or in case quantities. See web site for pricing information.



### 2 mil Green Polyester Tape

Recommended for use in Powder Coating, Liquid Coating, E-Coating, Anodizing and Plating. Tape will withstand 400°F (205°C). Total tape thickness including adhesive is 3.5mm. The high-grade polyester tape will not leave residue after removal, will release in one piece and will not shrink. Please inquire about custom widths with quick turnaround.



Part Number	Roll Width (IN.)	Roll Length (Yards)	Case Qty.
GTM-0250	1/4	72	144
GTM-0375	3/8	72	100
GTM-0500	1/2	72	76
GTM-0750	3/4	72	48
GTM-1000	1	72	36
GTM-1500	1-1/2	72	34
GTM-2000	2	72	16
GTM-3000	3	72	12
GTM-4000	4	72	8

### 1 mil Blue Polyester Tape

Recommended for use in Powder Coating, Liquid Coating, E-Coating, Anodizing and Plating. This tape will withstand 400°F (205°C). Total tape thickness including adhesive is 2.5mm. The high-grade polyester tape will not leave residue after removal, will release in one piece and will not shrink. Please inquire about custom widths with quick turnaround.



Part Number	Roll Width (IN.)	Roll Length (Yards)	Case Qty.
BTM-0250	1/4	72	144
BTM-0375	3/8	72	100
BTM-0500	1/2	72	76
BTM-0750	3/4	72	48
BTM-1000	1	72	36
BTM-1500	1-1/2	72	34
BTM-2000	2	72	16
BTM-3000	3	72	12
BTM-4000	4	72	8

## Polyimide (Kapton®) Tape

Recommended for use in Powder Coating and other high temperature coating applications. Tape will withstand 500°F (260°C). Total tape thickness including adhesive is 2.5mm. Tape will not leave residue after removal and will not shrink. Please inquire about custom widths with quick turnaround.



Part Number	Roll Width (IN.)	Roll Length (Yards)	Case Qty.
KTM-0250	1/4	36	96
KTM-0375	3/8	36	80
KTM-0500	1/2	36	60
KTM-0750	3/4	36	40
KTM-1000	1	36	28
KTM-1500	1-1/2	36	20
KTM-2000	2	36	12
KTM-3000	3	36	8
KTM-4000	4	36	4

## Fiberglass (Glass Cloth) Tape

Recommended for use in Powder Coating and other high temperature coating applications. Tape will withstand 500°F (260°C). Total tape thickness including adhesive is 7mm. Highly abrasive resistant. Flame retardant. Manufactured with thin backing for easy placement and removal. Please inquire about custom widths with quick turnaround.



Part Number	Roll Width (IN.)	Roll Length (Yards)	Case Qty.
FTM-0125	0.125	36	144
FTM-0250	0.250	36	144
FTM-0375	0.375	36	100
FTM-0500	0.500	36	76
FTM-0625	0.625	36	60
FTM-0750	0.750	36	48
FTM-1000	1.000	36	36
FTM-1250	1.250	36	28
FTM-1500	1.500	36	24
FTM-1750	1.750	36	20
FTM-2000	2.000	36	16
FTM-2500	2.500	36	12
FTM-3000	3.000	36	12
FTM-4000	4.000	36	8

## Silicone Self-fusing Tape

Tape is without adhesive and bonds to itself. An excellent choice for masking long parts. Great for masking and insulating racks during plating and E-coating. Recommended for use in Powder Coating, Liquid Coating, E-Coating, Anodizing and Plating. Tape will withstand 600°F (350°C). Tape will permanently fuse to itself in 24 hours.



Part Number	Width (IN.)	Width (mm)	Roll Length (Yards)	Box Qty.
RTM-100	1.00	25.4	12	8
RTM-150	1.50	38.1	12	8
RTM-200	2.00	50.8	12	8

## Discs

Mighty Hook offers an extensive line of stock masking discs for your coating requirements. If you need help with selecting styles or sizes please contact our experienced staff to discuss your requirements. If we cannot find a stock product to meet your needs, we also offer custom molded and die cut masking manufacturing to solve even the most complex masking problems. Please call us to discuss your application.

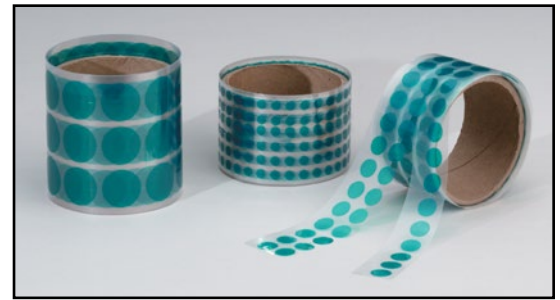

### 2 mil Green Polyester Discs

Recommended for use in Powder Coating, Liquid Coating, E-Coating, Anodizing and Plating. Discs will withstand 400°F (205°C). Total tape thickness including adhesive is 3.5mm. The high-grade polyester discs will not leave residue after removal, will release in one piece and will not shrink. These discs have a split liner to aid in removing them from the roll. We can manufacture custom sizes and provide the discs on non-split liners as well. Contact us to discuss your requirements.

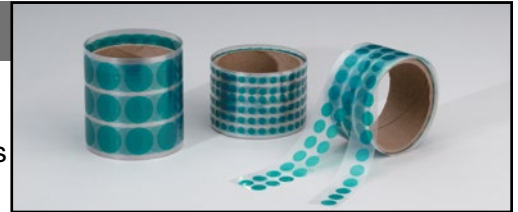

Part Number	Disc Dia.	Disc Dia. (Fractions)	Discs per Roll
GDM-0188	0.188	3/16"	2000
GDM-0250	0.250	1/4"	2000
GDM-0313	0.313	5/16"	2000
GDM-0375	0.375	3/8"	2000
GDM-0438	0.438	7/16"	2000
GDM-0500	0.500	1/2"	2000
GDM-0563	0.563	9/16"	2000
GDM-0625	0.625	5/8"	2000
GDM-0750	0.750	3/4"	1000
GDM-0875	0.875	7/8"	1000
GDM-1000	1.000	1"	500
GDM-1125	1.125	1-1/8"	500
GDM-1188	1.188	1-3/16"	500
GDM-1250	1.250	1-1/4"	500
GDM-1375	1.375	1-3/8"	500
GDM-1500	1.500	1-1/2"	500
GDM-1625	1.625	1-5/8"	500
GDM-1750	1.750	1-3/4"	500
GDM-1875	1.875	1-7/8"	250
GDM-2000	2.000	2"	100
GDM-3000	3.000	3"	100
GDM-4000	4.000	4"	100

## Polyimide (Kapton®) Discs

Recommended for use in Powder Coating and other high temperature coating applications. Discs will withstand 500°F (260°C). Total tape thickness including adhesive is 2.5mm. Discs will not leave residue after removal and will not shrink.



Please inquire about custom sizes with quick turnaround.

Part Number	Disc Dia.	Disc Dia. (Fractions)	Discs per Roll
KDM-0188	0.188	3/16"	2000
KDM-0250	0.250	1/4"	2000
KDM-0313	0.313	5/16"	2000
KDM-0375	0.375	3/8"	2000
KDM-0438	0.438	7/16"	2000
KDM-0500	0.500	1/2"	2000
KDM-0563	0.563	9/16"	2000
KDM-0625	0.625	5/8"	2000
KDM-0750	0.750	3/4"	1000
KDM-0875	0.875	7/8"	1000
KDM-1000	1.000	1"	500
KDM-1125	1.125	1-1/8"	500
KDM-1188	1.188	1-3/16"	500
KDM-1250	1.250	1-1/4"	500
KDM-1375	1.375	1-3/8"	500
KDM-1500	1.500	1-1/2"	500
KDM-1625	1.625	1-5/8"	250
KDM-1750	1.750	1-3/4"	250
KDM-1875	1.875	1-7/8"	250
KDM-2000	2.000	2"	100
KDM-3000	3.000	3"	100
KDM-4000	4.000	4"	100

## Wishbone Discs

Patented round disc design incorporates a tab concept for easier placement and faster removal after powder coating. Ideal for masking recessed holes and eliminates quality problems of removing disk below the coated surface.

Recommended for use in Powder Coating, Liquid Coating, E-Coating, Anodizing and Plating. Discs will withstand 400°F (205°C). The high-grade polyester discs will not leave residue after removal, will release in one piece and will not shrink.



Part Number	Disc Dia. (Fractions)	Discs per Roll	Part Number	Disc Dia. (Fractions)	Discs per Roll
GWDM-0500	1/2"	500	GWDM-1875	1-7/8"	250
GWDM-0563	9/16"	500	GWDM-2000	2"	250
GWDM-0625	5/8"	500	GWDM-2250	2-1/4"	100
GWDM-0750	3/4"	500	GWDM-2500	2-1/2"	100
GWDM-0875	7/8"	500	GWDM-2750	2-3/4"	100
GWDM-1000	1"	500	GWDM-3000	3"	100
GWDM-1125	1-1/8"	500	GWDM-3500	3-1/2"	100
GWDM-1250	1-1/4"	500	GWDM-4000	4"	100
GWDM-1375	1-3/8"	500	GWDM-4500	4-1/2"	100
GWDM-1500	1-1/2"	500	GWDM-5000	5"	100
GWDM-1625	1-5/8"	250	GWDM-5500	5-1/2"	100
GWDM-1750	1-3/4"	250			

## Roland Servo Plotter/Cutter

Create low to medium volume die cut masking inexpensively and in-house!

We now offer the custom die cutting system for OEM and job shop masking requirements right from your own computer. Utilized in the sign making and auto detailing industries for years, we have adapted the technology to create custom die cuts for flat surface, high temperature masking applications to be created in-house saving you valuable time and money.

No longer do you have to wait days for custom die cutting samples from an outside vendor or spend valuable labor hours trimming masking tape to fit your application. You can create conforming high temperature masking shapes in minutes!

Viewed as one of the top machines for reliability, flexibility and quality, our affordable Roland® CAMM-1 GS-24 plotter/cutter sits on your desk or table, or on its optional stand. The USB output is attached directly to your computer. The GS-24 is compatible with most CAD programs and drawing software. Merely install the Roland printer driver and set the printer output from your CAD or drawing program to plot to the GS-24. Feed our high temperature, release-backed liner, green polyester (rated for 400°F) or polyimide polyester (rated for 500°F) film into the GS-24, set the cut parameters and plot out your die cut profiles and print. Peel the die cuts from the film and place on your parts. For repeat jobs, save the file and print new die cuts at will. It really is that easy!

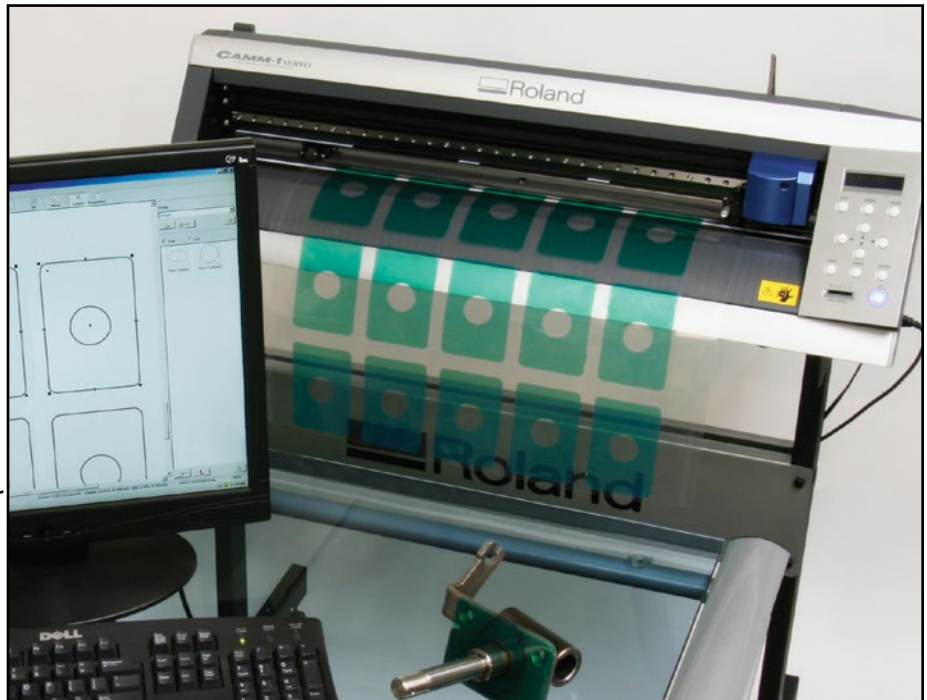

Part Number	Description
GS0-24	GS-24 Roland 24" Servo Plotter/Cutter with Floor Stand
USA-45	45° Roland OEM Replacement Blade
GPL-8	8" wide x 36 Yards, Green Polyester (400°F) Film with Release Liner
GPL-14	14" wide x 36 Yards, Green Polyester (400°F) Film with Release Liner
GPL-22	22" wide x 36 Yards, Green Polyester (400°F) Film with Release Liner

### More GS-24 Features

- Fine tune your operation by adjusting blade-force with slide control, even while cutting.
- Store up to eight settings of regularly used blade and media combinations for quick recall.
- Two sets of guide lines (front and back) ensure precise media alignment.
- Front panel knife guide allows easy sheet trimming and removal of media.
- Test-cut function allows you to verify the machine's down force before you begin your job.
- Easy-to-attach sheet roller base helps ensure proper media feeding.
- Convenient tray on the back of the GS-24 stores blades and blade holders.

Mighty Hook is an authorized distributor for the Roland Servo/Plotter.

For PRICING and LEAD TIMES, Please call a Mighty Hook sales Representative at (773) 378-1909.

For any TECHNICAL QUESTIONS on this specific product, please call Roland Corporation at (800) 542-2307.

Complete GS-24 specifications and information are available at [www.mightyhook.com](http://www.mightyhook.com)

## Tape Dispenser

The TM-1000 is the industry standard for automatic tape feed and cutting. The digital controls allow for precise length adjustments and are accurate to 0.04". The photo-electronic controls automatically feed an identical length of tape as soon as the previous length is removed. The tape machine handles tape widths from 0.250" to 2" and lengths from 0.79" to 39". An adjustable-pressure feed reduces tape curling.

We also offer a wide variety of dispensers for tape, labels and die cuts. Call our expert staff to discuss your particular application.



Part Number	Description
TM-1000	Automatic Tape Dispenser for up to 2" Wide Tape

## Heavy Duty Tape Dispenser

The TM-080 heavy duty tape dispenser will automatically dispense virtually any type of tape, including duct tape. It is designed for continuous industrial use applications.

Dispenses tape widths from .25" (6mm) to 3.15" (80mm) and cuts lengths from 1.6" (40mm) to 394" (9999mm). The TM-080 can also dispense non-adhesive materials. Specifications and pricing available on our website.



Part Number	Description
TM-080	Automatic Heavy Duty Tape Dispenser for up to 3.15" Wide Tape

## PosiTest DFT Combo Coating Thickness Gauge

PosiTest DFT Combo is a hand-held, digital thickness gauge that measures both non-magnetic coatings on steel and non-conductive coatings on aluminum and brass, etc. The advanced electronics automatically recognize the substrate and take a measurement. The gauge is only 4" x 1.5" x 0.9" (100mm x 38mm x 23mm) and weighs 2.5 oz (70 g). Gauge comes complete with built-probe, plastic shims, hard shell storage case, AAA battery, instructions and two (2) year warranty.

### Features:

- Fast, repeatable measurements
- No calibration required for most applications
- ZERO feature for rough or curved surfaces
- Handy RESET feature when no zero reference is available
- Strong, wear-resistant, ruby-tipped probe
- Audible and visible measurement indication
- V-groove in probe for positioning on cylindrical parts
- Mils/Microns switchable



**Measurement Range:** 0-40 mils    0-1000  $\mu$ m    **Accuracy:** +(0.1 mils + 3%)    +(2  $\mu$ m + 3%)

Part Number	Description
PT-DFT-C	Coating Thickness Gauge Ferrous/Non-ferrous

### Grounding Tester

This easy-to-use Grounding Tester is battery operated, and will determine if your hooks and racks are sufficiently grounded. Attach the terminal clip to a grounding point, then simply point the tester at the product to be coated and press the button. There are 5 possible results, ranging from 2 green lights as the best, to 2 red lights as the worst. This takes out all of the guess work and your coating line will run more efficiently.



Part Number	Description
CGTII	Conveyor Grounding Tester

### Identification Plates

If a product or rack needs to be identified through the coating process it can be marked with an identification plate. The laser cut design allows for a heavy build up of coating without obscuring the easy to recognize numbers. The stock plate is 1"x 2" with a hanging hole with numbers 00-99. We can provide other sizes, shapes, or symbols to meet your specific needs. Bar code identification for hangers and other products is also available.



Part Number	Description	Numbered 00-99
MP-00-99	1" x 2" Laser Stenciled Steel Identification Plates	

## Protective Packaging

We offer a variety of protective packaging accessories to improve your quality and minimize damage during material handling. If you have any questions on our products, please contact our expert staff for assistance.

### Cork Spacers

A simple system for avoiding paint damage during storage and transportation. The spacer pads are made from natural cork. Standard pads have a 0.079" thick foamed plastic layer on one side. The pad fastens with a suction effect when lightly pressed against the painted surface. The pads do not normally leave any trace after removal from the product and they can be reused. Alternatively, we can supply cork separators without the plastic layer in almost any format, size, and quantity.



Part Number	Description	Box Qty.
CSP-70-157	0.70" Sq. x 0.157" T Foam-backed Cork Spacer	6000
CSP-80-394	0.80" Sq. x 0.394" T Foam-backed Cork Spacer	4500
CSP-80-550	0.80" Sq. x 0.55" T Foam-backed Cork Spacer	3000

### Cohesive Paper

This innovative packaging paper has a special formulated adhesive on one side that sticks to the paper but does not stick to the part. Paper conforms to the irregular shape of the part providing good protective packaging without the mess of using tape to secure it.



Part Number	Description	Case Quantity
COH6700	Cohesive Paper 6" x 700'	5 Rolls
COH75700	Cohesive Paper 7.5" x 700'	4 Rolls
COH10700	Cohesive Paper 10" x 700'	3 Rolls
COH15700	Cohesive Paper 15" x 700'	2 Rolls

## Sample Kit

To help you arrive at the best design for your product mix, we have put together a sample kit with components from some of our most popular systems. We are very flexible as to the kit contents and you are free to substitute or add additional items. Our goal is for you to have a system suited to your needs.

### The Mighty Assortment Kit

**SAMPLE KIT- Includes:**

The POWDERPEG PACKAGE:  
 1 3-Piece Powder Peg Frame PPG25W-30L-2  
 1 PPG-TOP - 5"L Perpendicular,  
 PPG-TOP - 6"L Perpendicular C-Top  
 Hardware for the Rack and top assembly.

**plus the following:**

**CROSSBARS**

- 1 Z-BARHV-PP25
- 1 Z-BAR-PP25LT
- 1 PPX-BAR 25-8HV
- 1 PPX-BAR 25-12
- 1 TSR-BAR-PP-25
- 1 X-BAR-D-25-12

**Z-Hooks**

40+ hooks in a variety of sizes and lengths for both light and heavy Z-BAR.

**Standard Hooks**

50+ hooks in a variety of shapes, sizes and lengths made of both round and square.

**Jam Hooks**

An assortment of jam hooks.

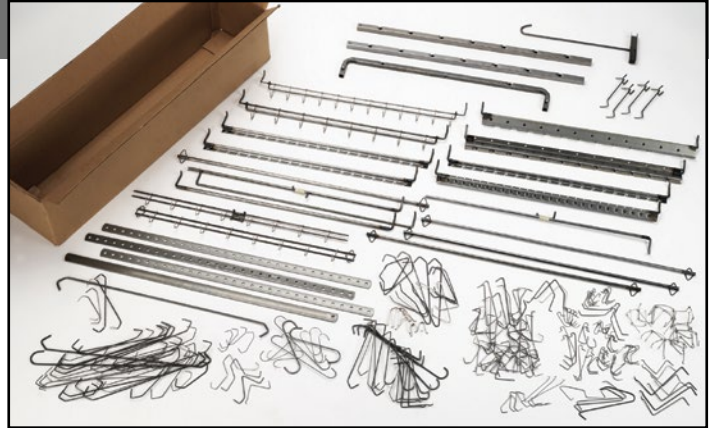

Part Number	Description
Sample Kit	Mighty Assortment

## Masking Sample Kits

We offer a variety of masking sample kits for prototyping and ever changing production requirements. We can also customize a sample kit for your particular needs. Contact our experienced staff to discuss your requirements.



### SCM-1

18 sizes of silicone caps. Sizes range from 0.040" ID to 0.295" ID.

### SCM-2

18 sizes of silicone caps. Sizes range from 0.281" ID to 1.25" ID.

### EPDMC

18 sizes of EPDM Rubber caps. Sizes range from 0.040" ID to 0.295" ID..

### PPM

18 sizes of Silicone Plugs. Sizes range from 0.062" Dia. to 0.896" Dia.

### EPDMPP

18 sizes of EPDM Rubber Plugs. Sizes range from 0.062" Dia. to 0.896" Dia.

### TPM

18 sizes of Silicone Tapered Plugs. Sizes range from 0.062" Dia. to 1.024" Dia.

### EPDMTP

18 sizes of EPDM Rubber Tapered Plugs. Sizes range from 0.062" Dia. to 1.024" Dia.

### FPM

12 sizes of Flangeless Plugs. Sizes range from 0.236" Dia. to 1.102" Dia.

Part Number	Description
SCM-1	Silicone Cap Sample Kit
SCM-2	Silicone Cap Sample Kit
EPDMC	EPDM Rubber Cap Sample Kit
PPM	Silicone Pull Plug Sample Kit
EPDMPP	EPDM Rubber Pull Plug Sample Kit
TPM	Silicone Tapered Plug Sample Kit
EPDMTP	EPDM Tapered Plug Sample Kit
FPM	Silicone Flangeless Plug Sample Kit

**Want to be certain that the parts you want are always available when you need them?  
Place a blanket order with us and we will produce and ship those parts to your schedule. Contact us for details.**

# MIGHTY HOOK

**Your Complete Source** for **Engineered Hanging & Masking** Solutions

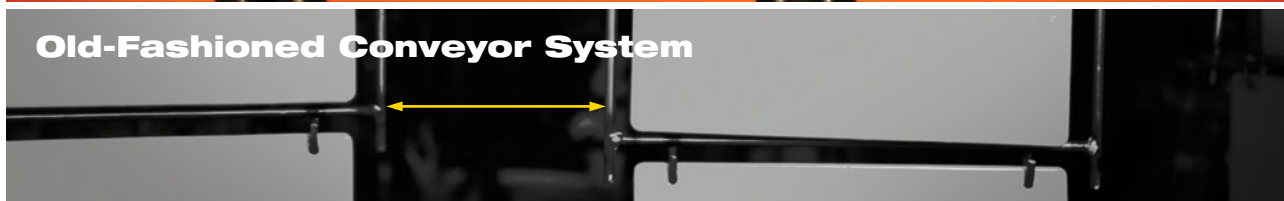

**Mighty Hook specializes in the tooling and hanging systems for everything below the conveyor. We maximize part throughput and increase the quality, safety, and ergonomic design of any process. We offer the above customizable solutions, all engineered to streamline the assembly and fabrication process with lean manufacturing techniques.**

*(Due to set up costs for our machines, some hooks require a minimum order of multiple boxes.)*